

# EXTRUSION PROTECTION LED STRIP USER MANUAL

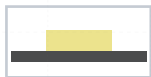

Protection level: IP67/IP68

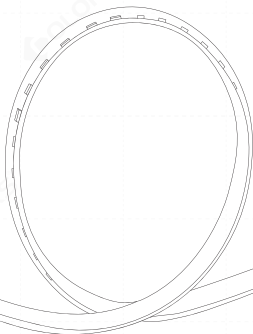

Please read the manual carefully before the installation and usage, and use the product in the correct way.

Instructions of accessories are included in the manual.

Please properly maintain the manual after reading and understanding it for convenient reference by all users of the product in the future.

# Processing instructions

- 1 Cut the light strip to an appropriate length from the outside of the light strip cutting position.

⚠ Cutting LED strip at the minimum cutting unit.

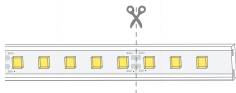

- 2 Peel off the red 3M glue from the cutting position of the lightstrip.

⚠ The length of the stripped glue is 9-13mm. If the cut is too short, the plug cannot be inserted.



## Use of welding wire

- 3 Use a blade to peel off the glue on the surface of the pad and use the exposed pad to facilitate wire connection.



- 4 Perform wire welding.

⚠ Pay attention to the positive and negative poles.

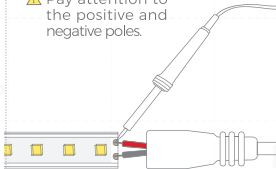

- 5 Inject the gule into the end cap, the end cap inside should be full of gule.

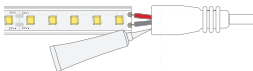

- 6 Insert the welded light strip into the end cap till the bottom of it.



# Processing instructions

## Use of solder free connector

- 3 Insert the light strip into the lower cover assembly

⚠ Note that the light strip should be inserted into the place where the lower cover assembly can not be pushed anymore.. The positive pole of the light strip is connected to the red wire on the coppercontact piece, and the negative pole of the lightstrip is connected to the black wire on the copper contact piece.

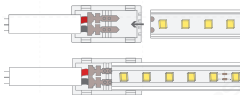

- 4 Press the upper cover to fix the light strip.

⚠ Light up the strip and test it to prevent rework.

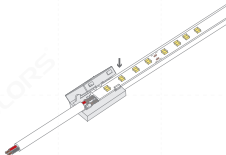

- 6 Scrape off the remaining glue and complete the splicing

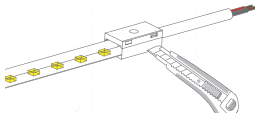

- 5 Cut the glue with scissors to a glue outlet of about 4mm, squeeze the glue into the glue injection hole of the upper cover, till the glue overflows from all sides of cover.

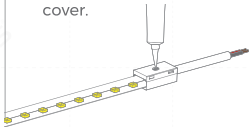

- 7 Inject the glue into the end cap, the end cap inside should be full of glue.



- 8 Insert the light strip till the bottom of the end cap. Keep the end cap still after 12 Hours.



- 9 Uncover the 3M glue release paper on the back of the light strip in proper order and stick it to the installation position

The mounting surface should be cleaned in advance.

It is strictly forbidden to tear off the 3M glue release paper on the back of the light strip at one time.

It is strictly forbidden to press lights or work when power is on.

- 10 Use the clip to install the light strip in a fixed position

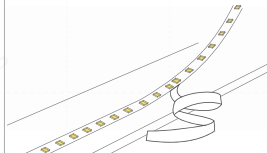
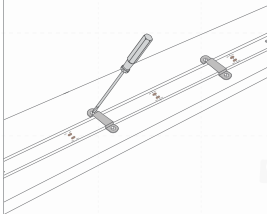

# Turn on the power

- 1** Install the power supply in a suitable location.

 Do not touch with wet hands to prevent electric shock.

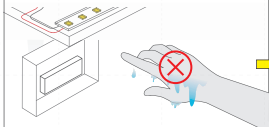

- 2** Connect the red and black wires of the light strip to the power supply.

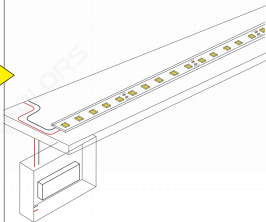

- 3** Turn on the power and light up the light strip.

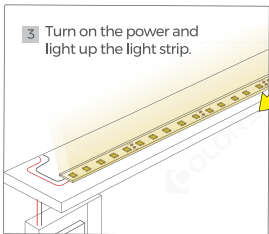

Connect to DIM.

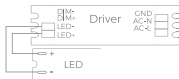

# Notice

## Installation Precautions



Install in the space without chemicals like sulfur, acid, halogen.



The ambient temperature of the product is  $-20 \sim 40^{\circ}\text{C}$ .



The quality of atmosphere should not be lower than the national secondary standard.



During the installation process, pay attention to the positive and negative poles of the power cord, and do not connect them wrongly. The power output must be consistent with the product voltage.



Extrusion waterproof (IP67/68) products can be used indoors and outdoors, suitable for short-term immersion environment, and can withstand the water pressure of 1m underwater for a short time, but the product needs to be protected from external extrusion and direct ultraviolet radiation.



To ensure the luminous effect, every five meters long strip should be connected to a driver.



Please pay attention to the operation, when the power is working, do not touch the AC power terminal to prevent electric shock.

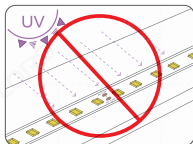
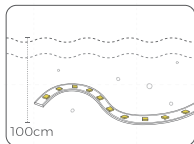



It is recommended to use only 80% electricity of the driver to protect the strip from damage caused by overload.



To avoid the damaged components caused by surge voltage or unstable current, please use the stable driver to power up the strip.



Light strip products will release a lot of heat during use, and the product must be used in a ventilated environment.



In order to ensure the life and reliability of the light strip, please do not bend it in an arc less than 60mm in diameter, and do not fold it in half to avoid damage to the lamp beads or break.

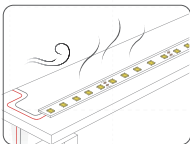

It is forbidden to wind objects with a diameter less than 60mm.

<60MM

≥60MM



To ensure the long life span of strip, please do not pull the strip or driver wire hard during installation and using.

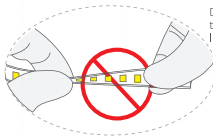

Do not twist the light strip.

For non-replaceable light sources:

"The light source of this luminaire is not replaceable; when the light source reaches its end of life the whole luminaire shall be replaced";

# Product Warranty

- A warranty period of three years is provided for products in normal use. For any faults arising during the period that are approved to be quality issue after inspected by our company, a product of the same model will be replaced for free.
- The warranty does not cover any of the following situations:
  - (1)Any product damage due to usage not allowed in the instructions.
  - (2)Any product damage due to disassembling or wrong operations by the user.
  - (3)Severe appearance damage or deformation of the product.

## FAQ

### Q:Why are all leds not lit or no color changing?

A:Please check the following item:

- (1)If the power is on.
- (2)If the polarity is connected reversely.
- (3)If there is a short circuit in exterior power supply.
- (4)If there is a short circuit caused by automatic short-circuit protection for driver.
- (5)If the fuse is burned; if there is, please replace the fuse.

Please take the appropriate measures to solve the problem if there is any problem listed above.

### Q:Why are some strip not lit?

A:Please check the following item:

- (1)If every power supply is on.
- (2)If there is an error in circuit.

If there is, please check the driver circuit to eliminate the faults.

### Q:Why is there inconsistent brightness in LED or the LED is not bright enough?

A:Please check the following item:

- (1)If there is overload in power supply; if yes, please add more drivers.
- (2)If there is too much loss in switching power supply circuit, if there is, please thicken the driver wire or make the driver closer to the strip. Make sure the voltage of per five meter strip is kept above 95% of the rated voltage.
- (3)If there are too many strips connected in series, if yes, please adjust the numbers of strip to the numbers that can be driven by the power supply.



**Q:Why does the LED flashes?**

A:Please check if the connection is in poor contact, if yes, please find out the bad unit.

**Q:Why are there individual leds not lit?**

A:Please check if it is caused by static breakdown, or by the faradic electricity breakdown of equipment, or by electricity leakage, if yes, please make sure the related electrical appliances are connected to the earth wire correctly and replace the LEDS.

This user manual is subject to change without notice. COLORS does not assume any legal responsibility for the damage caused by this user manual. Without the authorization of COLORS, do not copy all or part of this user manual.



Official website



You tube



Tel: +86-755-2923 1888

E-mail: colors@colorsled.com

Web: www.colorsled.com

Add: Building A5, Qixing Wisdom Park, Shiyan