

SmartVision40 Installation and Deployment Guide

Package Contents

TIP

- We recommend that you use the accessories provided or approved by Yealink. The use of unapproved third-party accessories may result in poor performance.
- Use the Yealink original power adapter to charge the endpoint only. The use of the third-party power adapter may cause damage to the endpoint.

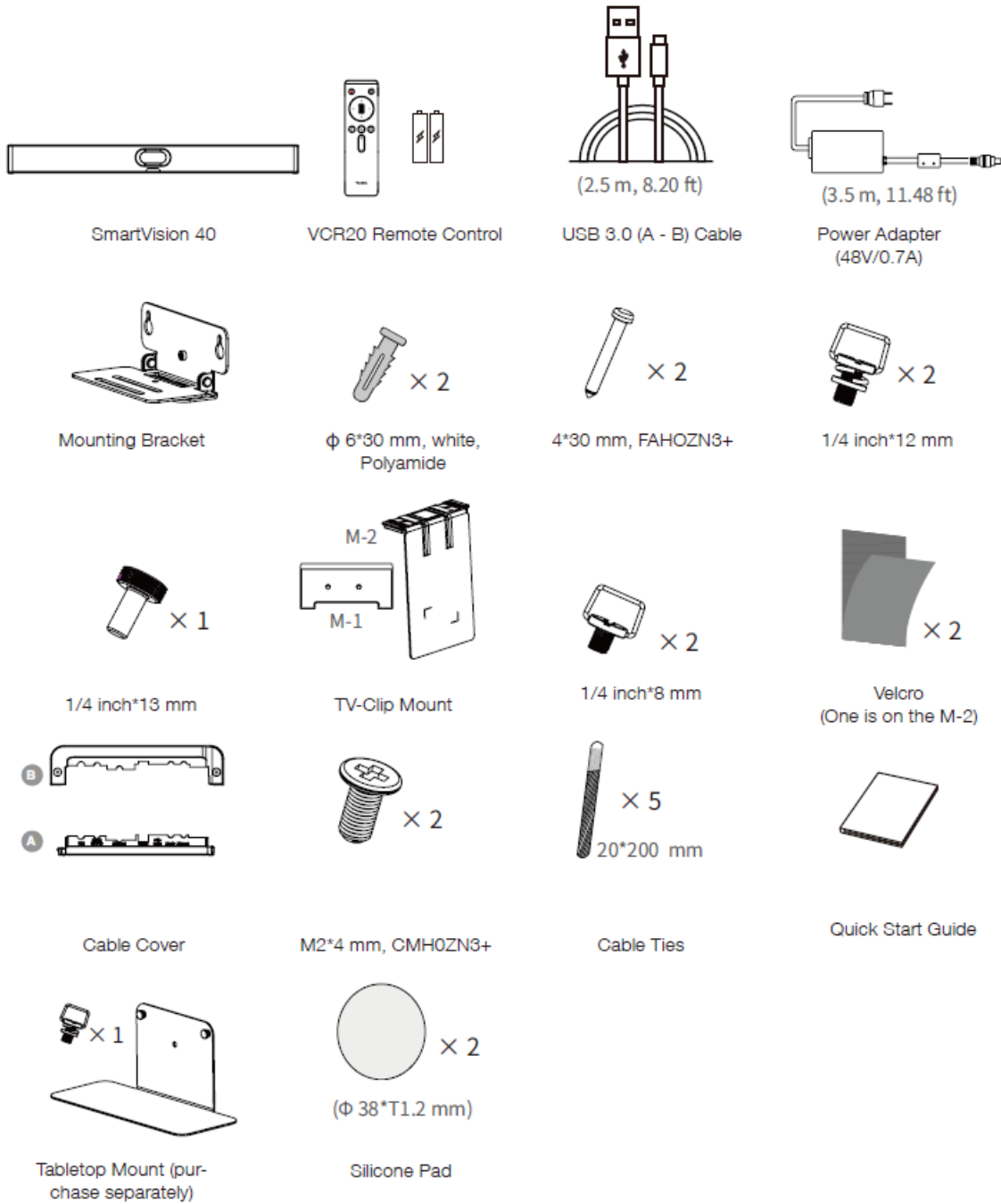

Assemble Cable Cover

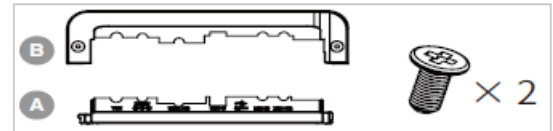

- 1 Find the two slots on the back of SmartVision 40.

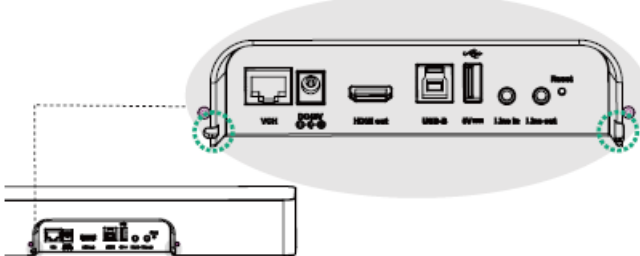

- 2 Fit part A of the cable cover into the slots.



- 3 Connect cables.

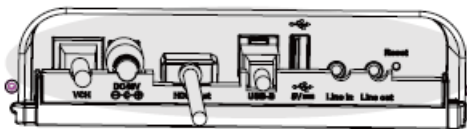

- 4 Assemble part B and fix the screws.

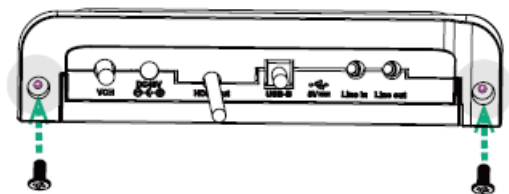

Install SmartVision 40

Install SmartVision 40

- Put on a Flat Surface

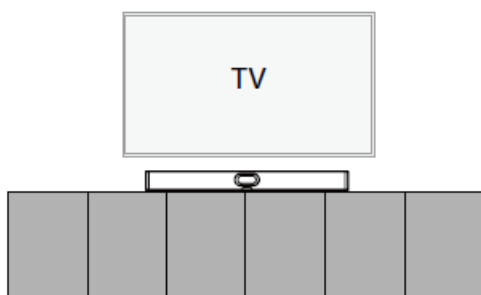

On the desk

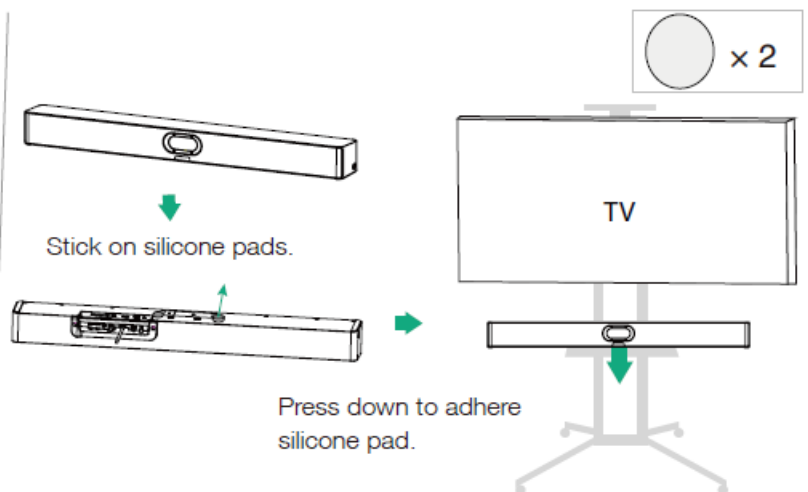

On the TV stand cart platform
(purchase separately)

- **Mount on a Wall**

Step 1: Determine SmartVision 40 position

The mounting height affects your camera view. The recommended height is 110 cm above the ground.

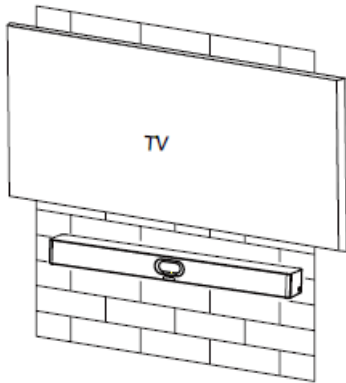

Step 2: Mount the SmartVision 40 to the wall

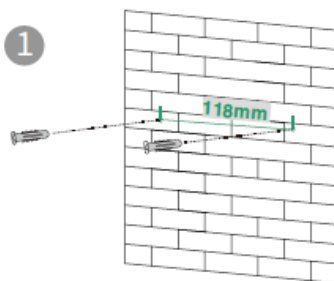

Hole depth: 30 mm
Hole diameter: 6 mm

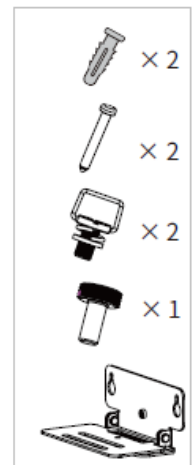
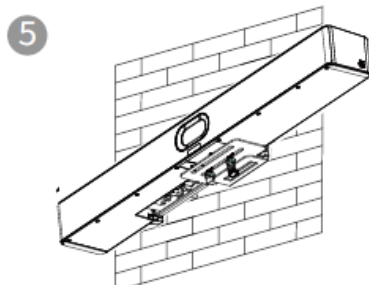
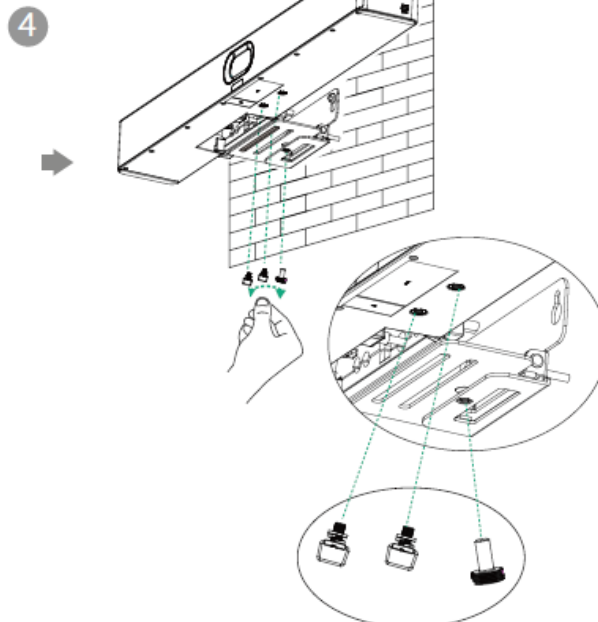
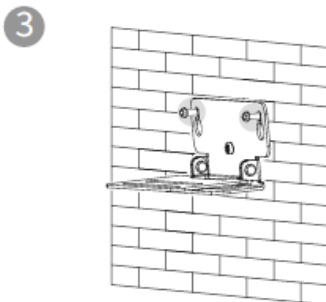
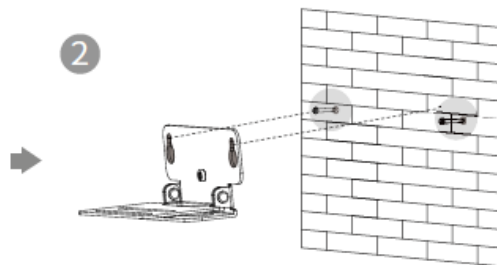

This deployment plan meets the ADA regulatory requirements in the United States.

• Embed in the wall

The mounting height affects your camera view. The recommended height is 110 cm above the ground.

① NOTE

- Keep the front of the SmartVision 40 flush with the wall surface.
- The recommended on the left, right, and top sides of the SmartVision 40 is less than 0.5 cm.
- Leave a 5 ± 0.5 cm distance between the back of the SmartVision 40 and the wall surface for cable connections.

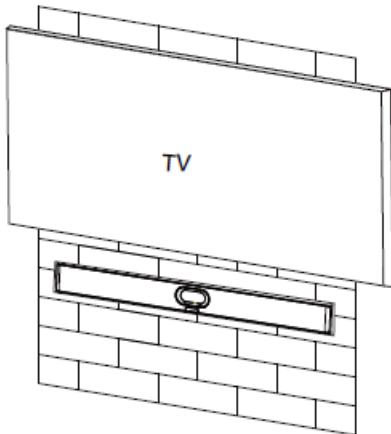

• Mount on the Tabletop Mount

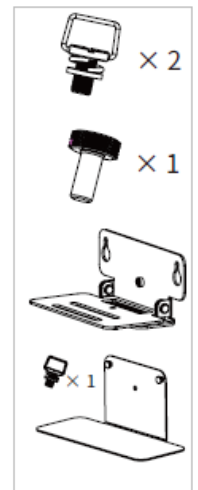
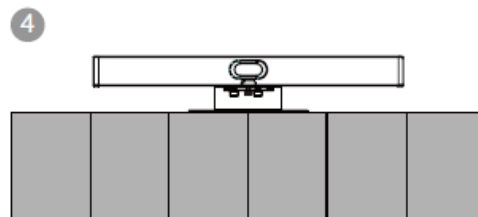
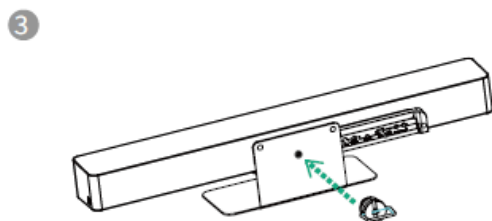
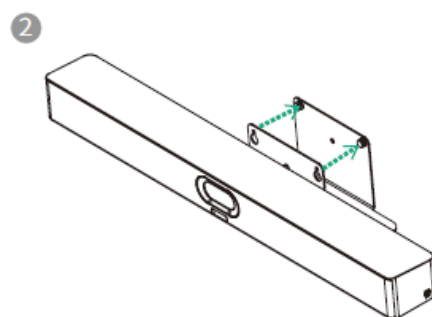
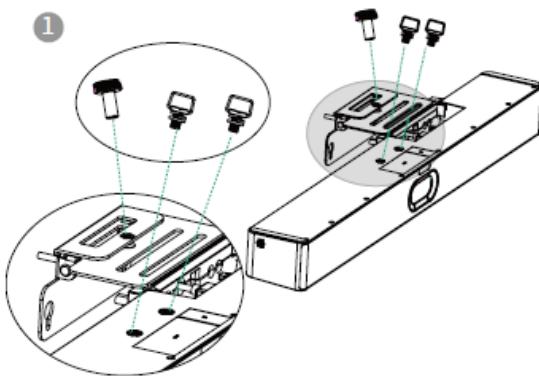

• Mount above a TV or a display

① **NOTE**

- The M-2 bracket can be inserted into the M-1 in two directions. Here, we will focus on one direction for illustration.
- Due to device weight, it is advisable to avoid mounting the device on slim TVs to prevent potential falls or damage to the screen.

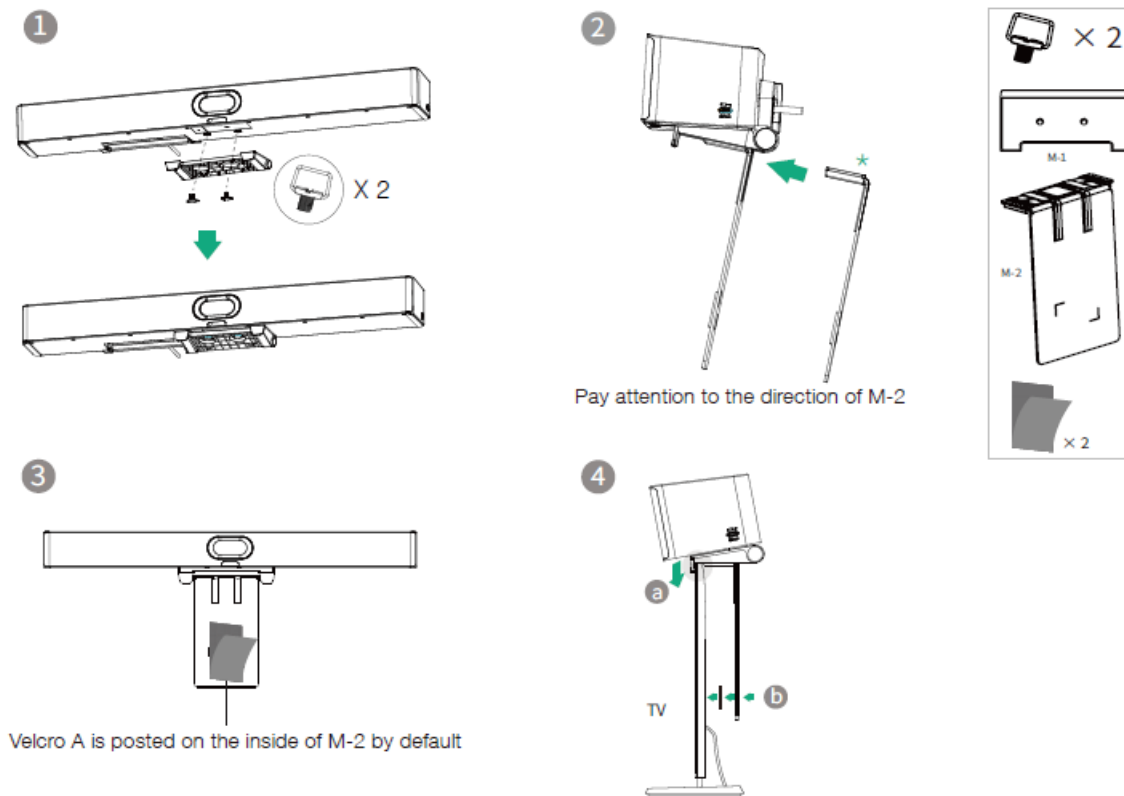

Adjust Camera Tilt

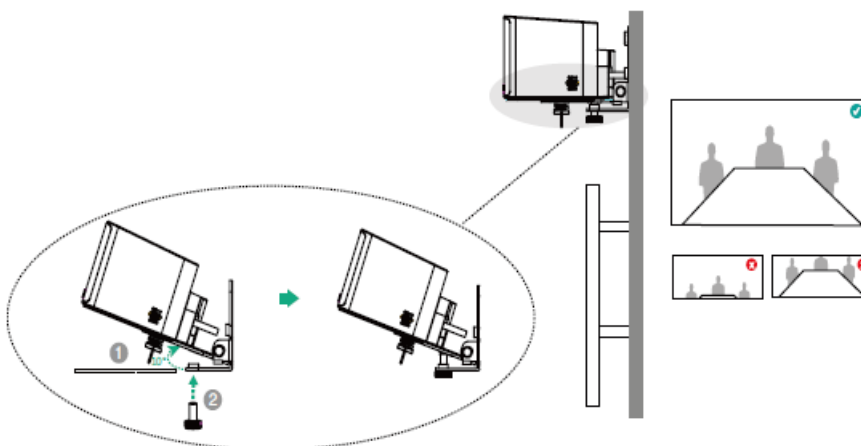

Remote Control and Cable Ties Installation

Remote Control Installation

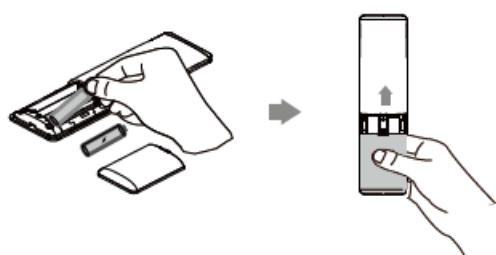

Cable Ties Installation

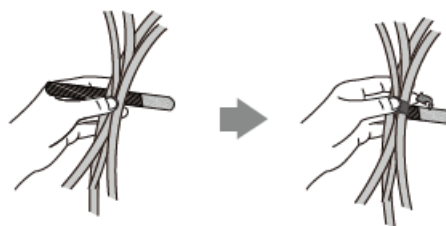

Hardware Interface

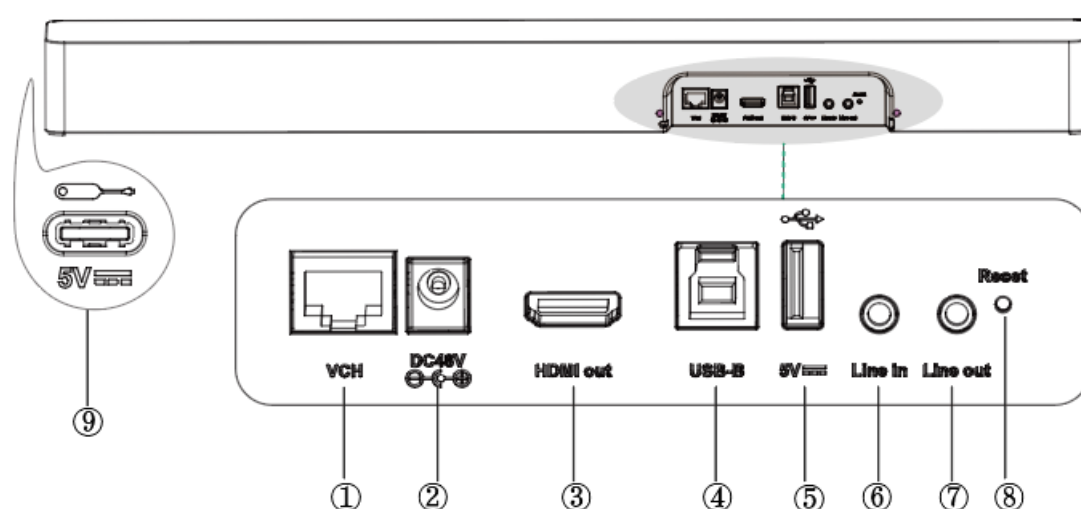

No.	Item	Description
1	VCH	Connect to microphones or MVC-BYOD-Extender.
2	DC48V	Connect to a power adapter.
3	HDMI Out	Reserved port for future features.
4	USB Type-B (USB 3.0)	Connect to a PC as video output.
5	USB Type-A (USB 2.0)	Connect to USB flash driver to export device log.
6	Line In	Connect a 3.5mm audio connector to use the SmartVision 40 as an audio output device.
7	Line Out	Connect a 3.5mm audio connector to output audio to the hearing assistance system.
8	Reset	Reset the SmartVision 40 to factory defaults.
9	USB Type-C (USB 2.0)	Pair with WPP30.

Connect SmartVision 40

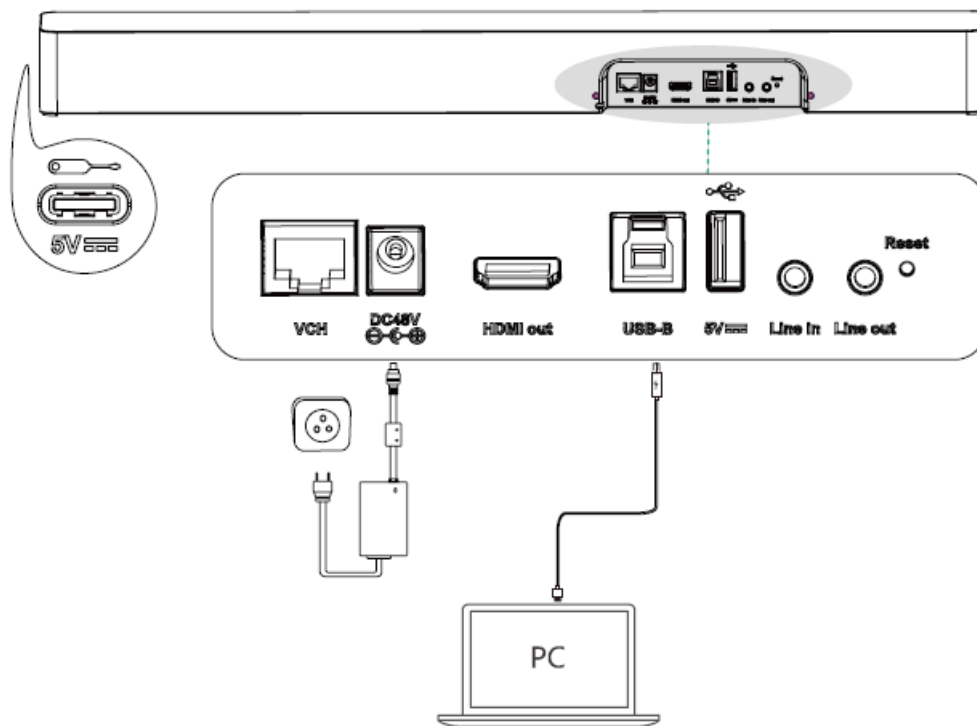

LED Indicator

LED Status	Description
Off	The SmartVision 40 is not properly connected to the mini-PC.
Flashing green	There is an incoming call.
Solid green	The SmartVision 40 is active.
Solid red	The SmartVision 40 is muted.
Solid orange	The SmartVision 40 is initializing or in sleep mode.
Flash orange	The SmartVision 40 is upgrading firmware.
Flash red and green alternately	The SmartVision 40 is paired with the VCM36-W.
Flash red	The SmartVision 40 is in recovery mode, and the firmware has not been upgraded.

SmartVision 40 Datasheet

All-in-one Intelligent Camera for Enhanced Teams Rooms Experience

Yealink SmartVision 40 is an ultra-high-definition intelligent all-in-one conference system designed for small to medium meeting rooms. It integrates leading intelligent AI algorithms to enhance meeting efficiency.

It will combine the images from two 48MP lenses, present a higher pixel picture, and deliver clearer image quality. It also features built-in stereo speakers, 8 long-range pickup microphones, and supports 2 additional expansion microphones*. The intelligent noise reduction technology provides a good audio experience.

Furthermore, it is equipped with intelligent AI technologies such as face detection, sound source positioning, and voice tracking. It intelligently tracks the movements of conference participants, ensuring that the focus is always on the speaker, providing clear and stable images.

In addition to the basic automatic framing and speaker tracking functions, it introduces the Multi-stream IntelliFrame feature*. Through multi-stream output, it can detect speakers in the meeting room and automatically frame and display them on the screen. This enables remote participants to see the facial expressions and postures of each speaker clearly, creating a more intuitive and interactive remote meeting experience.

Moreover, its deployment and installation are also straightforward. With its integrated design, you simply need to place it in the appropriate position in the meeting room, and connect it to power and the network, without the need for complicated wiring and setup steps. To protect the privacy and security of meetings, the Yealink SmartVision 40 is designed with an automatic lens privacy cover, providing users with a secure and intelligent conference experience.

*Support 2x expansion microphones: Optional

*Currently ship SmartVision 40 with IntelliFrame, will ship SmartVision 40 with Multi-stream IntelliFrame from 2024 Q2.

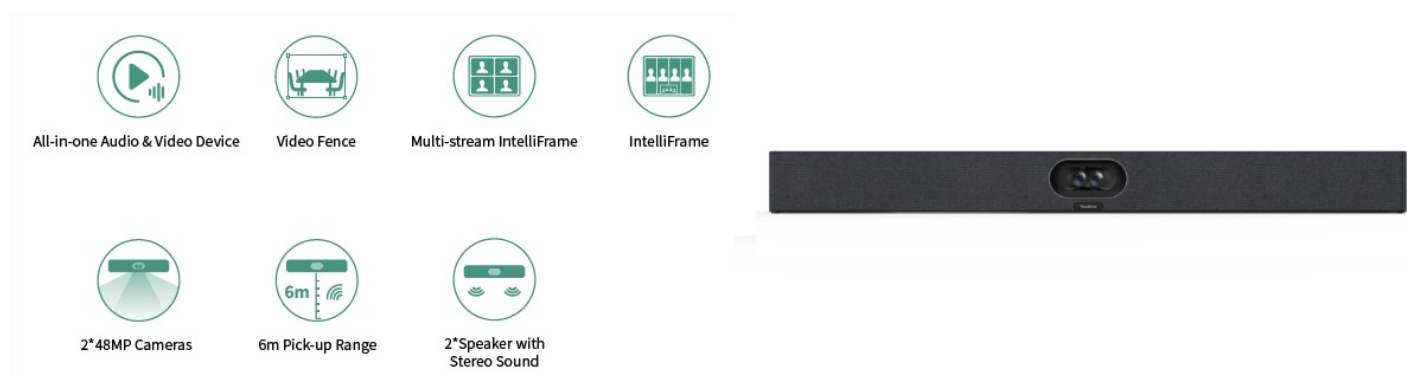

Key Features and Benefits

- Ultra HD picture quality
- Artificial AI features
- High-quality audio pickup experience
- Remote device management
- Simple deployment

- Privacy protection
- Wireless BYOD*

Ultra HD picture quality

The dual lens fixed-focus stitching solution combines the images from two lenses to achieve a higher pixel density, resulting in clearer and sharper image quality. This is beneficial for detailed observation during meetings, document presentations, and the viewing experience of remote participants.

Artificial AI Features

The intelligent AI features not only include basic automatic framing and speaker tracking functions but also include the IntelliFrame feature. It can automatically detect speakers in the meeting room, frame them, and display them on the screen through multi-stream output, providing a more intuitive and interactive remote meeting experience. Additionally, the Video Fence feature can intelligently identify and block interfering factors in the meeting room, maintaining a clean and professional meeting display.

High-quality audio pickup experience

SmartVision 40 has a 6-meter voice pickup range, 4-meter quality voice pickup range and built-in stereo speakers, 3-meter full-duplex technology, and 8x long-range pickup microphones. The intelligent noise reduction technology provides a good audio experience. In addition, it can support 2 additional expansion microphones, that can cover a large conference room.

Remote Device Management

SmartVision 40 is networked and reported to the device management platform, then can be remotely managed, configured, and upgraded.

Simple deployment

All-in-one audio and video device, comes with a standard 2.5-meter USB cable, includes a standard wall mount bracket, and optional TV wall mount is available.

Privacy Protection

SmartVision 40 is designed with an automatic lens privacy cover, providing users with a secure and intelligent conference experience.

Specification

Parameters	Description
Camera	<ul style="list-style-type: none">• 2× 48MP• DFOV 120°• Automatic lens privacy cover• Camera preset
Audio	<ul style="list-style-type: none">• Built-in 8 MEMS microphone array• 6-meter voice pickup range• 4-meter quality voice pickup range• Stereo speakers• Support 2x expansion microphone• Intelligent noise cancellation technology• Full-duplex technology• Echo cancellation technology

AI Feature	<ul style="list-style-type: none">• IntelliFrame• Multi-Stream IntelliFrame (Only for Microsoft Teams Room)• Video Fence• Auto Framing• Speaker Tracking• Image Super Resolution Technology• Multi-Focus• Picture-in-Picture
Connections	<ul style="list-style-type: none">• 1x USB3.0 Type-B port• 1x USB2.0 Type-A port• 1x USB-C port• 1x Yealink VCH port (RJ-45)• 1x 3.5mm Line-in & Line-out port• 1x Power port• 1x Security lock slot• 1x Reset slot• 1x HDMI-out• Built-in Wi-Fi
Package Features	<ul style="list-style-type: none">• SmartVision 40: 650 × 62 × 80 mm• N.W/CTN: 5.540 kg• G.W/CTN: 6.086 kg• Wall mount (ADA Standard)
Physical Specifications	<ul style="list-style-type: none">• Operating humidity: 10-95%• Operating temperature: 0-40°C