

# Downlights

**SPARK** Series

## — User Manual

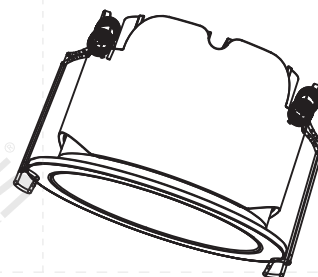
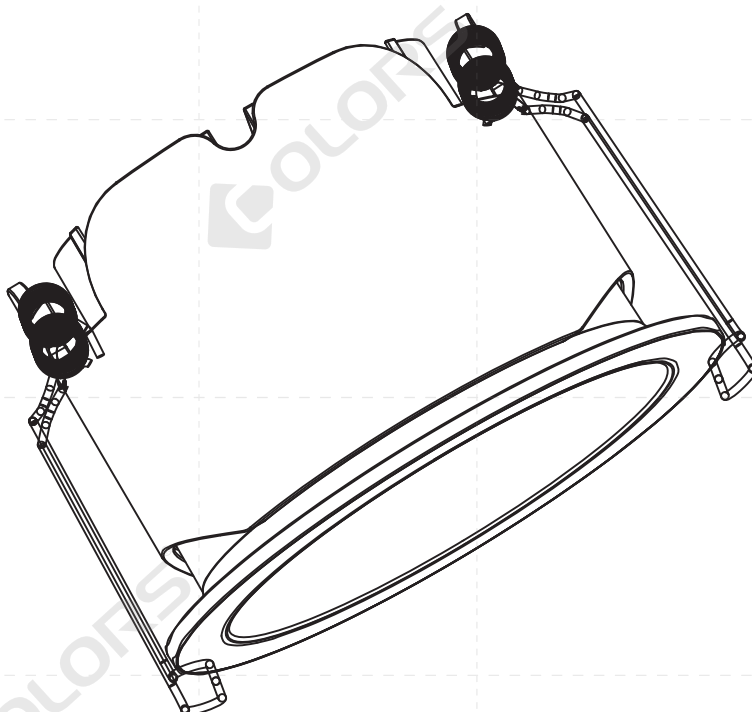

### Use Suggestion

1. Please read this manual carefully before installation and use it in the correct way.
2. This manual also contains the attached instructions.
3. Please keep this manual properly after reading and understanding it, so that the owner of this product can refer to it at any time.

Product category	Product name	Cut-out size	Form factor
COB anti-glare model	SE75L	Φ75mm	Φ82*H53mm
	SE88L	Φ88mm	Φ96*H58mm
	SE98L	Φ98mm	Φ106*H63mm
	SE113L	Φ113mm	Φ123*H68mm
Diffusion section	SE75D	Φ75mm	Φ82*H53mm
Diffusion section	SE88D	Φ88mm	Φ96*H58mm
Diffusion section	SE98D	Φ98mm	Φ106*H63mm
Diffusion section	SE113D	Φ113mm	Φ123*H68mm
Diffusion section	SE145D	Φ145mm	Φ155*H76mm
Diffusion section	SE170D	Φ170mm	Φ 185*H83mm

# Recessed spotlights

## 1. Narrow bezel shrapnel mounting

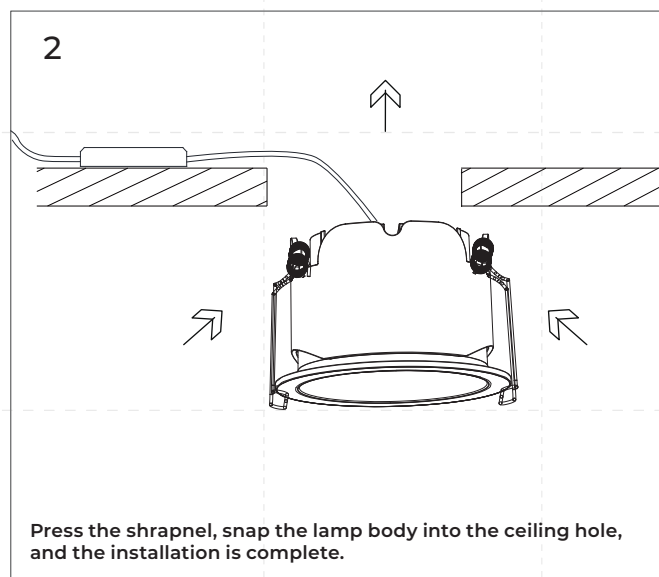
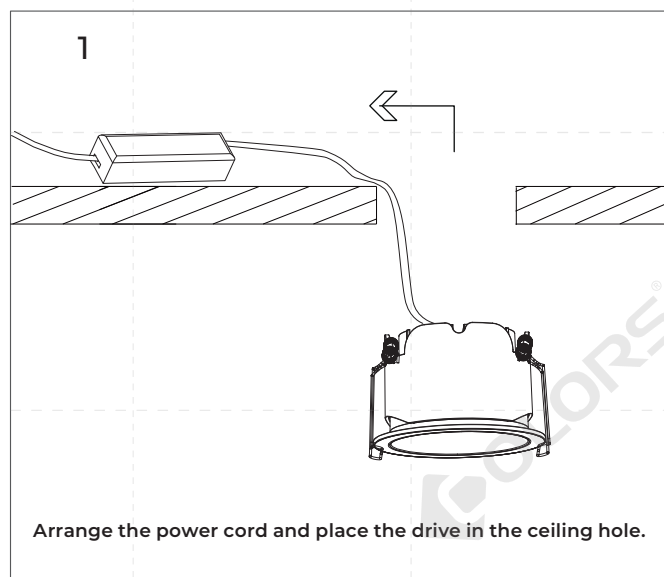
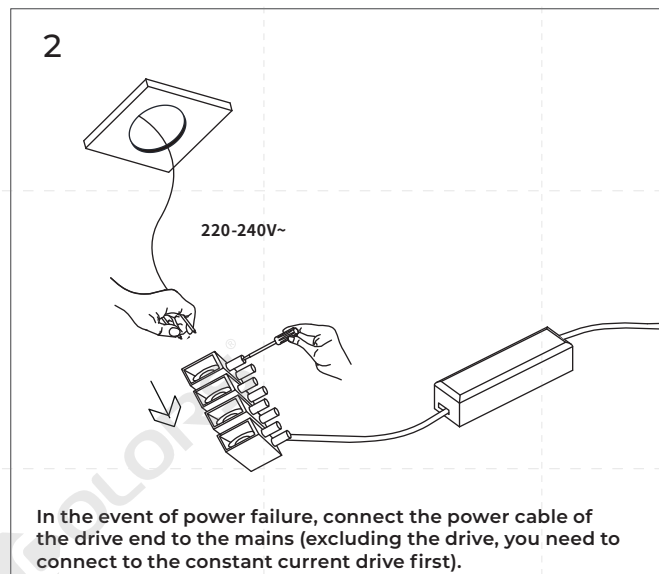
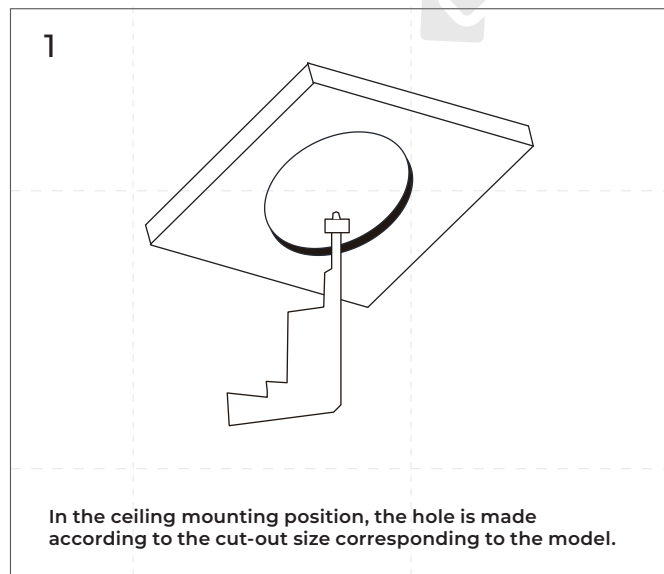

The above steps are limited to the installation of narrow frame lamps, and the specific appearance is subject to the actual product!



To secure safety, a qualified electrician is required to install/remove the luminaire.

The luminaire is used exclusively for lighting and is to be installed/removed in accordance with Electricity regulations and installation instructions.