

Through beam sensors

FEDK 10 (Receiver)

sample drawing

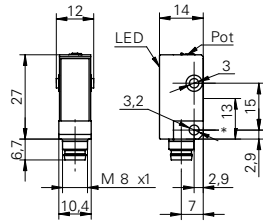

* receiver axis

general data

type	through beam sensor
emitter / receiver	receiver
actual range Sb	5 m
nominal range Sn	6 m
alignment / soiled lens indicator	flashing light indicator
light indicator	LED yellow
sensitivity adjustment	potentiometer, 270°

electrical data

response time / release time	< 1,4 ms
voltage supply range +Vs	10 ... 30 VDC
current consumption max. (no load)	16 mA
current consumption typ.	16 mA
voltage drop Vd	< 1,8 VDC
output current	< 100 mA
short circuit protection	yes
reverse polarity protection	yes

mechanical data

width / diameter	10,4 mm
height / length	27 mm
depth	14 mm
type	rectangular
housing material	plastic (ASA)
front (optics)	PMMA

ambient conditions

operating temperature	-25 ... +65 °C
-----------------------	----------------

sample picture



order reference	connection types	output circuit	output function	protection class
FEDK 10N5101	cable 4 pin, 2 m	NPN	light / dark operate	IP 65
FEDK 10N5101/S35A	connector M8 4 pin	NPN	light / dark operate	IP 67
FEDK 10P1101/KS35	flylead connector M8 3 pin	PNP	light operate	IP 65
FEDK 10P3101/KS35	flylead connector M8 3 pin	PNP	dark operate	IP 65
FEDK 10P5101	cable 4 pin, 2 m	PNP	light / dark operate	IP 65
FEDK 10P5101/S35A	connector M8 4 pin	PNP	light / dark operate	IP 67