



PRODUCT

INSTALLATION GUIDE

Saiga Adjustable Strikeforce Elite Stock

A.1.10.1150 A.1.20.1150 A.1.40.1150

Contents Included

- Six Position Adjustable Stock
- Scorpion Recoil System
- Slim Line Rear Aluminum Receiver Mount
- 3M Industrial Grade Self Adhesive Soft Touch Cheekrest
- Removable and Adjustable Cheekrest

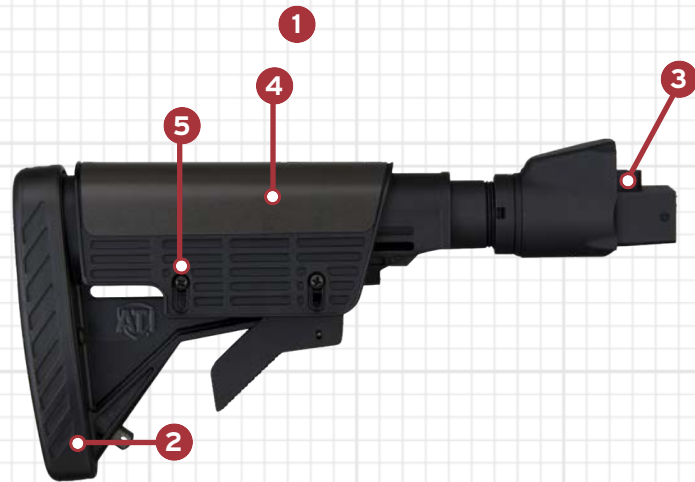

Installed on Firearm





Saiga Adjustable Strikeforce Elite Stock

Hardware Included



- [1] M4 x 0.7mm x 12mm
- [2] 8-32 x 1/4" Set Screw
- [4] 6 x 48/2 x 3/8" Flat Head Phillips Screw
- [4] 6-32 x 3/8" Machine Screw



- [1] Castle Nut
- [4] 6-32 Hex Nut

Tools Needed



Phillips Head Screwdriver



Torx Set



Wrench Set



Drill Press



Warning: When handling a firearm, always follow the proper handling procedures at all times. Failure to follow these procedures could result in serious damage, injury, or death. ATI is not responsible for damage to property, injury, or death resulting from improper installation, misuse or modification of products. If you are not comfortable completing any of the following steps, or do not have the proper tools enlist the help of your local gunsmith. ATI is not responsible for components that are damaged due to improper installation.

A

Stock Removal



Point the firearm in a safe direction and place the safety in the "on" position. Next, pull back the slide and carefully inspect the chamber and magazine to be sure the firearm is unloaded.

Warning: Do not overtighten screws. Stripped holes and sheared screw heads are NOT covered under manufacturer's warranty.

NOTE: Trigger assembly must be modified to the forward position for installation of ATI's Strikeforce Packages. ATI does not supply the components necessary to modify the trigger assembly.

1

Disassemble the Saiga using your owners manual. Begin by removing the receiver cover from your Saiga as seen in Figure 1.





A Stock Removal

- 2 Remove the recoil spring from the shotgun as seen in Figure 2. Place both the recoil spring and the receiver cover aside for later installation.



- 3 Locate the (2) stock screws on the receiver tang at the top of the Saiga. Remove the (2) screws using a philips head screwdriver as seen in Figure 3A. Now, flip the shotgun over and repeat this same process for the (1) bottom stock screw as seen in Figure 3B.

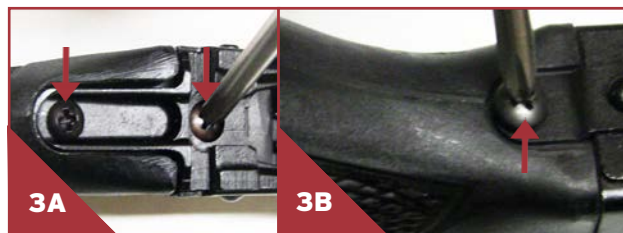

- 4 With each of the (3) stock screws removed, slide the Saiga buttstock out of the receiver as seen in Figure 4.





B

Triton Mount Installation

1

Remove the Saiga Elite Mount from the buffer tube by using a AR-15 wrench as seen in Figure 1A. Once the lock nut is loose and threaded back about 1/2", slide back the locking ring so the tab is no longer engaged into the elite mount. You can now unscrew the mount from the buffer tube as seen in Figure 1B.



1A



1B

2

Place the new ATI Elite Mount into the receiver of the Saiga as seen in Figure 2.



2

3

Next, use a paint pen to mark a circle onto the mount by placing the pen through the hole on the receiver mount as seen in Figure 3. Make sure the mount is held tight and flush to the receiver when making your mark.



3



B

Triton Mount Installation -Continued

4

Once you have the mount marked, clamp the housing securely in position on the drill press as seen in Figure 4.



5

Next, double check positioning for squareness. Using a level, check to ensure the mount is fixed in a level position as seen in Figure 5.

NOTE: If you are not comfortable with using a drill press to complete the following steps, enlist the help of your local gunsmith. ATI is not responsible for components that are damaged due to improper drilling and tapping methods.





B

Triton Mount Installation -Continued

NOTE: For steps 6-8 you will use the provided kit that will include the 3.3mm drill bit, M4 X 0.7mm tap, and M4 x 0.7mm x 12mm screw.

6

With the mount still clamped, use the supplied 3.3mm drill bit and drill slowly (to a 1/2" depth) so as not to burr the inside of the hole as seen in Figure 6. (It is recommended to use cutting oil during the drilling process.)



7

Next, with the mount still clamped, use the supplied M4 X 0.7mm tap (and cutting oil), to tap the mount as seen in Figure 7.

NOTE: To ensure you do not ruin the mount when backing the tap out of the mount, it is necessary to use a drill press with a clutch.





B Triton Mount Installation -Continued

- 8 Without unclamping, clean the tapped hole area and securely screw in the supplied M4 x 0.7mm x 12mm screw to ensure the threads were cut correctly as seen in Figure 8.

NOTE: Remove the mount and clean it, removing any burr(s) from the tapped holes.



C Stock Installation

- 1 Locate the buffer tube and castle nut. Thread the castle nut onto the buffer tube, make sure the teeth of the castle nut are facing towards the rear of the buffer tube as seen in Figure 1.



- 2 Locate the locking channel on the buffer tube. Install the new lock ring by sliding it onto the buffer tube with the lock side facing outward. Push the lock ring to the rear of the buffer tube against the castle nut as seen in Figure 2.



- 3 Install the Elite Mount by screwing it onto the buffer tube. Now carefully align the Elite Mount slot with the locking ring as seen in Figure 3.





C

Stock Installation -Continued

4

Once the Elite Mount has been screwed down and aligned correctly with the locking ring, insert the locking ring into the slot on the Elite Mount as seen in Figure 4 (Shown with arrow). Now, tighten the castle nut until it is snug against the lock ring and Elite Mount using a AR wrench.



5

Slide the ATI Elite Mount into the rear of receiver as seen in Figure 5A and install the M4 x 0.7mm x 12mm screw with a T20 Torx Driver as seen in Figure 5B.

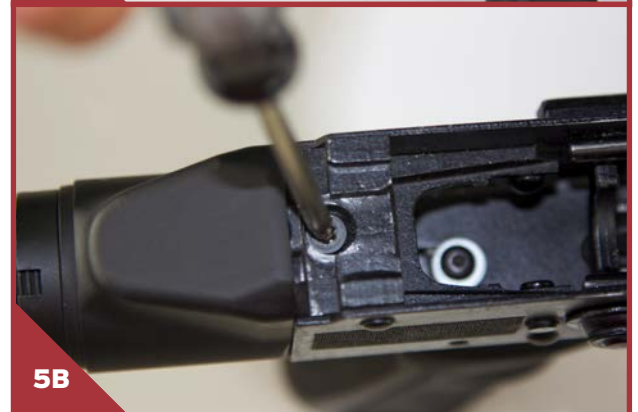

**C**

Stock Installation -Continued

6

You can now reinstall the receiver spring as seen in Figure 6A and receiver cover as seen in Figure 6B completing the installation of your ATI stock.

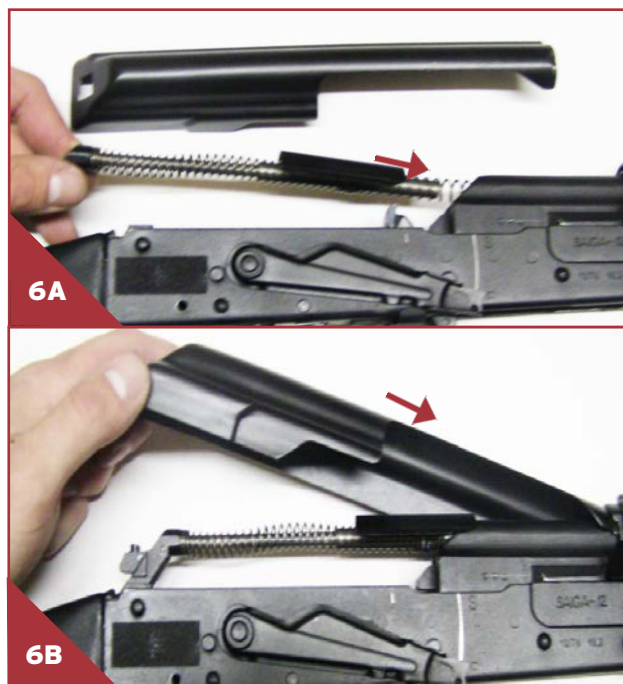
**D**

Cheekrest Installation

1

Place the 6/32 nuts into the slots of the cheekrest rail as seen in Figure 1.

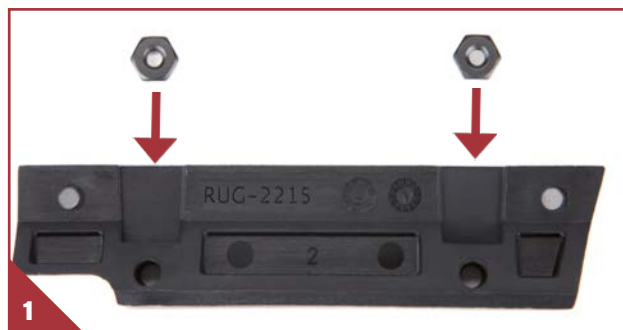



D Cheekrest Installation -Continued

- 2 Attach the right cheekrest rail onto the right side of the buttstock using the #6 x 48/2 3/8" flat head screws provided as seen in Figure 2. Repeat the same process on the left side of the buttstock.

NOTE: Make sure that the nuts inside the rail do not fall out while installing the rail onto the buttstock.



- 3 Slide the cheekrest onto the cheekrest rails and slide toward the rear of the buttstock as seen in Figure 3.



- 4 Line up the slots in the cheekrest with the holes in the cheekrest rails. Next use the 6-32 x 3/8" pan head screws provided to attach the cheekrest to the rails by securing the screws into the 6-32 nuts that were installed in the cheekrest rails in step 2 as seen in Figure 4.





E

Cheekrest Pad Installation

- 1 Begin by using the supplied alcohol swab to clean the cheekrest area on both sides of the stock as seen in Figure 1.
- 2 Wait 30 minutes until the alcohol is dried. Remove the backing from the adhesive side of the pad as seen in Figure 2.
- 3 Place the adhesive pad on the top of the cheekrest, aligning the center of the pad with the cheekrest parting line as seen in Figure 3.
- 4 Use your thumb to remove any air bubbles in the pad and to firmly press and secure the adhesive pad onto the cheekrest as seen in Figure 4.

