



ГИДРОТВЕТ

доступная гидравлика

НСВ液压马达

НСВ hydraulic motors

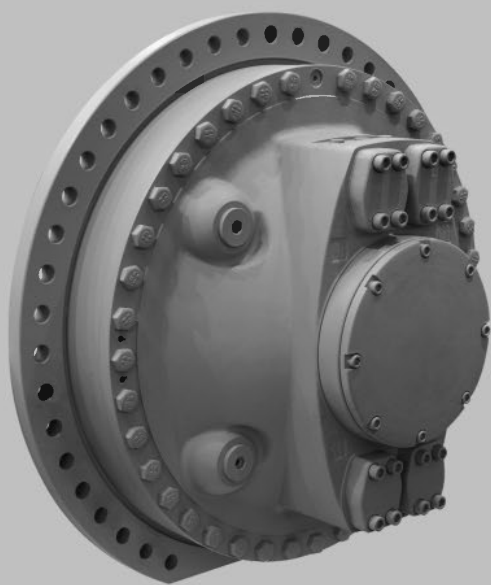

1、产品特点/ Product Feature	127
2、产品标识说明/ Ordering Code	127
3、技术参数/ Technical Specification	128
4、安装联接尺寸/ Installation Dimensions	
НСВ280系列/ HCB280 Series	129
НСВ400系列/ HCB400 Series	131
НСВ560系列/ HCB560 Series	133
НСВ840系列/ HCB840 Series	135

HCB系列/HCB Series

产品特点 / Product Feature

HCB系列液压马达是我司针对重型应用场合所开发的新产品。此产品能在各种恶劣工况稳定工作，能满足重载场合的使用要求，如在破碎机、输送带、铰刀头等重型机械上应用。在结构上，这款马达采用端面配流，径向柱塞内曲线形状，利用马达转子中空优势，能方便的根据用户要求配置制动器、测速器，及通过马达中孔的特殊设备，大大简化用户对主机结构的要求，并在设计上也很大程度的节省了空间。

其主要特点如下：

- 抗冲击能力强，稳定性好；
- 能实现自由轮工况；
- 多种安装方式及中空轴设计；
- 大输出扭矩、宽转速范围，可直接替代高速马达加减速机装置，结构紧凑（体积小）；
- 具有良好的低速稳定性，能在很低的转速下平稳运转；
- 具有较高的机械效率和容积效率；
- 旋转方向可逆；
- 功率质量比高；
- 可靠性好，维修方便。

HCB series' hydraulic motor is what we develop for heavy-duty application. It can work stably in various harsh conditions to meet requirements of the overloaded application, such as shredders, conveyor belt, hinge heads, and so on. ECA series' motor adopts the structure of disc flow, radial piston, and inner curve. With advantage of hollow shaft, it can easily be configured with the brakes, tachometer, and special equipments, which greatly simplifies the user's requirements of the host structure by saving much space for whole design.

Main characteristics:

- Good anti-shock capability and stability;
- Stable speed switch; brake available;
- Enable free running working condition;
- Multi-mounting options; hollow shaft design;
- Large output torque; wide speed range; directly replace combined devices of high speed motor and gearbox; compact structure;
- Stable performance in low speed;
- Higher mechanical and volumetric efficiency;
- Reversible rotation;
- Higher power-mass ratio;
- Higher reliability; easy maintenance;

产品标识说明 / Ordering code

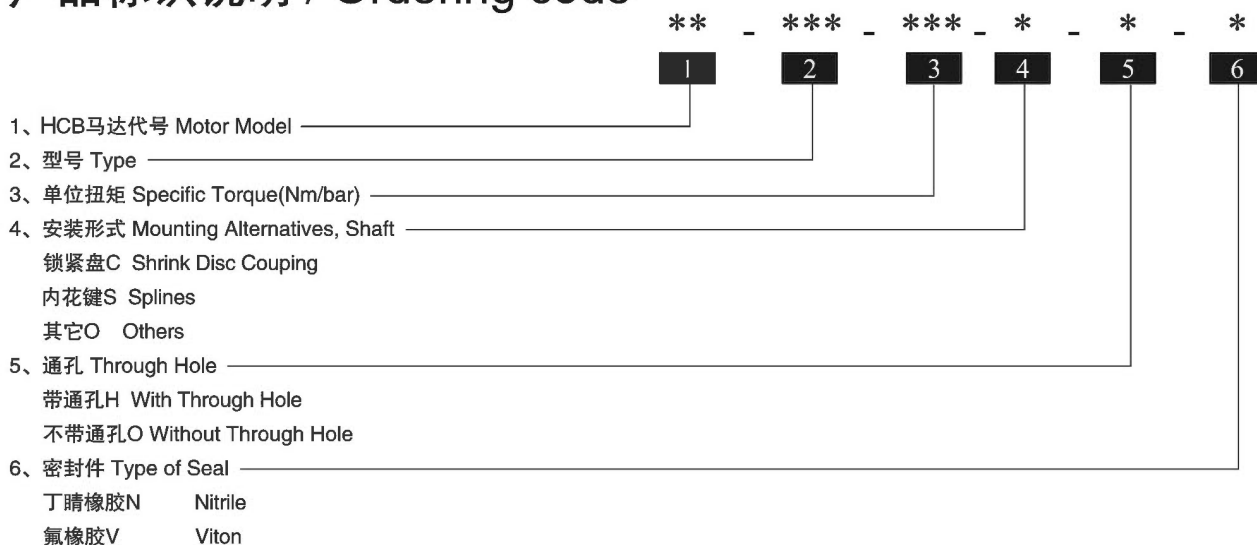

HCB系列/HCB Series

技术参数 / Technical Specification

马达型号 TYPE	排量 Displacement	单位扭矩 Unit Torque	额定压力 Rated Pressure	最大压力 Max. Pressure	额定扭矩 Rated Torque	额定转速 Rated Speed	最大转速 Max. Speed	重量(花键) Weight(Spline)	重量(锁紧盘) Weight (Shrink Disc Coupling)
	ml/r	N.m/bar	bar	bar	N.m	r/min	r/min	Kg	Kg
HCB280-240	15,100	240	250	315	60,000	45	58	705	800
HCB280-280	17,600	280	250	315	70,000	37	49		
HCB400-240	15,100	240	250	315	60,000	80	106	1060	1160
HCB400-280	17,600	280	250	315	70,000	62	89		
HCB400-320	20,100	320	250	315	80,000	60	80		
HCB400-360	22,600	360	250	315	90,000	50	70		
HCB400-400	25,100	400	250	315	100,000	49	64		
HCB560-440	27,600	440	250	315	110,000	42	55		
HCB560-480	30,200	480	250	315	120,000	41	53	1115	1290
HCB560-520	32,700	520	250	315	130,000	35	48		
HCB560-560	35,200	560	250	315	140,000	34	45		
HCB840-600	37,700	600	250	315	150,000	26	38	1445	1620
HCB840-640	40,200	640	250	315	160,000	24	35		
HCB840-680	42,700	680	250	315	170,000	23	34		
HCB840-720	45,200	720	250	315	180,000	21	31		
HCB840-760	47,800	760	250	315	190,000	20	29		
HCB840-800	50,300	800	250	315	200,000	20	29		
HCB840-840	52,800	840	250	315	210,000	18	27		



HFM

HGM

QJM

H-HMB

H-HMC

HCA

HCB

HMS

HA6V

HA2F

HCB280系列/HCB280 Series

HCB280 外形及安装尺寸/HCB280 Installation Dimensions

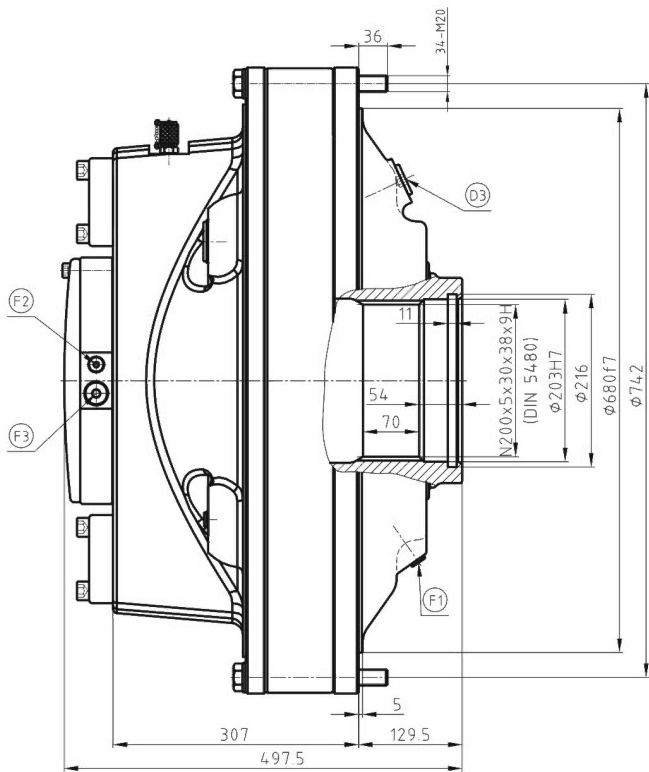

液压原理图/Hydraulic Schematic

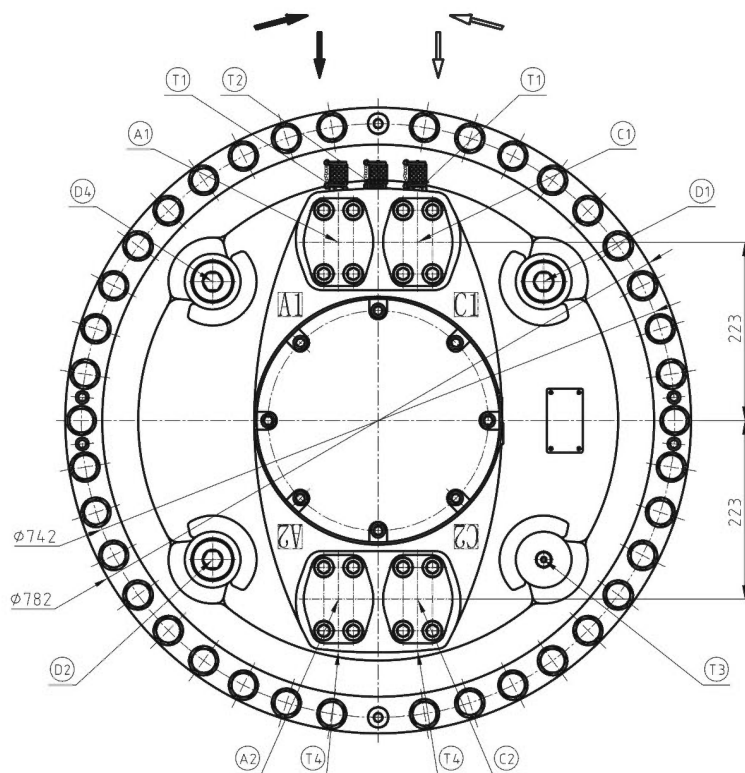
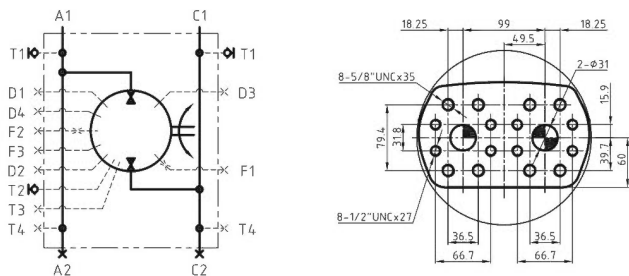

油口尺寸/Connection

主油口A Main Conn.A		主油口C Main Conn.C		泄油口 Drain Conn.				冲洗油口 Flushing Conn.			测压口 Test Conn.			
A1	A2	C1	C2	D1	D2	D4	D3	F1	F2	F3	T1	T2	T3	T4
SAE 1 1/4" & SAE 1 1/2"				BSP 1 1/4"				BSP 1"	BSP 1/4"	BSP 1/2"	BSP 1/4"			

HCB280系列/HCB280 Series

HCB280 外形及安装尺寸/HCB280 Installation Dimensions

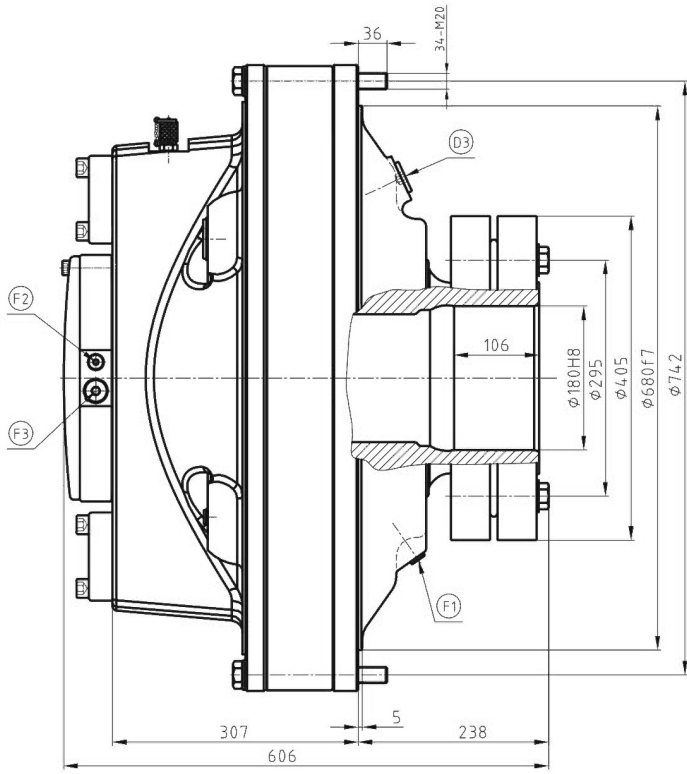

液压原理图/Hydraulic Schematic

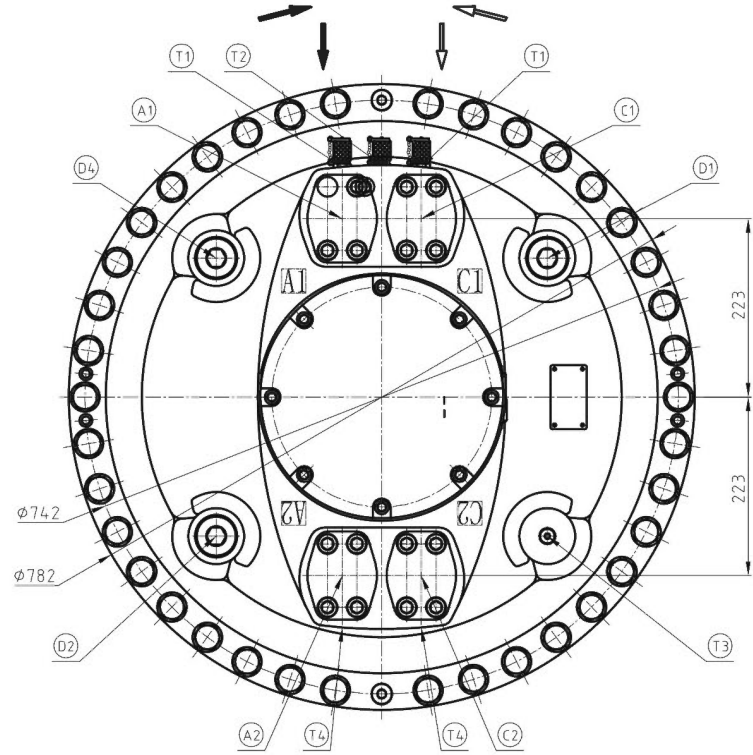
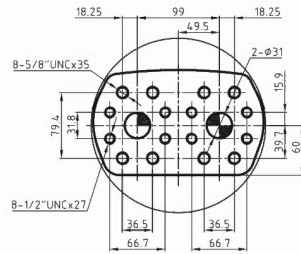
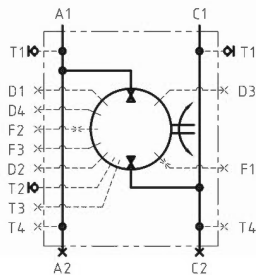

油口尺寸/Connection

主油口A Main Conn.A		主油口C Main Conn.C		泄油口 Drain Conn.			冲洗油口 Flushing Conn.			测压口 Test Conn.				
A1	A2	C1	C2	D1	D2	D4	D3	F1	F2	F3	T1	T2	T3	T4
SAE 1 1/4\"/>														

HCB400系列/HCB400 Series

HCB400 外形及安装尺寸/ HCB400 Installation Dimensions

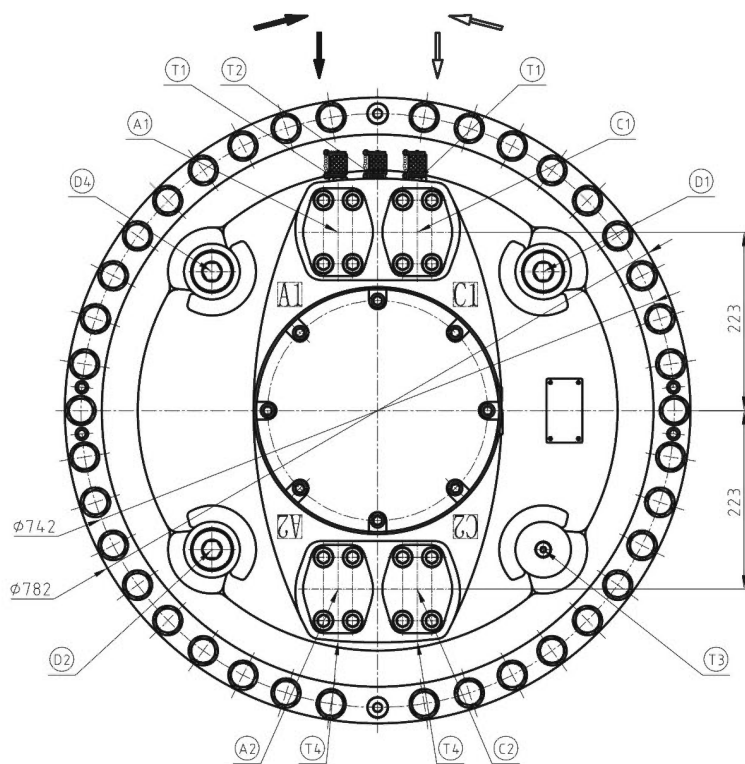
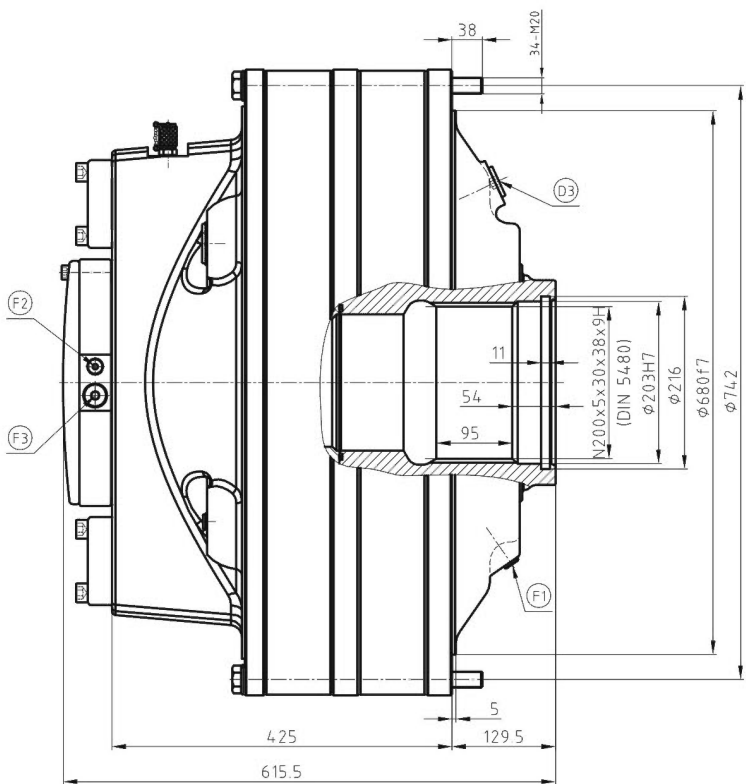

液压原理图/Hydraulic Schematic

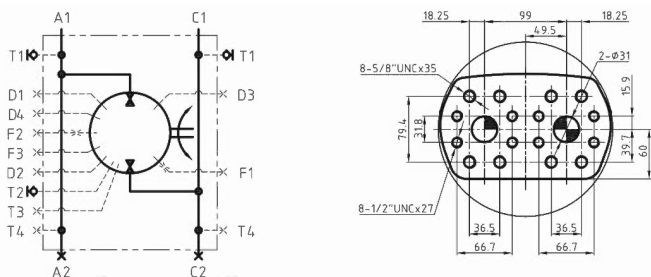

油口尺寸/Connection

主油口A Main Conn.A		主油口C Main Conn.C		泄油口 Drain Conn.			冲洗油口 Flushing Conn.			测压口 Test Conn.				
A1	A2	C1	C2	D1	D2	D4	D3	F1	F2	F3	T1	T2	T3	T4
SAE 1 1/4" & SAE 1 1/2"				BSP 1/4"			BSP 1"	BSP 1/4"	BSP 1/2"		BSP 1/4"			

HCB400系列/HCB400 Series

HCB400 外形及安装尺寸/HCB400 Installation Dimensions

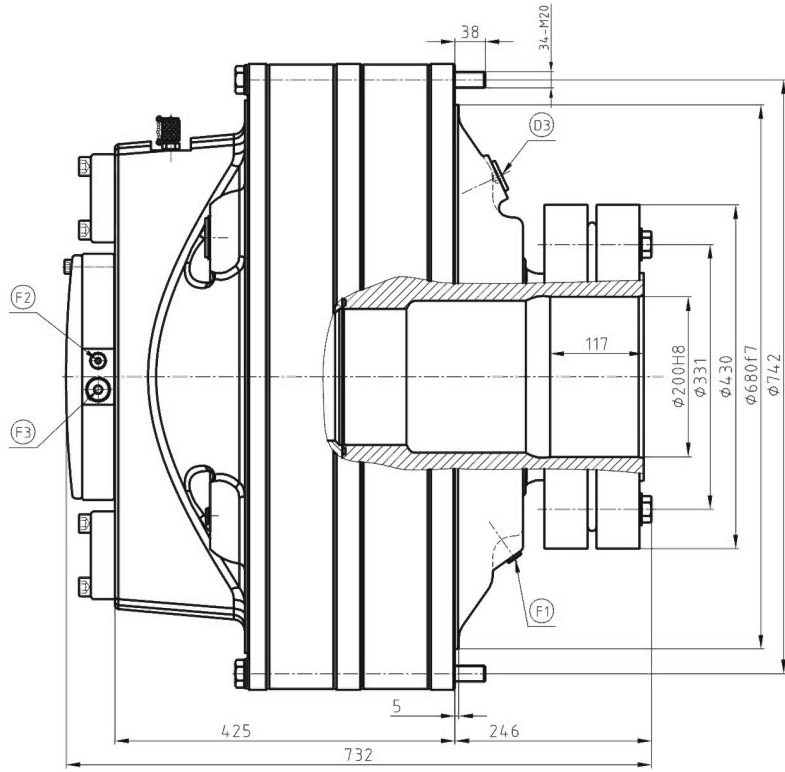

液压原理图/Hydraulic Schematic

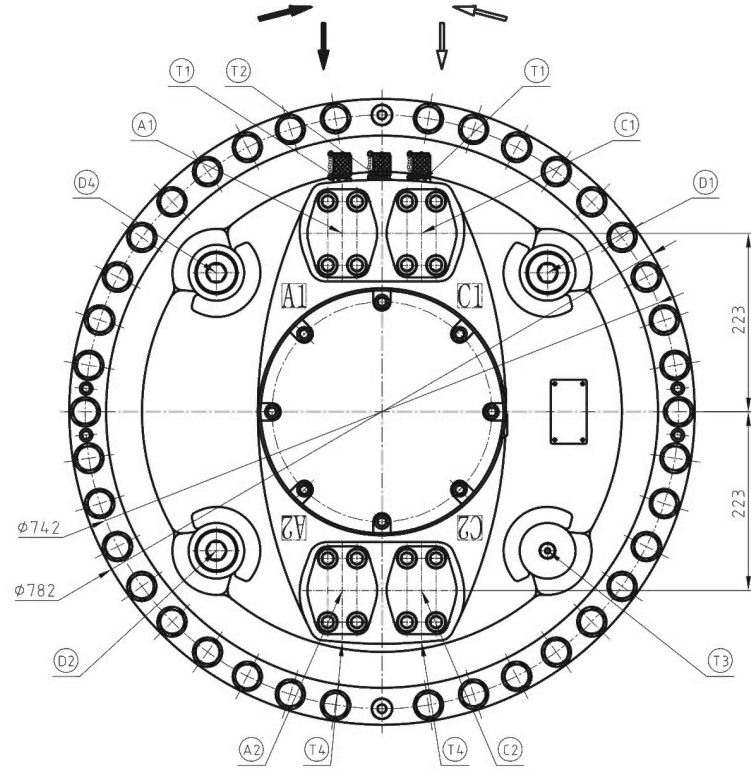
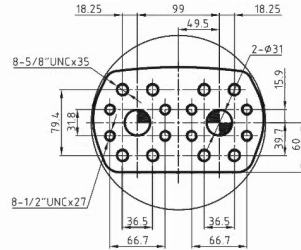
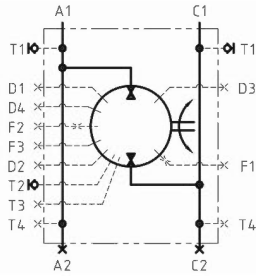

油口尺寸/Connection

主油口A Main Conn.A		主油口C Main Conn.C		泄油口 Drain Conn.			冲洗油口 Flushing Conn.			测压口 Test Conn.				
A1	A2	C1	C2	D1	D2	D4	D3	F1	F2	F3	T1	T2	T3	T4
SAE 1 1/4" & SAE 1 1/2"		SAE 1 1/2"		BSP 1/4"			BSP 1"	BSP 1/4"	BSP 1/2"		BSP 1/4"		BSP 1/2"	

HCB560系列/HCB560 Series

HCB560 外形及安装尺寸/HCB560 Installation Dimensions

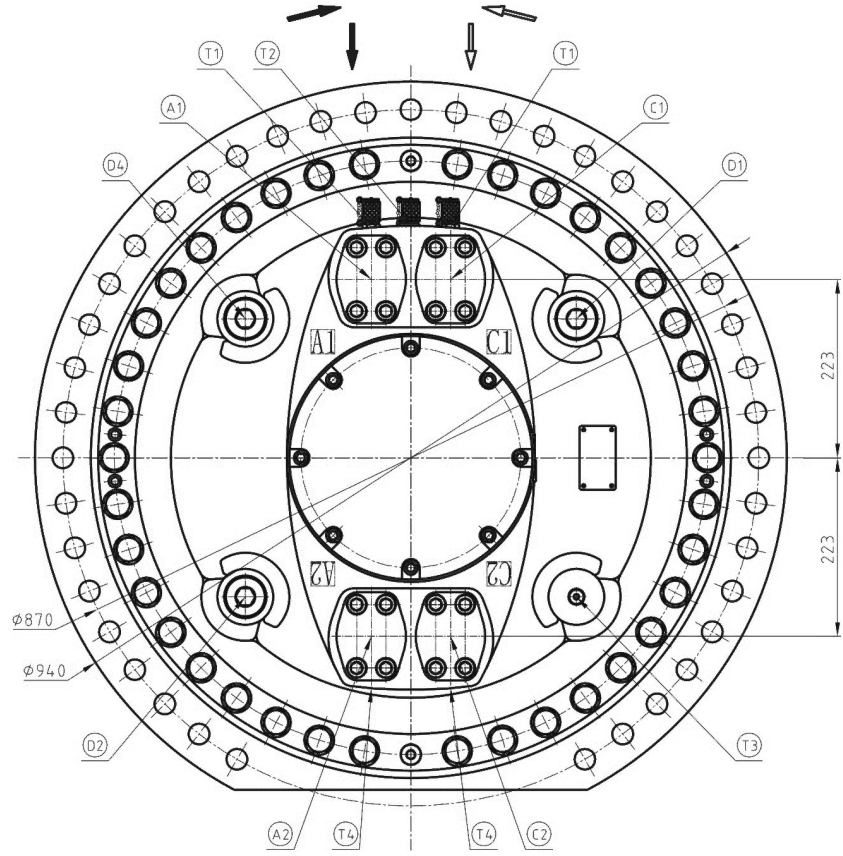
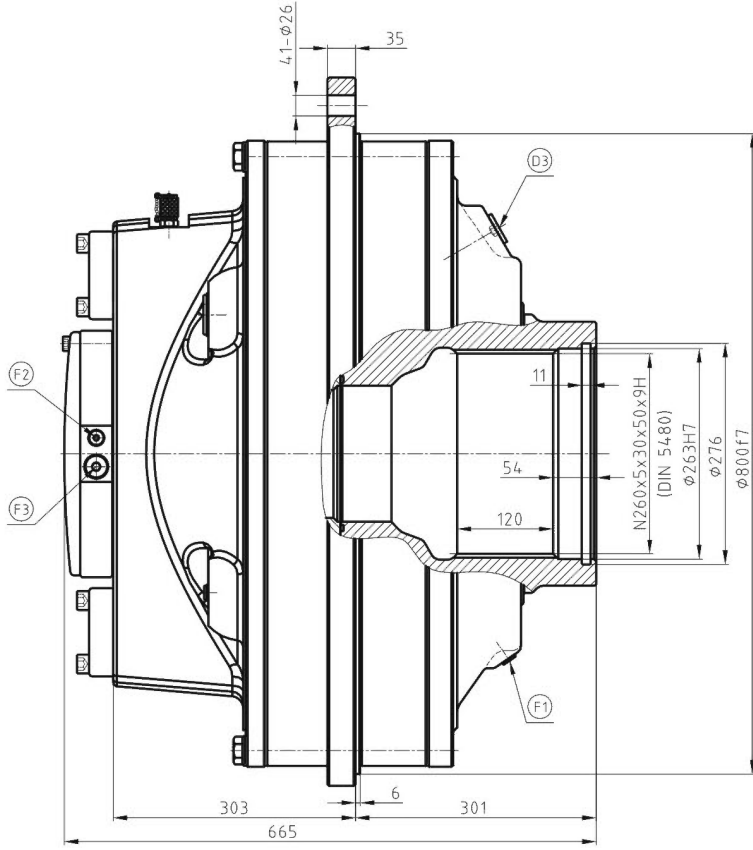

液压原理图/Hydraulic Schematic

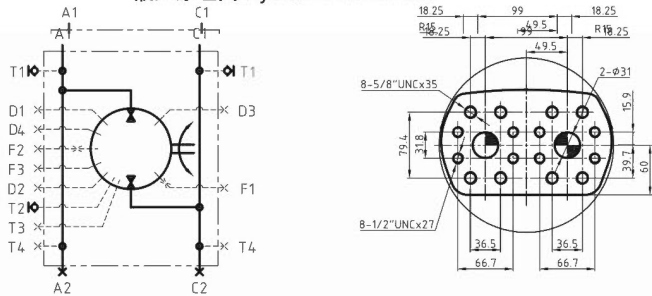

油口尺寸/Connection

主油口A Main Conn.A		主油口C Main Conn.C		泄油口 Drain Conn.			冲洗油口 Flushing Conn.		测压口 Test Conn.					
A1	A2	C1	C2	D1	D2	D4	D3	F1	F2	F3	T1	T2	T3	T4
SAE 1 1/4"&SAE 1 1/2"		SAE 1 1/4"&SAE 1 1/2"		BSP 1/4"			BSP 1"	BSP 1/4"	BSP 1/2"	F3	BSP 1/4"		BSP 1/2"	

HCB560系列/HCB560 Series

HCB560 外形及安装尺寸/HCB560 Installation Dimensions

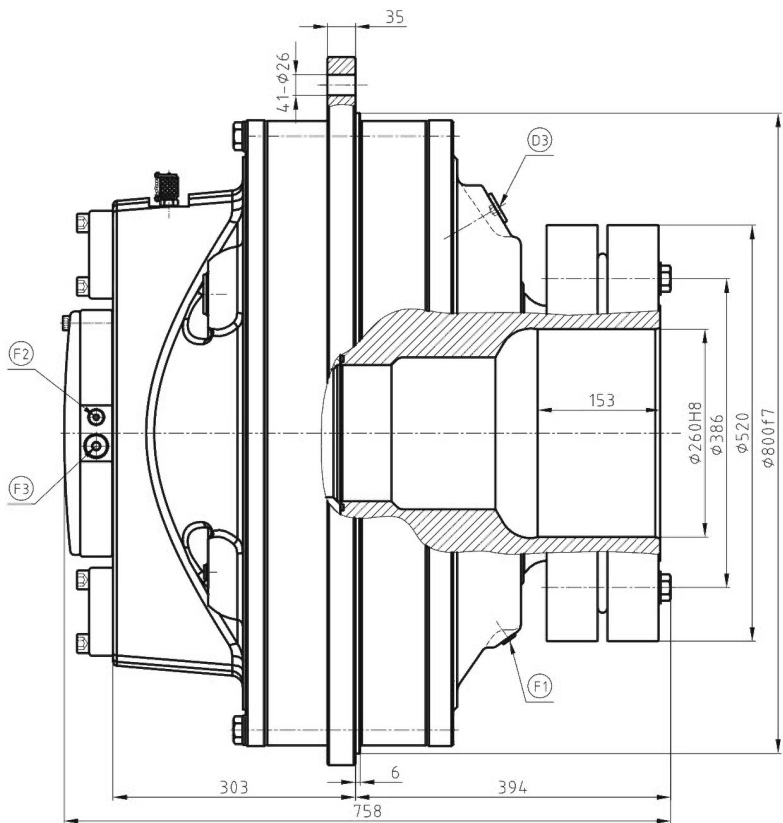

液压原理图/Hydraulic Schematic

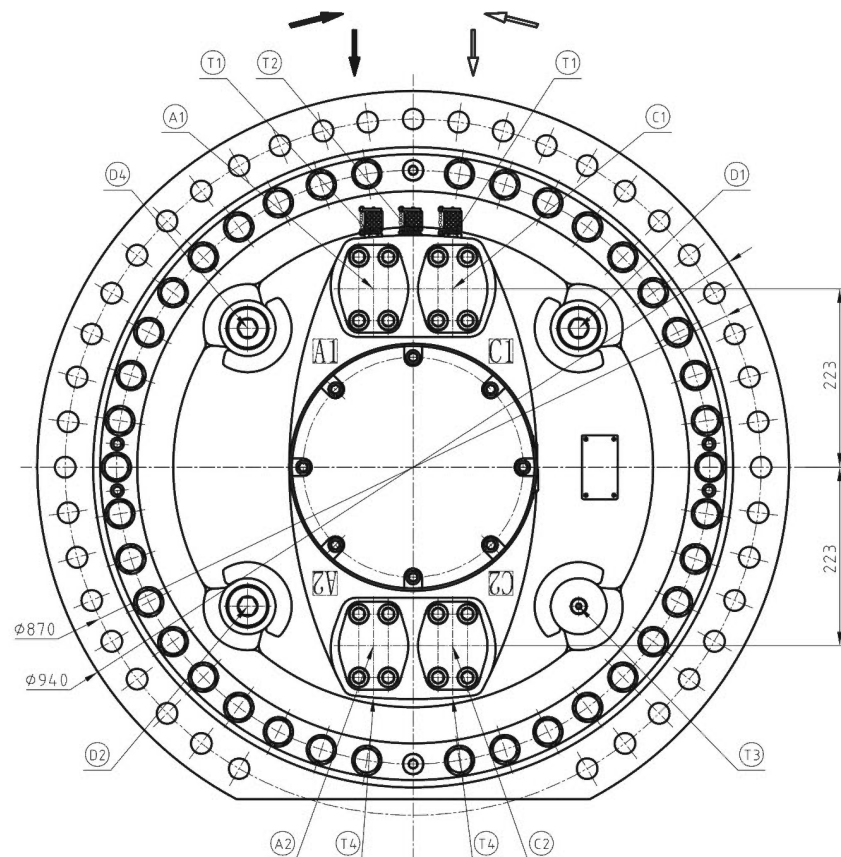
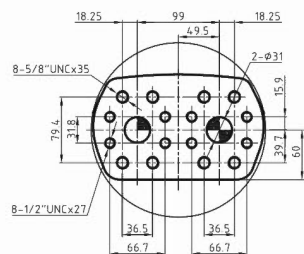
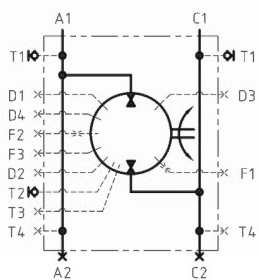

油口尺寸/Connection

主油口A Main Conn.A		主油口C Main Conn.C		泄油口 Drain Conn.				冲洗油口 Flushing Conn.			测压口 Test Conn.				
A1	A2	C1	C2	D1	D2	D4	D3	F1	F2	F3	T1	T2	T3	T4	
SAE 1 1/4" & SAE 1 1/2"				BSP 1/4"				BSP 1"	BSP 1/4"	BSP 1/2"		BSP 1/4"			

HCB840系列/HCB840 Series

HCB840 外形及安装尺寸/ HCB840 Installation Dimensions

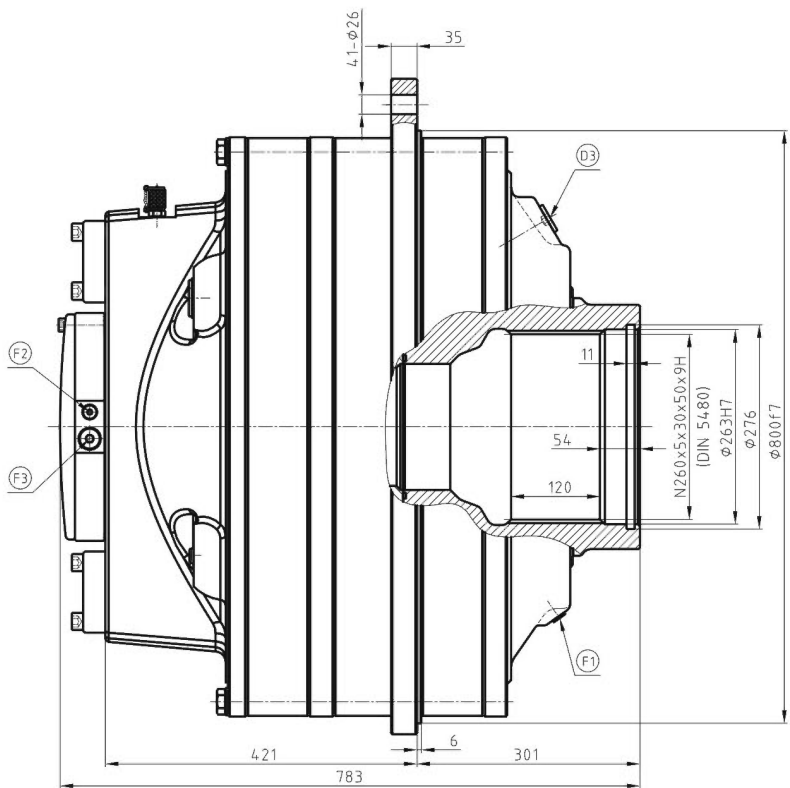

液压原理图/Hydraulic Schematic

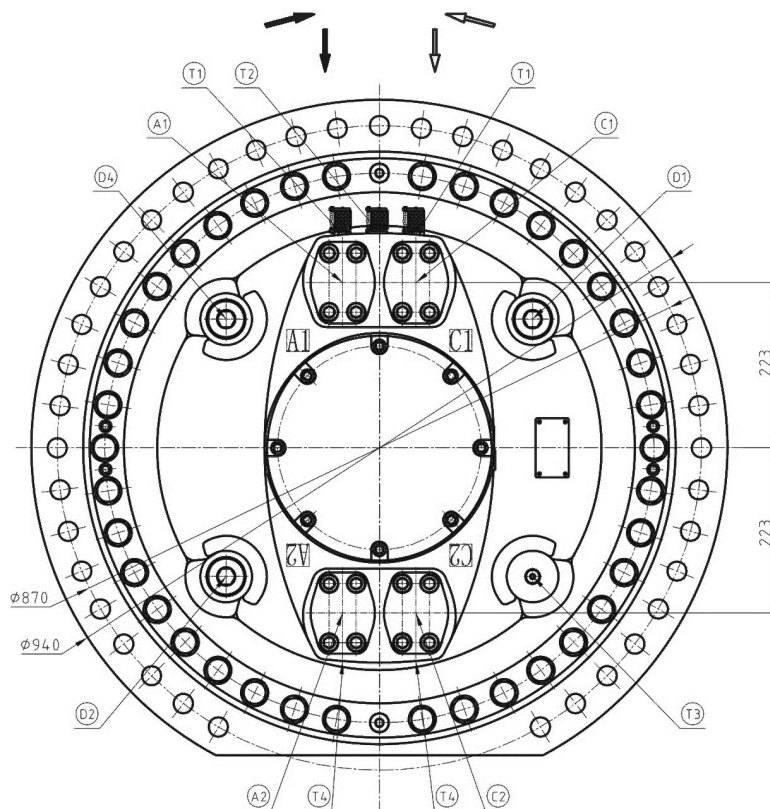
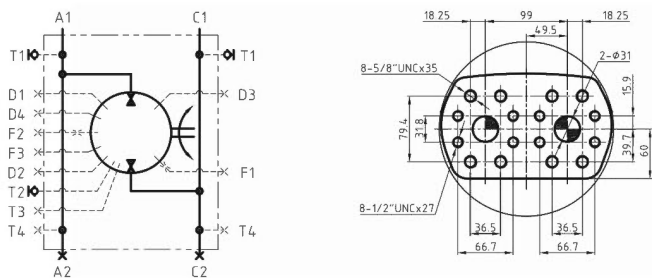

油口尺寸/Connection

主油口A Main Conn.A		主油口C Main Conn.C		泄油口 Drain Conn.			冲洗油口 Flushing Conn.			测压口 Test Conn.				
A1	A2	C1	C2	D1	D2	D4	D3	F1	F2	F3	T1	T2	T3	T4
SAE 1 1/4"&SAE 1 1/2"		SAE 1 1/4"&SAE 1 1/2"		BSP1 1/4"			BSP 1"	BSP1/4"	BSP1/2"	F3	BSP1/4"			

HCB840系列/HCB840 Series

HCB840 外形及安装尺寸/HCB840 Installation Dimensions

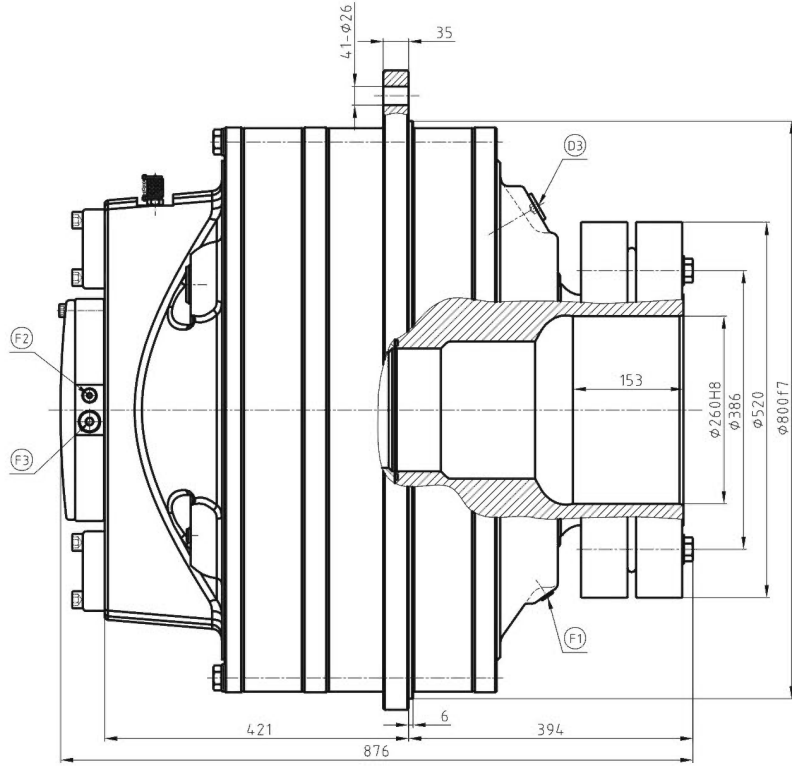

液压原理图/Hydraulic Schematic

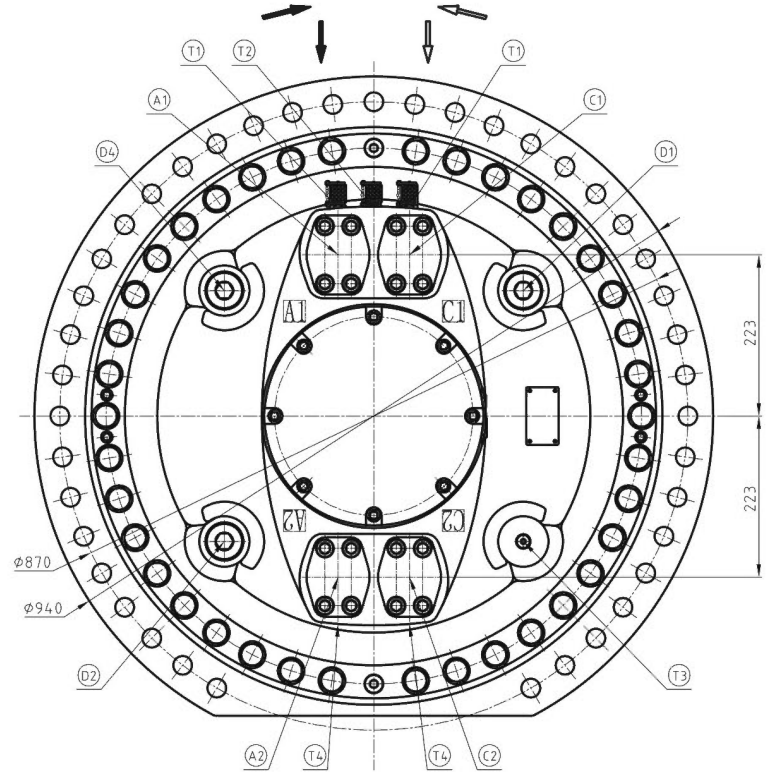
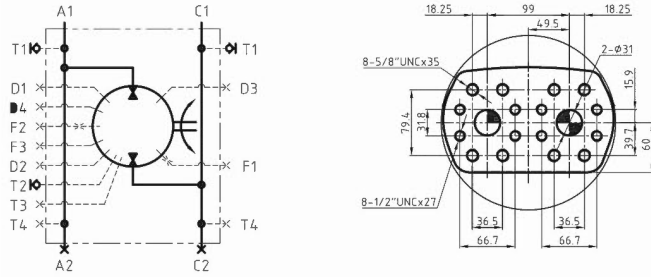

油口尺寸/Connection

主油口A Main Conn.A		主油口C Main Conn.C		泄油口 Drain Conn.			冲洗油口 Flushing Conn.			测压口 Test Conn.				
A1	A2	C1	C2	D1	D2	D4	D3	F1	F2	F3	T1	T2	T3	T4
SAE 1 1/4"&SAE 1 1/2"				BSP 1/4"			BSP 1"	BSP 1/4"	BSP 1/2"		BSP 1/4"		BSP 1/2"	