

MH3245 SMARTSTROBE 3245



CE F IP20 $t_a 40^{\circ}\text{C}$ $t_c 100^{\circ}\text{C}$

User Manual

KEEP THIS MANUAL FOR FUTURE NEEDS



ADD F1-5, Block 3, No.95, Guangzhu Rd, Lanhe Town, Nansha District, Guangzhou 511480

Tel. +86 20 8499 2310/2320/2330

Fax +86 20 8499 2360

E-mail info@color-imagination.com

Website www.color-imagination.com

**Follow
us on**



www.facebook.com/colorimagination.1



www.youtube.com/user/colorimaginationj



https://twitter.com/Color_lighting

1 SAFETY INSTRUCTIONS



CAUTION

Be careful with your operations. With a dangerous voltage you can suffer a dangerous electric shock when touching wires!

This device has left the factory in perfect condition. In order to maintain this condition and to ensure a safe operation, it is absolutely necessary for the user to follow the safety instructions and warning notes written in this user manual.



IMPORTANT

Damages caused by the disregard of this user manual are not subject to warranty. The dealer will not accept liability for any resulting defects or problems.

If the device has been exposed to temperature changes due to environmental changes, do not switch it on immediately. The arising condensation could damage the device. Leave the device switched off until it has reached room temperature.

This device falls under protection-class I. Therefore it is essential that the device be earthed.

The electric connection must carry out by qualified person.

The device shall only be used with rated voltage and frequency.

Make sure that the available voltage is not higher than stated at the end of this manual.

Make sure the power cord is never crimped or damaged by sharp edges. If this would be the case, replacement of the cable must be done by an authorized dealer.

Always disconnect from the mains, when the device is not in use or before cleaning it. Only handle the power cord by the plug. Never pull out the plug by tugging the power cord.

During initial start-up some smoke or smell may arise. This is a normal process and does not necessarily mean that the device is defective, it should decrease gradually.

Please don't project the beam onto combustible substances.

Fixtures cannot be installed on combustible substances, keep more than 50cm distance with wall for smooth air flow, so there should be no shelter for fans and ventilation for heat radiation.

If the external flexible cable or cord of this luminaire is damaged, it shall be exclusively replaced by the manufacturer or his service agent or a similar qualified person in order to avoid a hazard.

8 MAINTENANCE AND CLEANING

The following points have to be considered during the inspection:

- 1) All screws for installing the devices or parts of the device have to be tightly connected and must not be corroded.
- 2) There must not be any deformations on the housing, color lenses, fixations and installation spots (ceiling, suspension, trussing).
- 3) Mechanically moved parts must not show any traces of wearing and must not rotate with unbalances.
- 4) The electric power supply cables must not show any damage, material fatigue or sediments.

Further instructions depending on the installation spot and usage have to be adhered by a skilled installer and any safety problems have to be removed.



CAUTION

Disconnect from mains before starting maintenance operation.



In order to make the lights in good condition and extend the life time, we suggest a regular cleaning to the lights.

- 1) Clean the inside and outside lens each week to avoid the weakness of the lights due to accumulation of dust.
- 2) Clean the fan each week.
- 3) A detailed electric check by approved electrical engineer each three month, make sure that the circuit contacts are in good condition, prevent the poor contact of circuit from overheating.

We recommend a frequent cleaning of the device. Please use a moist, lint-free cloth. Never use alcohol or solvents.

There are no serviceable parts inside the device. Please refer to the instructions under "Installation instructions".

Should you need any spare parts, please order genuine parts from your local dealer.

2 UNPACKING

The NO-FAN designed SMARTSTROBE 3245 is an ultra compact and light weight stylish moving head wash/strobe light featuring 324*0.5W 5730 WW+CW LEDs which is designed with 9 individual rings. It's available for 2500K-4600K color temperature adjustment. The fixture could be used not just only as a wash light (specially moving face light) but also as a remarkable moving strobe light.

It provides 360° continuous fast and smooth PAN/TILT movement with variable speed which delivers even more vivid visual effect to the show. The fixture supports DMX, RDM (Remote Device Management).

It features excellent color mixing, quiet running and flicker free control. The fixture is built in with different internal dynamic effect with variable speed. The moving head also features optimum optic design integrated with extremely effective aluminum heat sink system.

The fixture's exterior housing is beautifully balanced basing on a modern design philosophy with supremely harmonious interior structure for remarkable control. The sculpted body of the SMARTSTROBE 3245 achieves more than just a striking look. The 2*1/4 turn fastening omega clamps, available for vertical and horizontal plug-in, make installations fast and easy.

The SMARTSTROBE 3245 is designed for applications as concerts, TV studios, banquet halls, bars, pubs, DJ entertainment, ballrooms, etc.

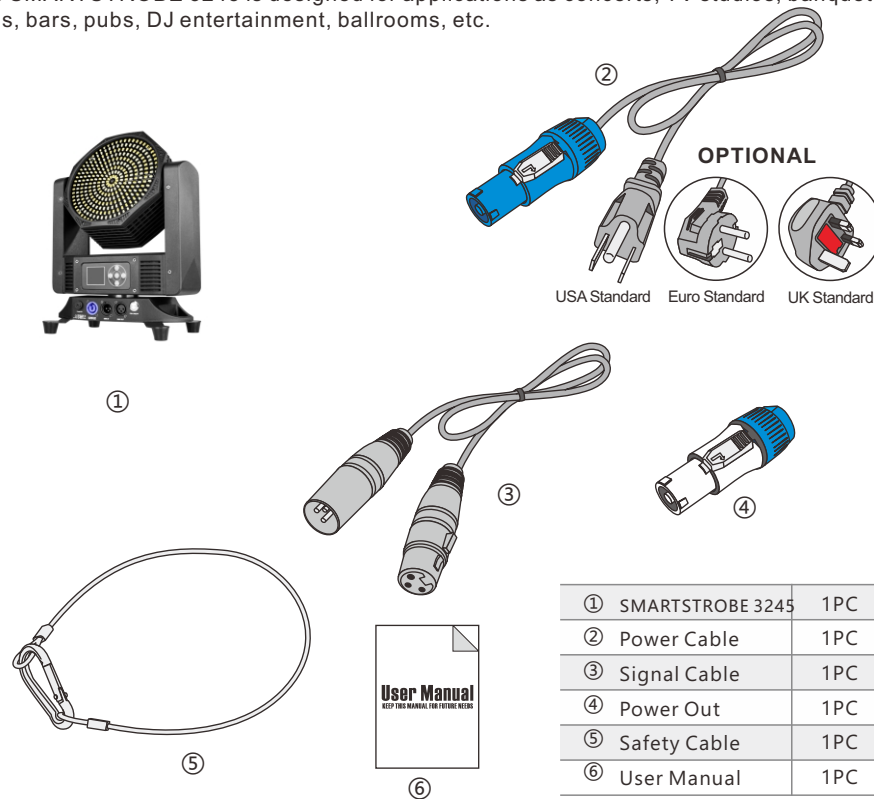

3 FEATURES & SPECIFICATIONS

324*0.5W 5730 LEDs (WW+CW)

9 Individual control rings

Flicker free operation for broadcast TV and FILM

120°Field angle

High output

PAN: 2 modes

1. 360°Continuous movement

2. 540°(8/16 bit)

TILT: 2 modes

1. 360°Continuous movement

2. 270°(8/16 bit)

Fast, quiet, smooth and precise 2-Phase motors

Smooth, fast and precise resolution for PAN/TILT movement with low noise operation

Scan position memory, auto reposition after unexpected movement

PAN/TILT reversible

Warm white+cold white

Smooth and pure color mixing capability

CTO, 2500K-4600K color temperature adjustment

Different built-in dynamic effect with variable speed

Different preset colors

0-25Hz LED shutter/strobe effect with variable speed

0-100% Smooth linear LED dimming

15/22 DMX channels USITT DMX-512

DMX512, master-slave, sound or auto operation

DMX recorder and edit function integrated

RDM available (Remote Device Management)

Art-NET (Optional)

Wireless receiver system built-in (Optional)

Shielded input signal protection for stable signal without interference

RJ45 etherCON IN/OUT (Optional with Art-Net)

3-Pin and 5-pin XLR DMX connectors IN/OUT

Electronic supply with active PFC

AC100-240V 50/60Hz

PowerCON connectors IN&OUT

190W Power consumption

-25°C to 45°C ambient temperature

IP20 protection rating

22CH

Channel	Function	Dmx Value	Description
1	Horizontal exercise	0 - 255	
2	Horizontal fine-tuning	0 - 255	
3	Vertical motion	0 - 255	
4	Vertical fine-tuning	0 - 255	
5	Motor speed	0 - 255	
6	Horizontal infinite rotation	0 - 255	
7	Vertical infinite rotation	0 - 255	
8	Dimming	0 - 255	
9	Strobe	0 - 3	
		4 - 103	
		104 - 107	
		108 - 207	
		208 - 212	
		213 - 225	
		226 - 238	
		239 - 251	
		252 - 255	
10	Warm White 1	0 - 255	
11	Cold White 1	0 - 255	
12	Warm White 2	0 - 255	
13	Cold White 2	0 - 255	
14	Warm White 3	0 - 255	
15	Cold White 3	0 - 255	
16	Warm White 4	0 - 255	
17	Cold White 4	0 - 255	
18	Warm White 5	0 - 255	
19	Color temperature	0 - 255	
20	Result	0 - 255	
21	Effect speed	0 - 255	
22	Reduce	0 - 255	

7 DMX CHANNELS

15CH

Channel	Function	Dmx Value	Description
1	Horizontal exercise	0 - 255	
2	Horizontal fine-tuning	0 - 255	
3	Vertical motion	0 - 255	
4	Vertical fine-tuning	0 - 255	
5	Motor speed	0 - 255	
6	Horizontal infinite rotation	0 - 255	
7	Vertical infinite rotation	0 - 255	
8	Dimming	0 - 255	
9	Strobe	0 - 3	
		4 - 103	
		104 - 107	
		108 - 207	
		208 - 212	
		213 - 225	
		226 - 238	
		239 - 251	
		252 - 255	
10	Warm white	0 - 255	
11	Cold white	0 - 255	
12	Color temperature	0 - 255	
13	Result	0 - 255	
14	Effect speed	0 - 255	
15	Reduce	0 - 255	

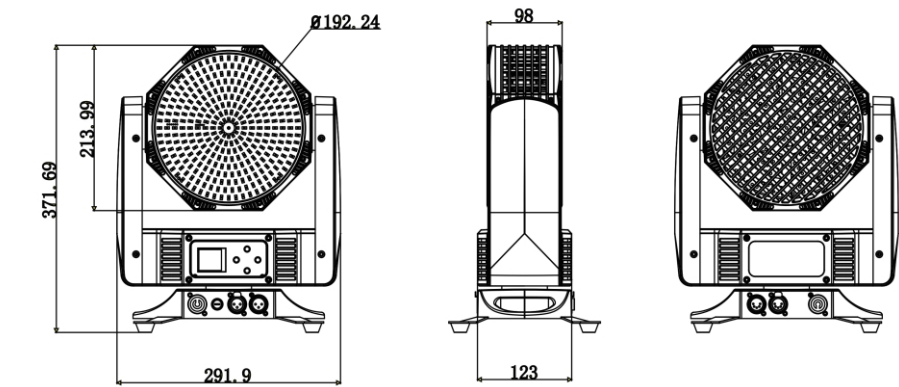

4 PHOTOMETRIC DATA

Photometric Beam Angle Data 120° Beam Angle LUX × 0.0929=FC

CW	1890/175	244/23	134/12
WW	2490/231	319/30	102/9
CW+WW	4250/395	550/51	224/21 (LUX)

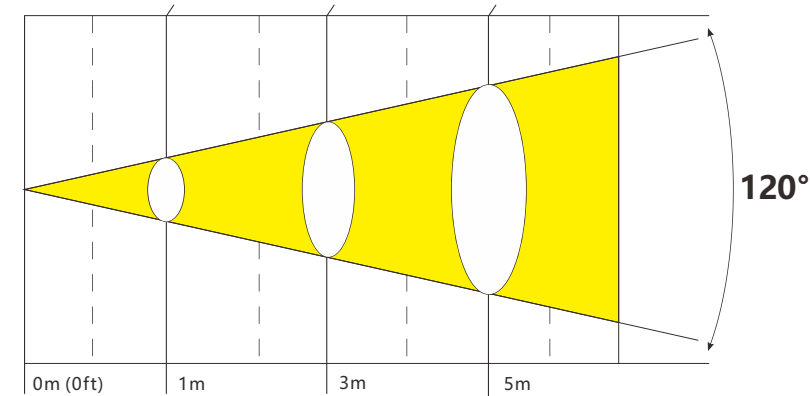

5 DMX-512 CONTROL CONNECTIONS

Connect the provided XLR cable to the female 3-pin XLR output of your controller and the other side to the male 3-pin XLR input of the architectural. You can chain multiple

Architectural together through serial linking. The cable needed should be two core, screened cable with XLR input and output connectors. Please refer to the diagram below.

DMX-512 connection with DMX terminator.

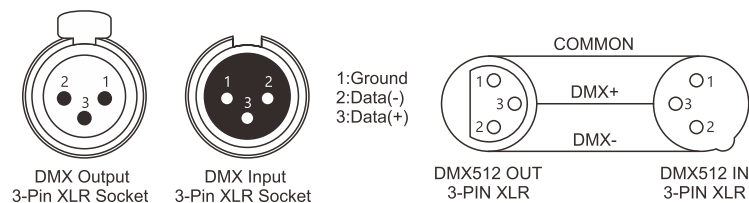

For installations where the DMX cable has to run a long distance or is in an electrically noisy environment, such as in a discotheque, it is recommended to use a DMX terminator. This helps in preventing corruption of the digital control signal by electrical noise. The DMX terminator is simply an XLR plug with a 120 Ω resistor connected between pins 2 and 3, which is then plugged into the output XLR socket of the last fixture in the chain. Please see illustrations below.

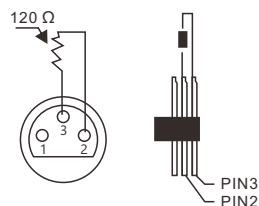

6 MENU OPERATIONS

Main Menu	Second	Third	Fourth
Dmx Address	000 - 512		
Fixture	Dmx Mode	STD / EXT	
	Run Mode	DMX / Host / Sound	
	Pan Invert	Close / Open	
	Tilt Invert	Close / Open	
	No Dmx Signal	Clear / Hold	
	Sound Control	1 -- 99	
Manual	Pan	000 - 255	
	Pan Fine	000 - 255	
	Tilt	000 - 255	
	Tilt Fine	000 - 255	
	?	?	
Information	Time	Current Time	xxxH
		Total Time	xxxH
	Sensor	All Sensor are ok!	
	Temperature	Head Temp	xxxC
	Software Version	Panel	Vx.xx
Factory	Password	000 - 255	
	Pan	000 - 255	
	Tilt	000 - 255	
Fixture Reset	Motor Reset	Cancel / Run	
	Factory	Cancel / Run	
Display	Language	CH / EN	
	Display Flip	Normal / Reverse	
	Display Mode	60s / Show	