



**EVOTECH**®  
P E R F O R M A N C E

[www.evotech-performance.com](http://www.evotech-performance.com)

BMW F 900 R / SE

Installation Instructions



## Kit Contents PRN015027

- (A) 1 x Cable Tie
- (B) 2 x Spacer
- (C) 2 x Rubber Pad
- (D) 4 x M4 x 8 Button Head Bolt
- (E) 4 x Rubber Bung

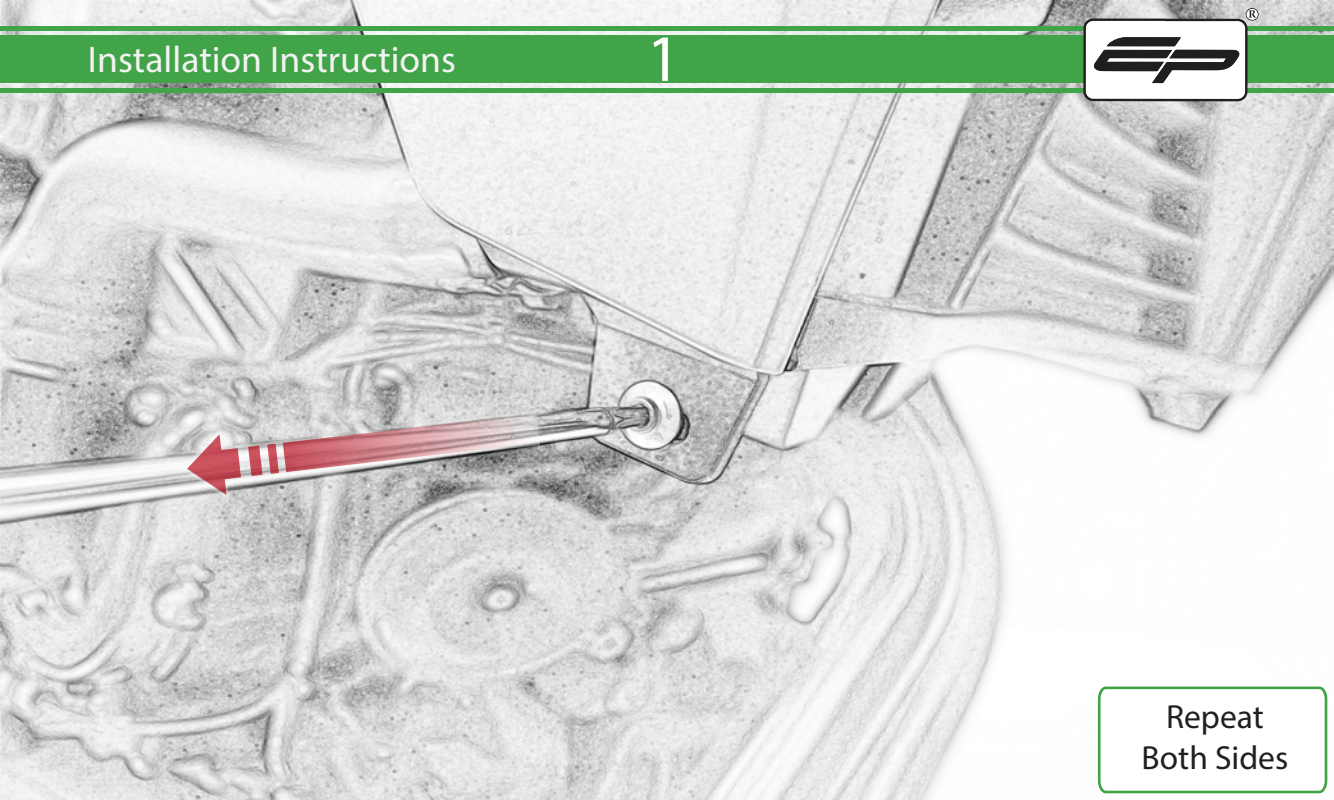

Repeat  
Both Sides

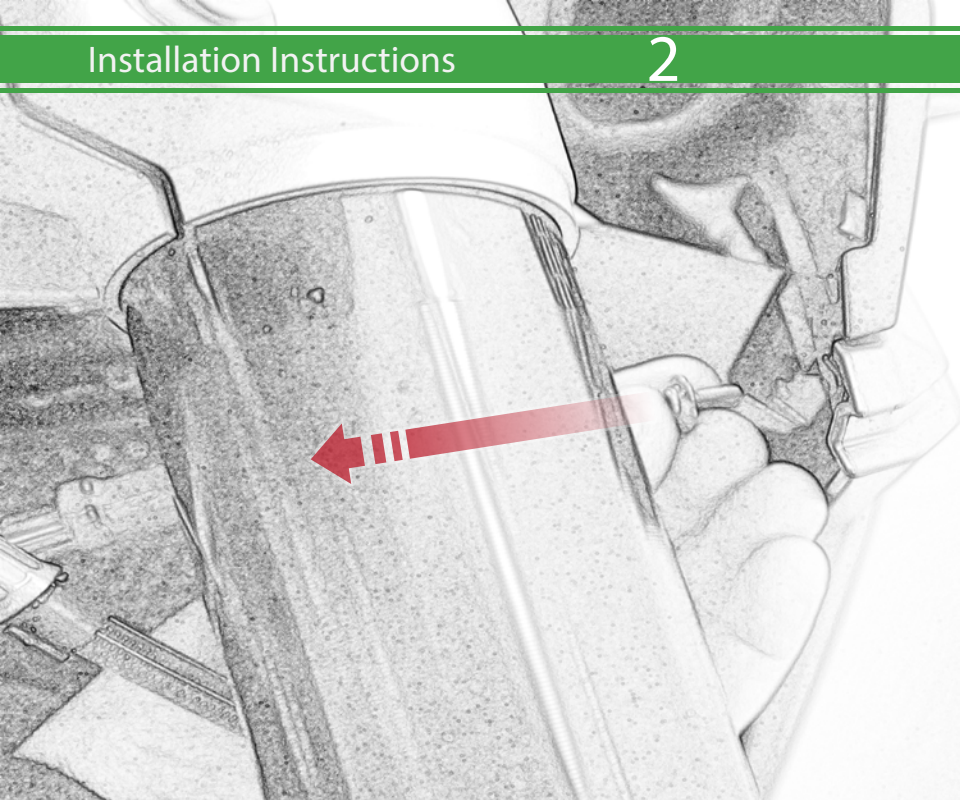

Repeat  
Both Sides



Repeat  
Both Sides

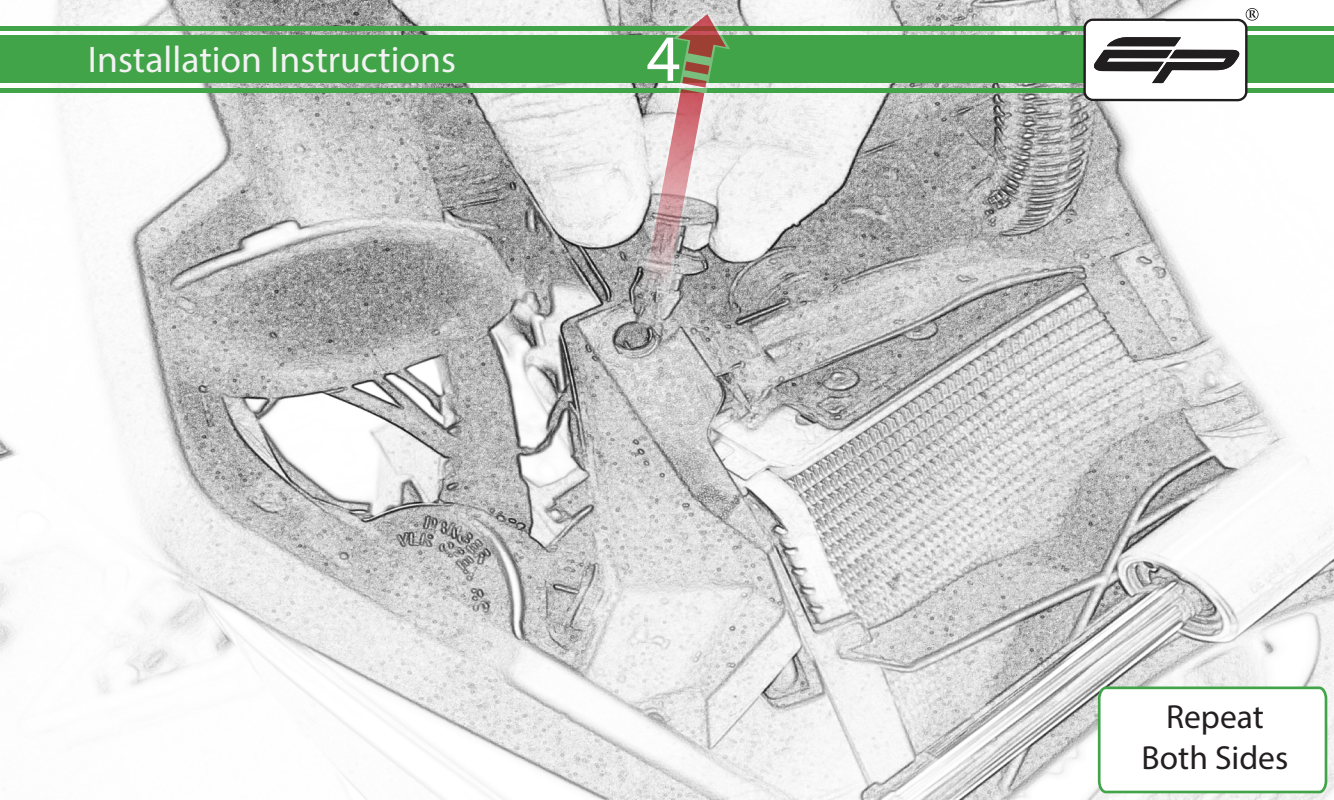

Repeat  
Both Sides

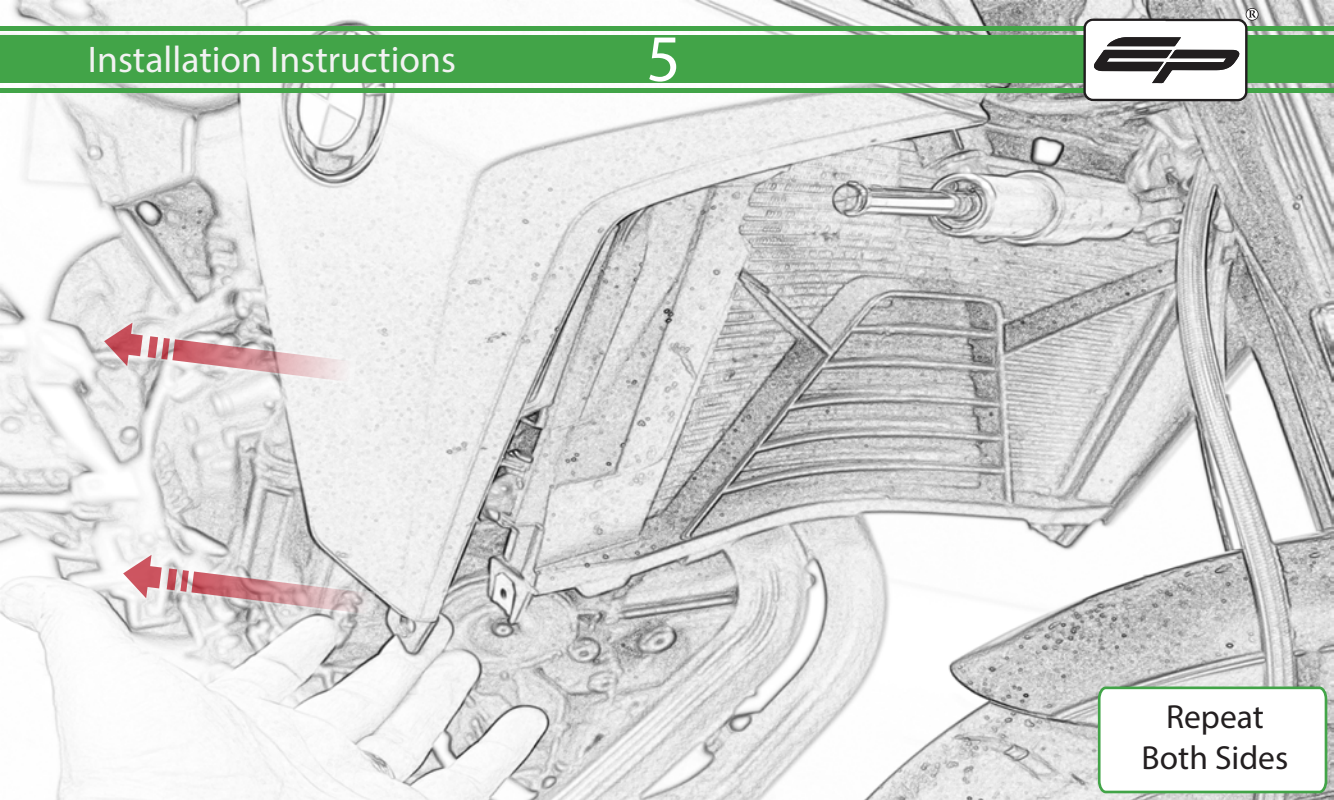

Repeat  
Both Sides



Repeat  
Both Sides



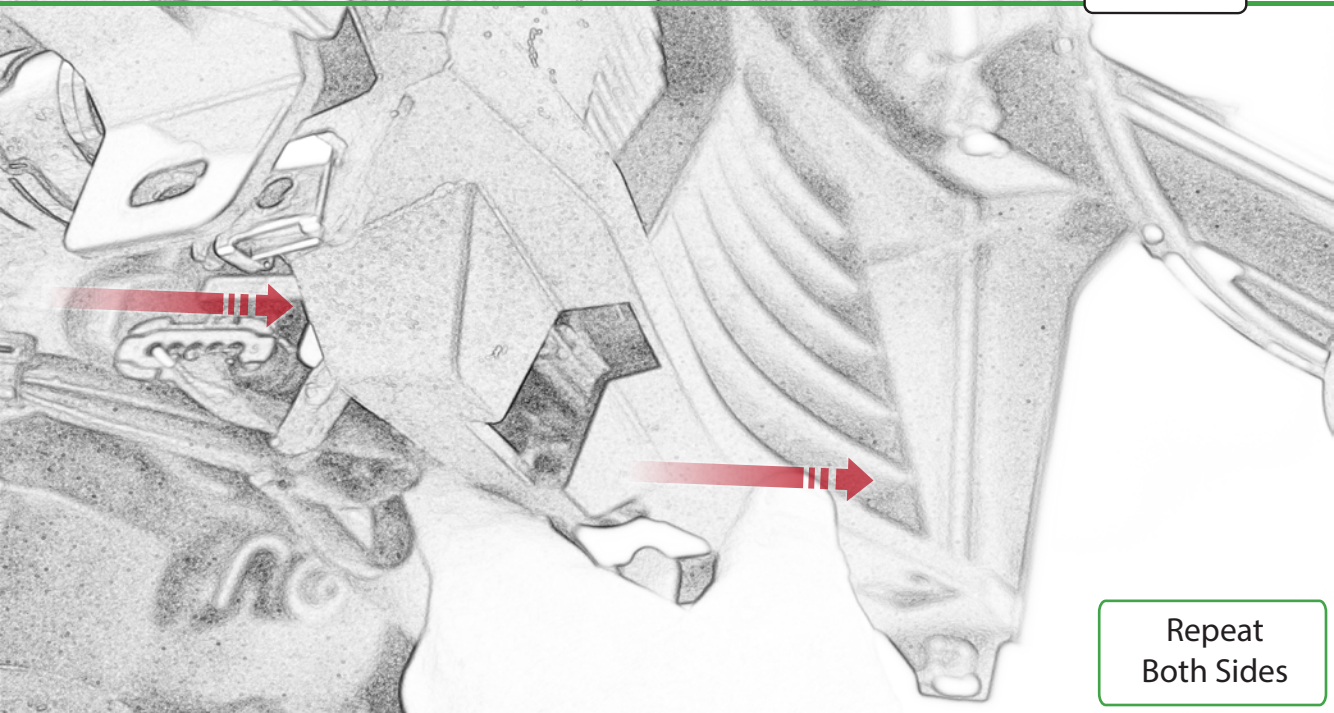

Repeat  
Both Sides

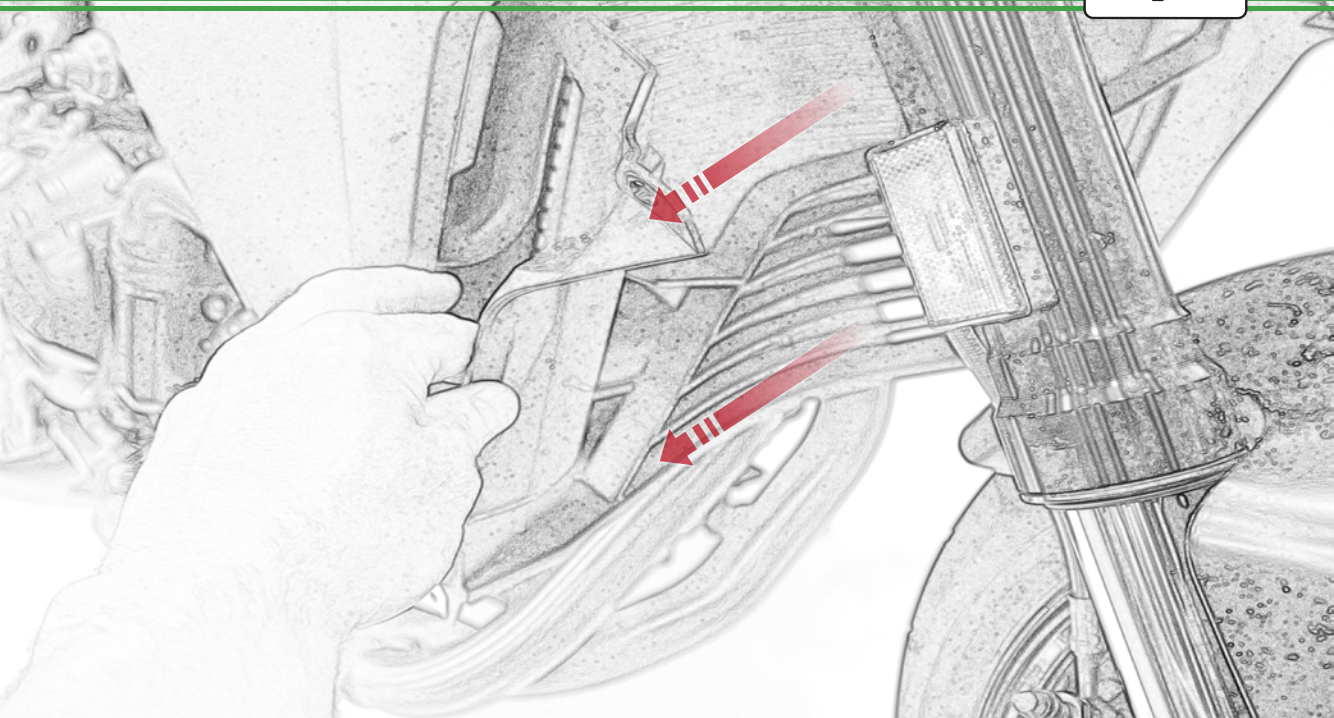

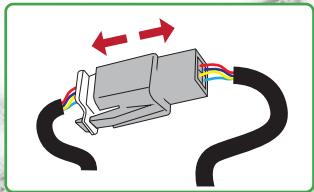
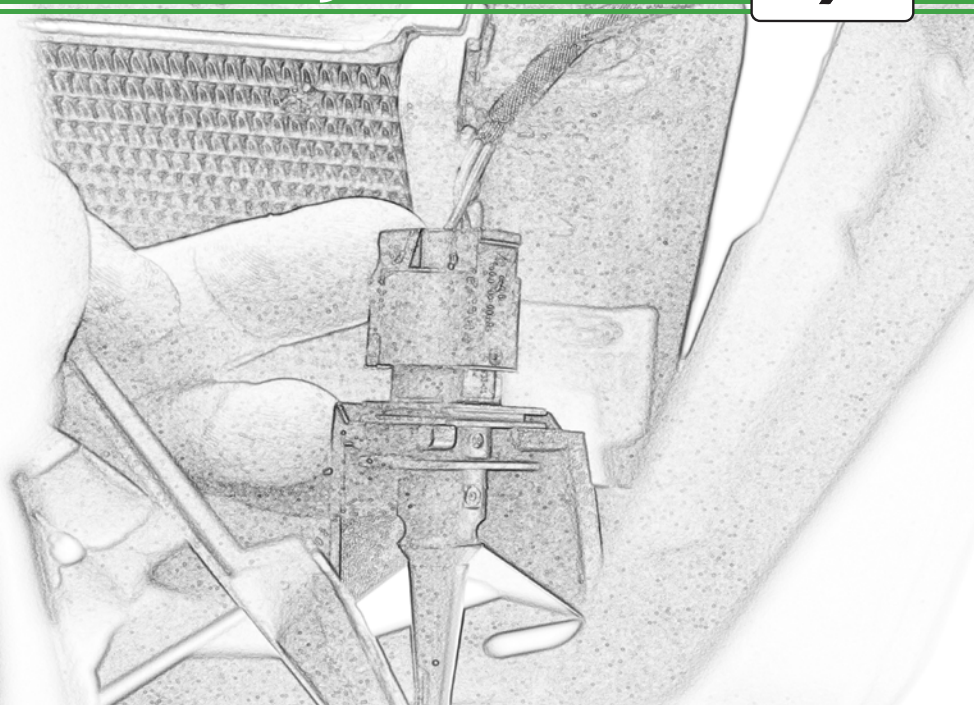

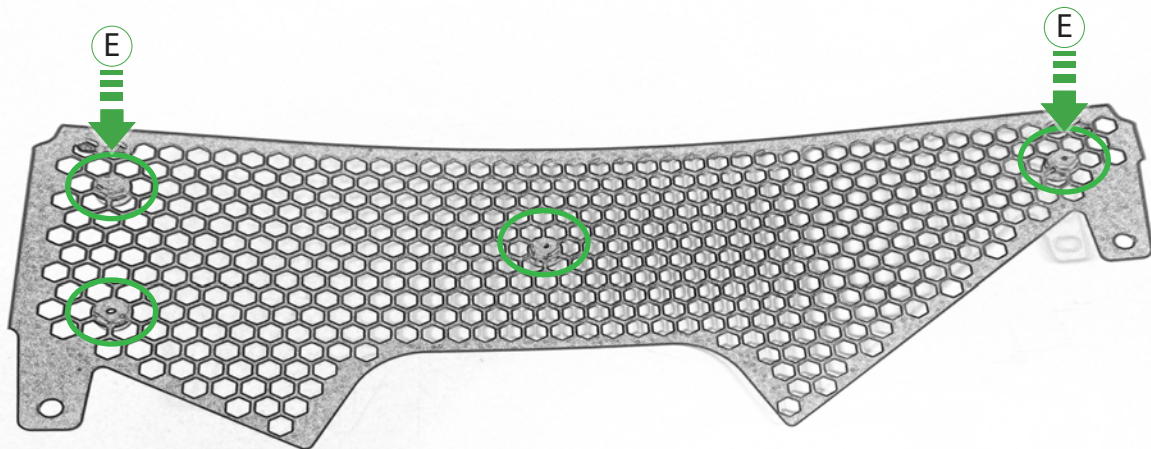

Locate round holes amongst hexagons.

Push Rubber Spacer through from the back of the guard so Hexagonal shape sits on the front face



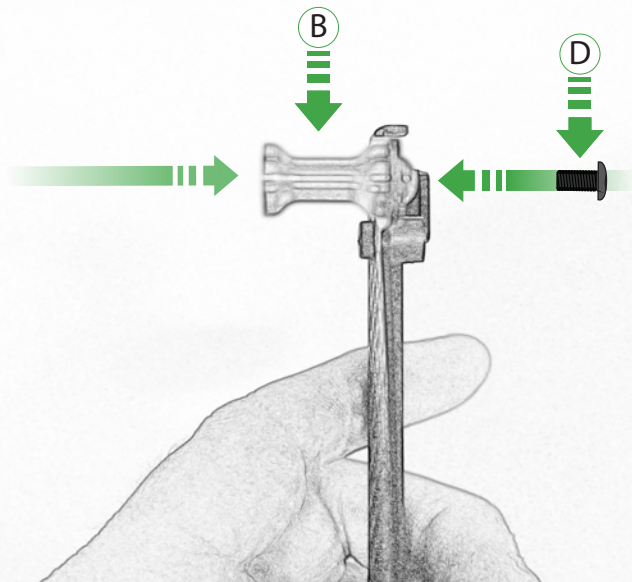

Repeat  
Both Sides

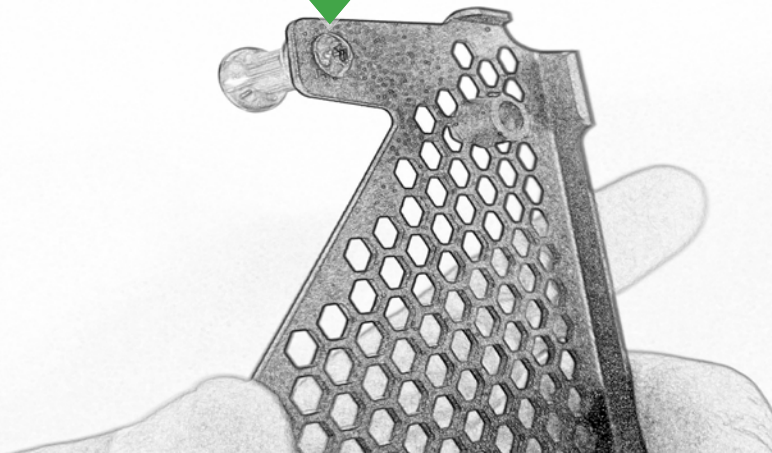

Repeat  
Both Sides

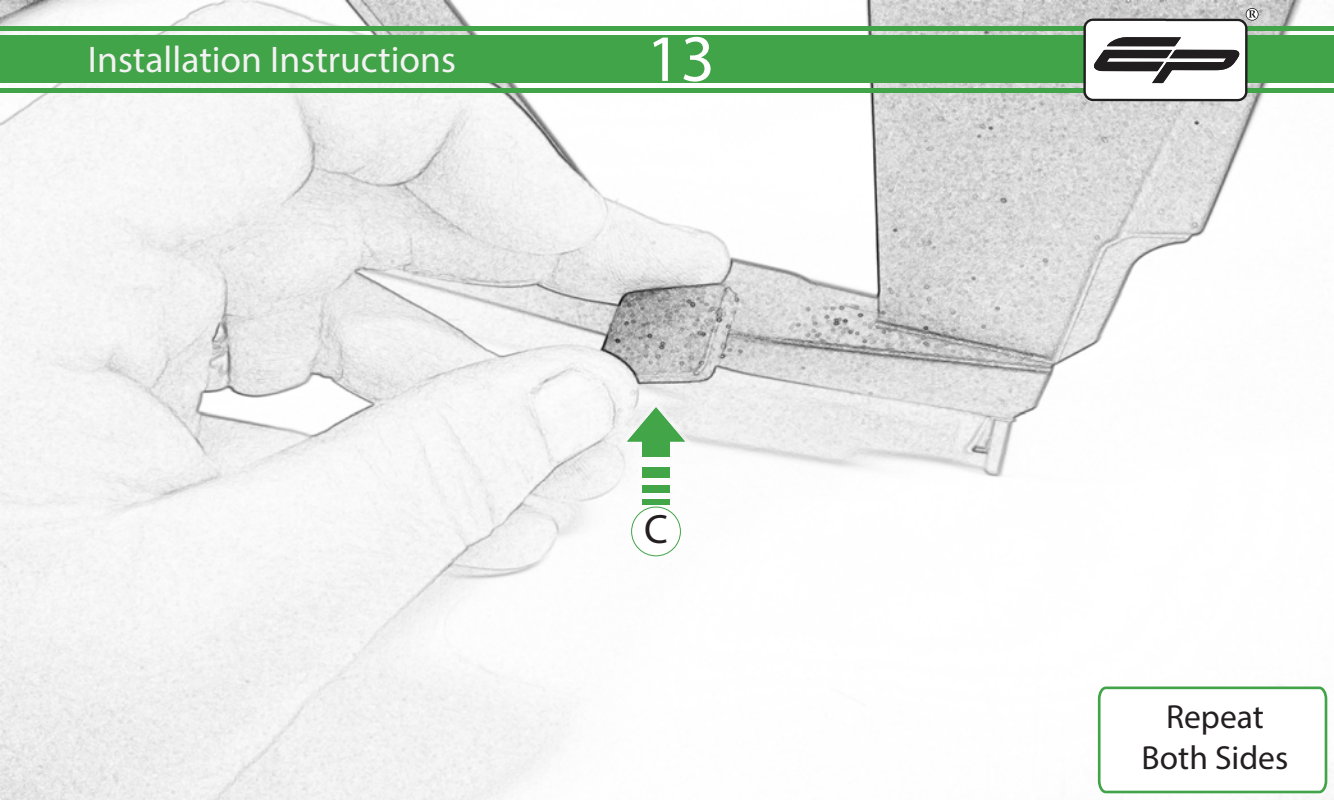

Repeat  
Both Sides

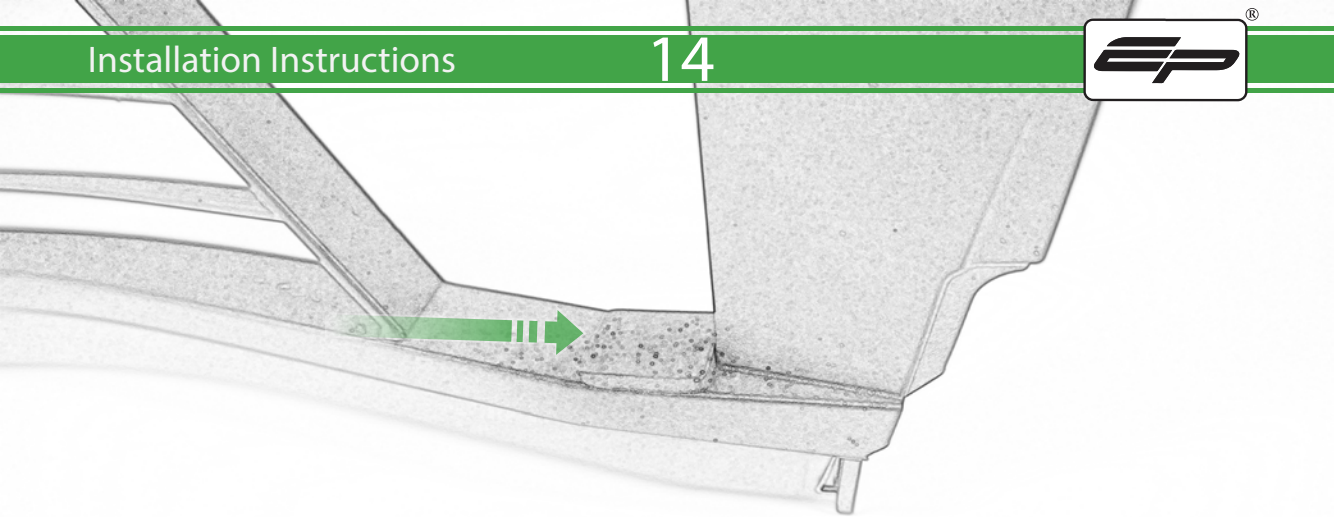

Caution

Locate Pad Next To  
Outer Edges

Repeat  
Both Sides



