

Repeat  
Both Sides

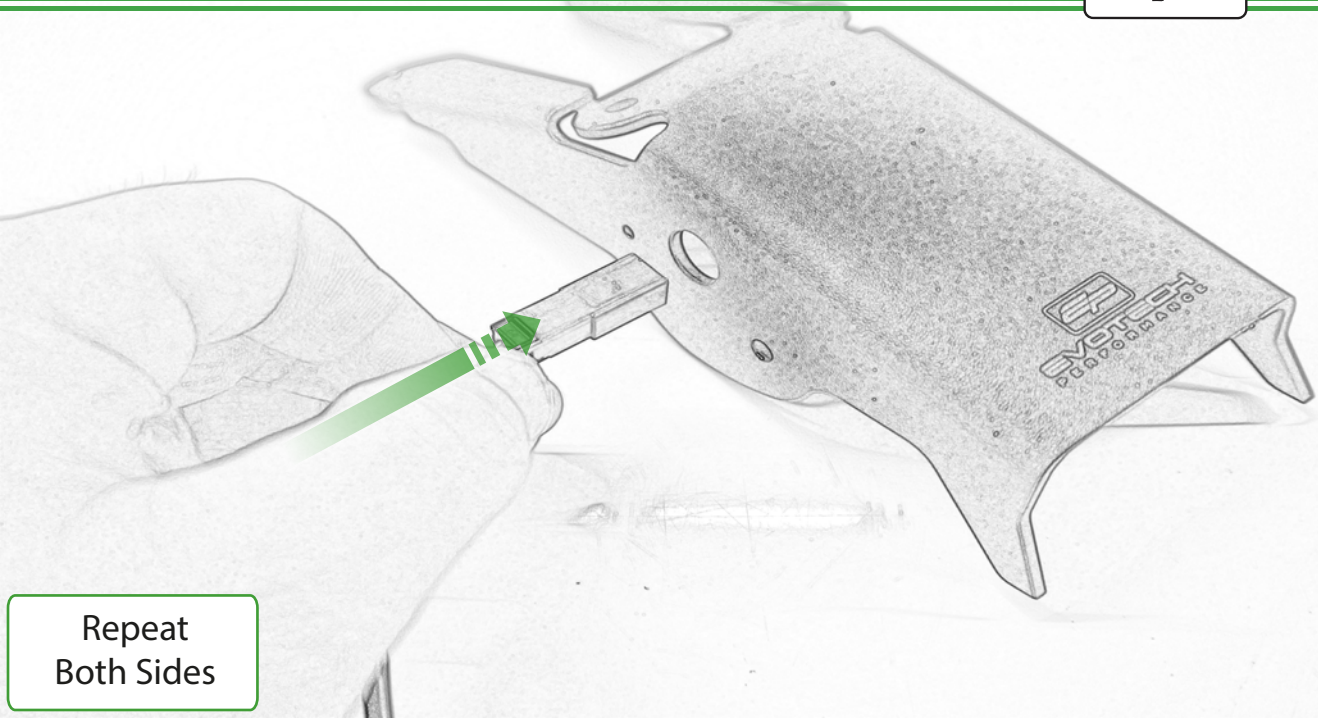

Repeat  
Both Sides

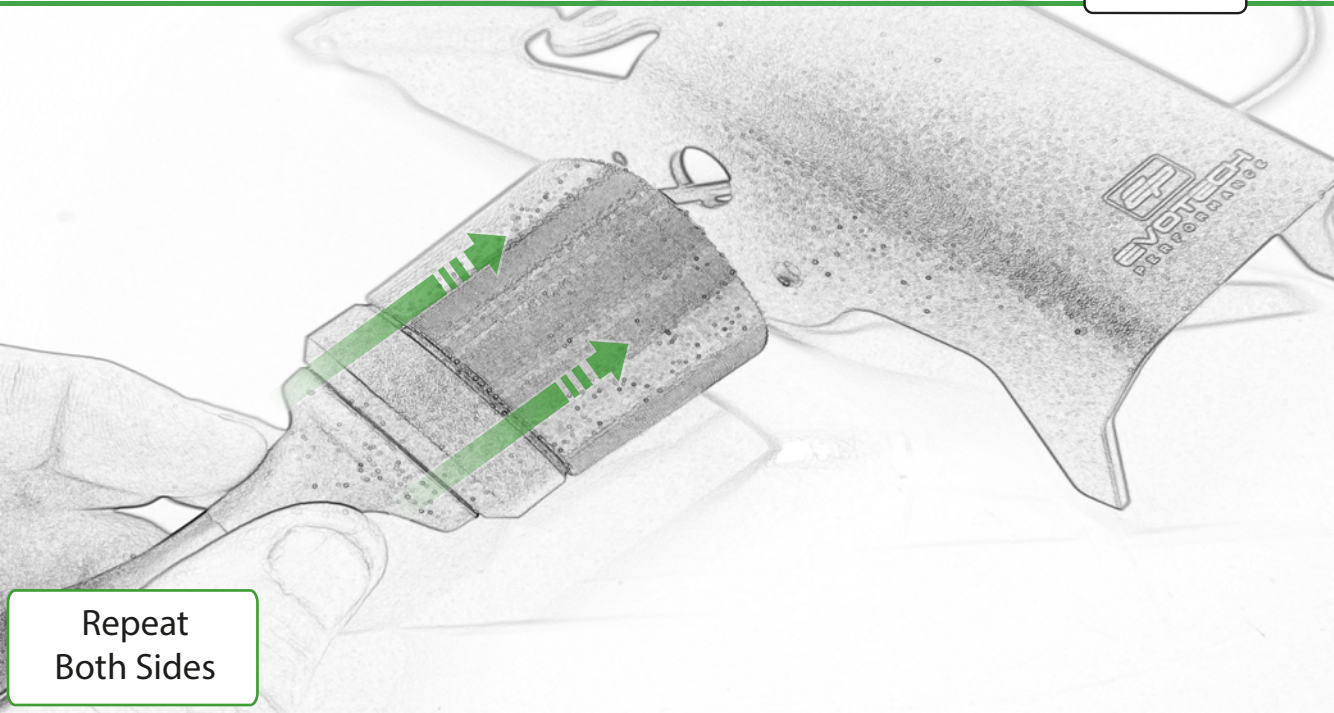

Repeat  
Both Sides

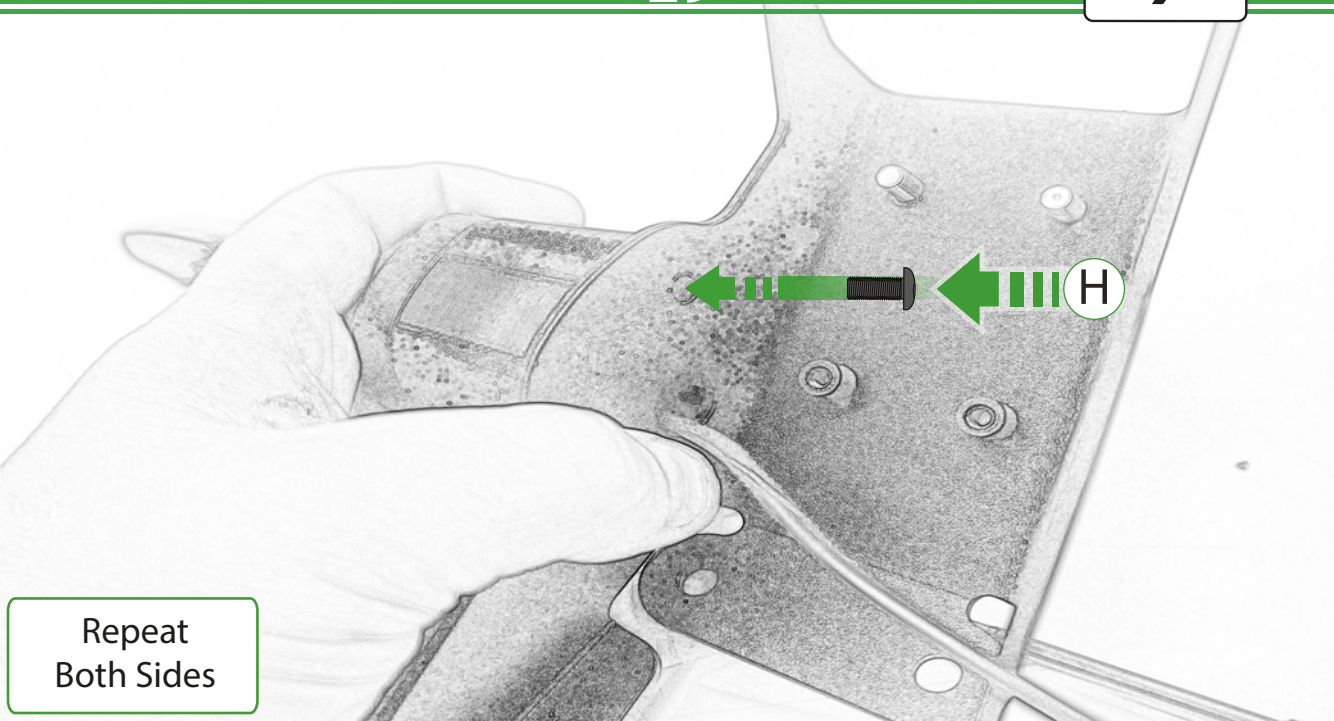

Repeat  
Both Sides

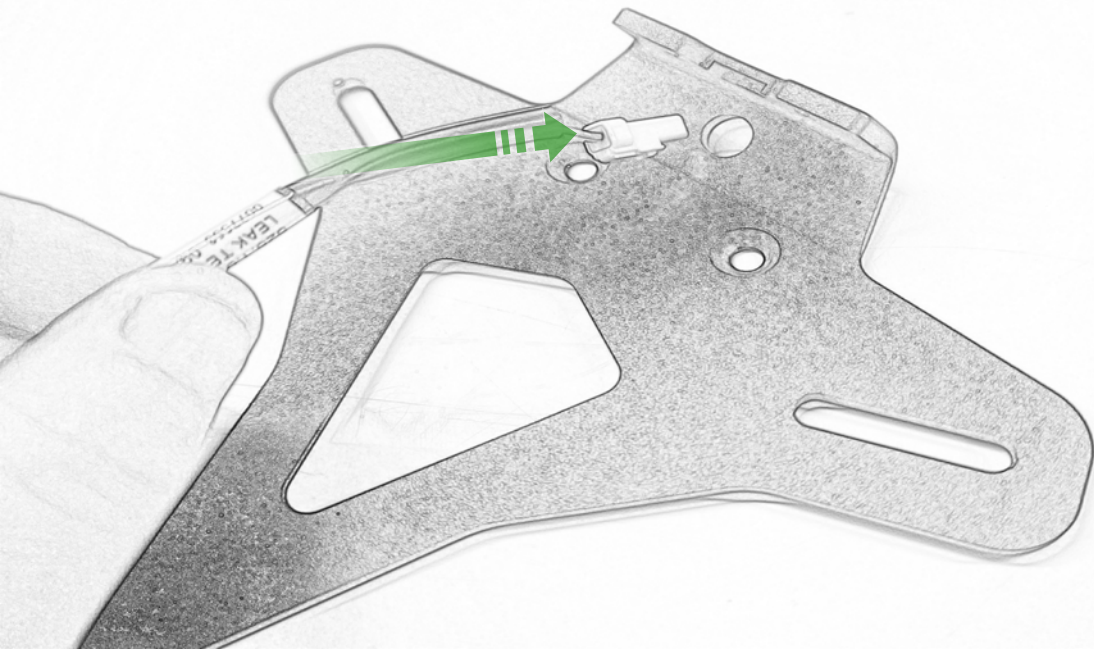

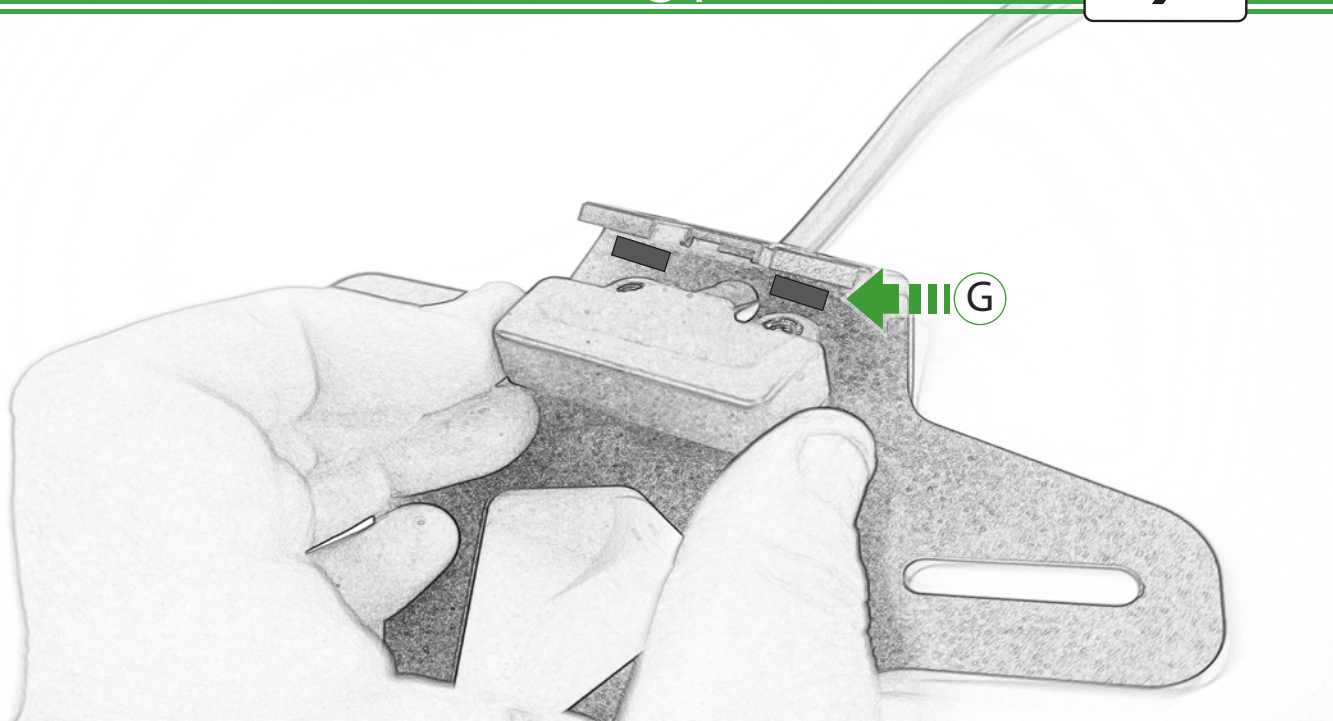



OEM PART

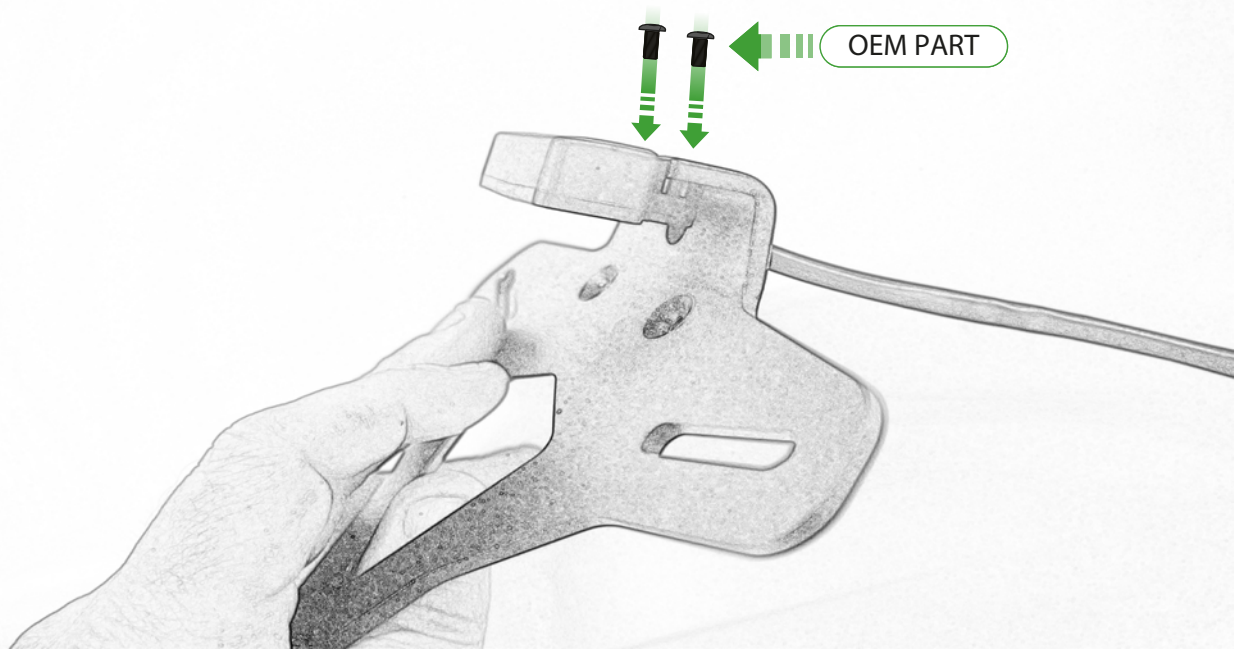

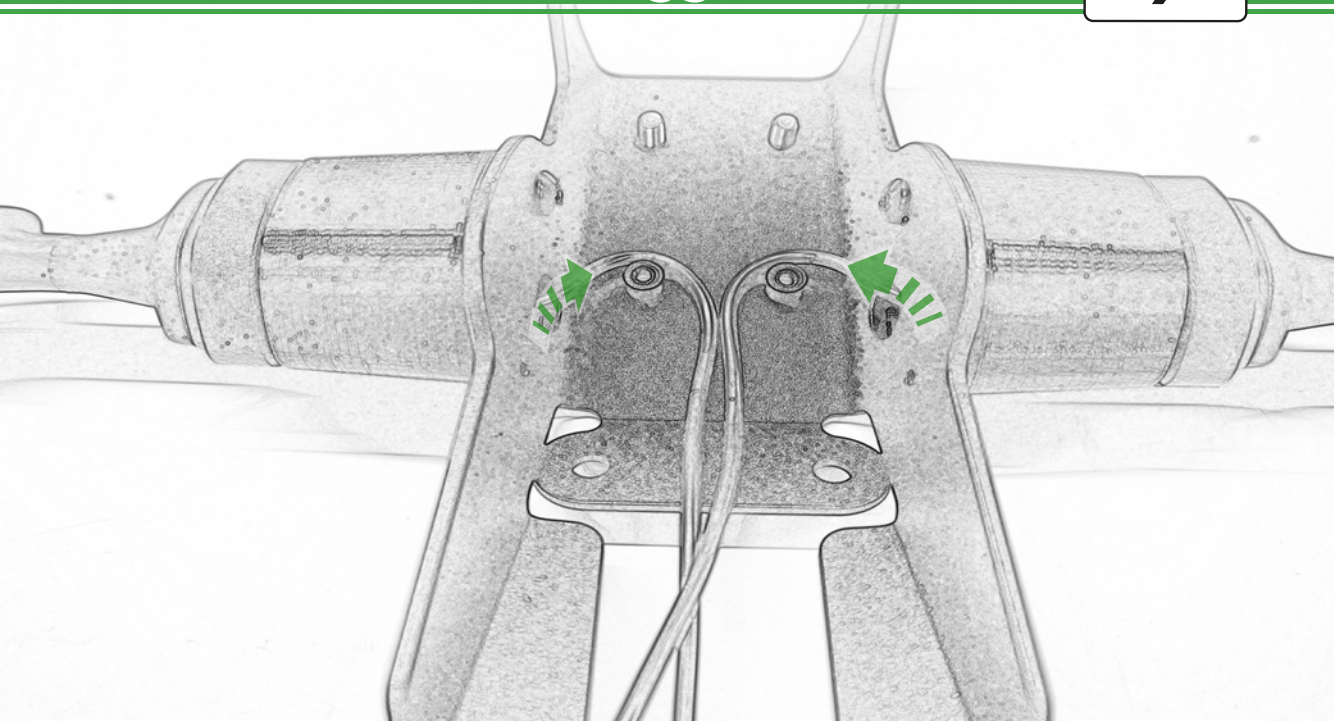



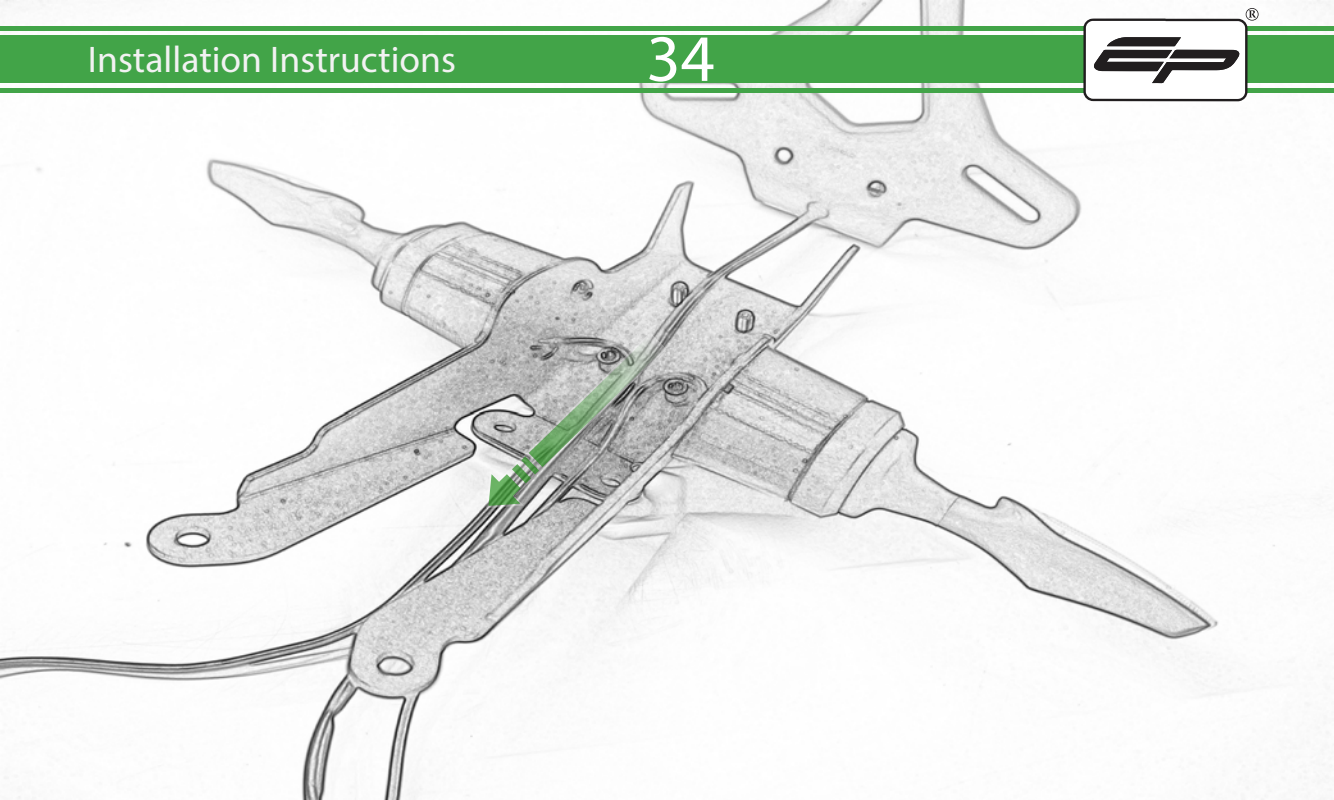

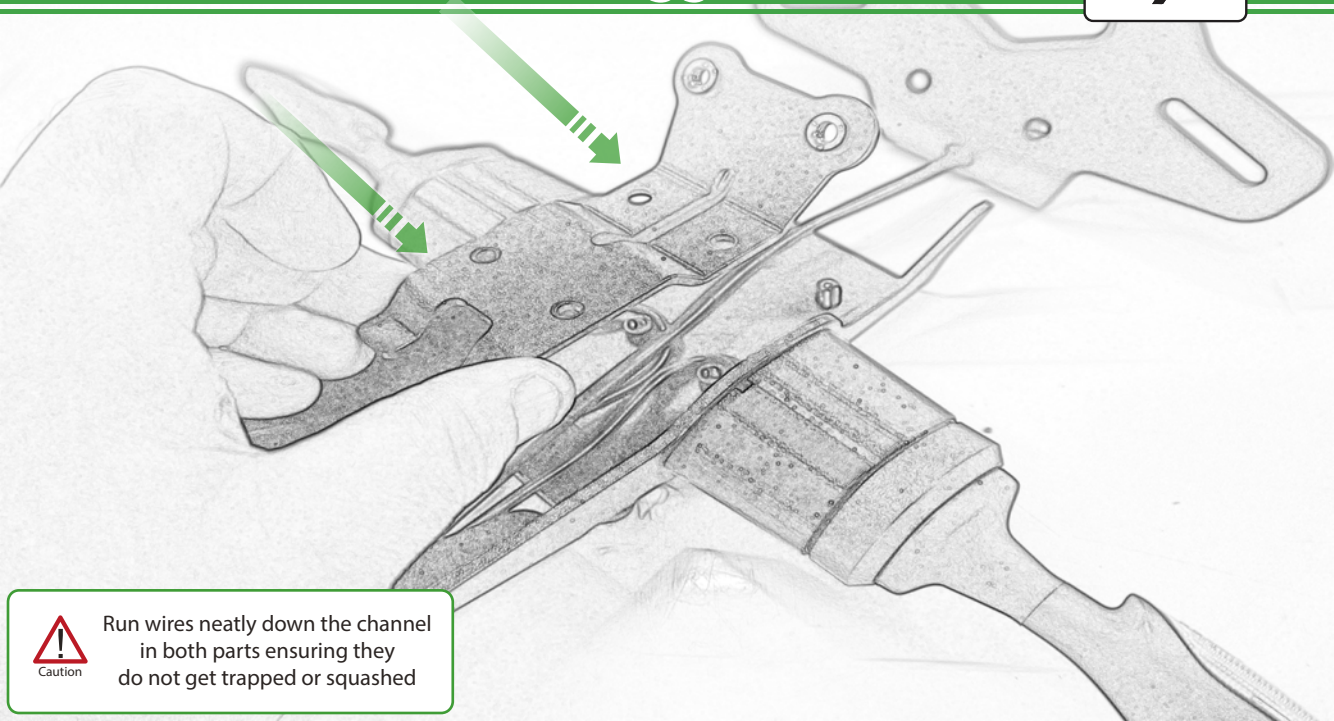

Caution

Run wires neatly down the channel in both parts ensuring they do not get trapped or squashed

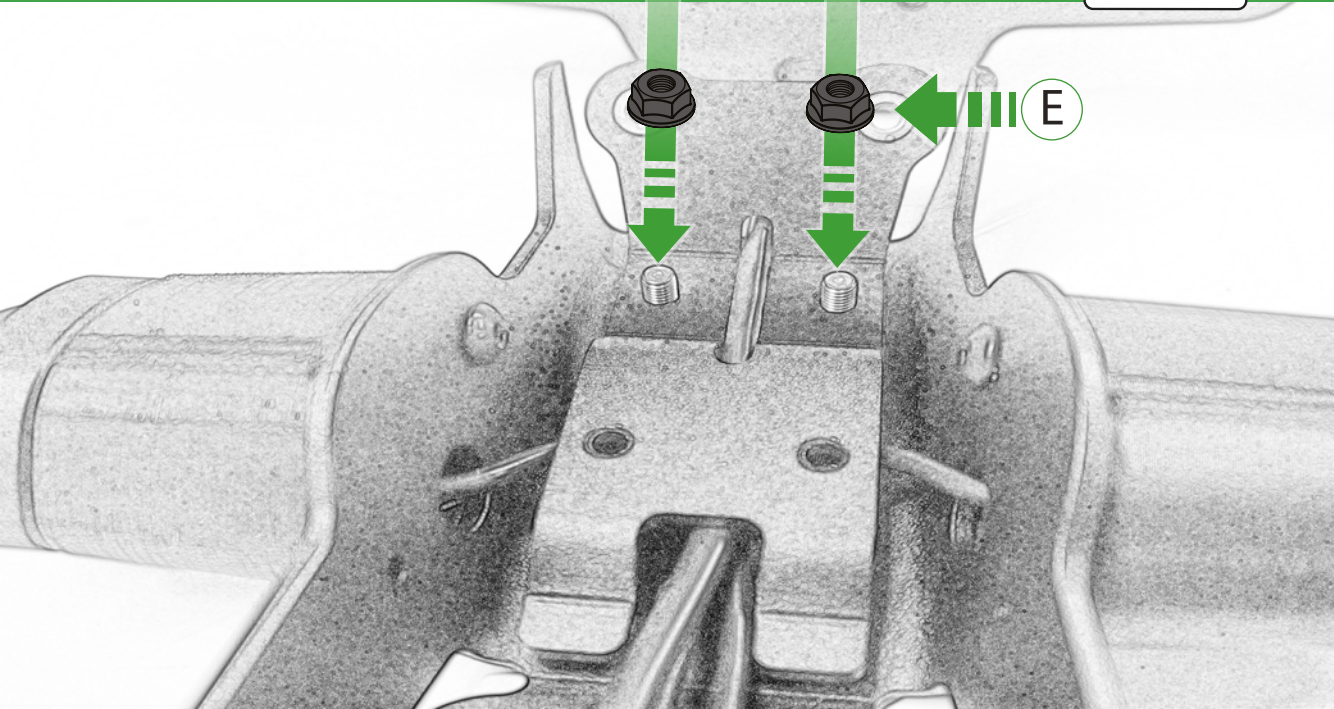

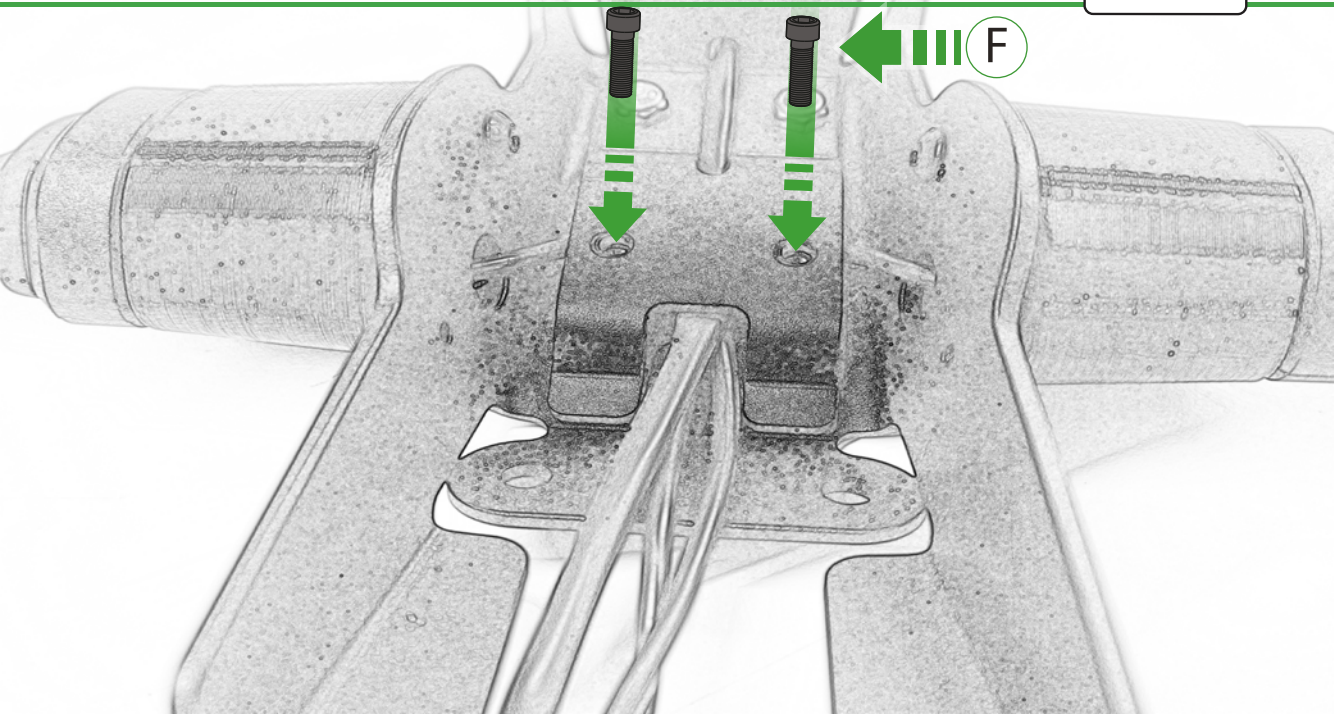

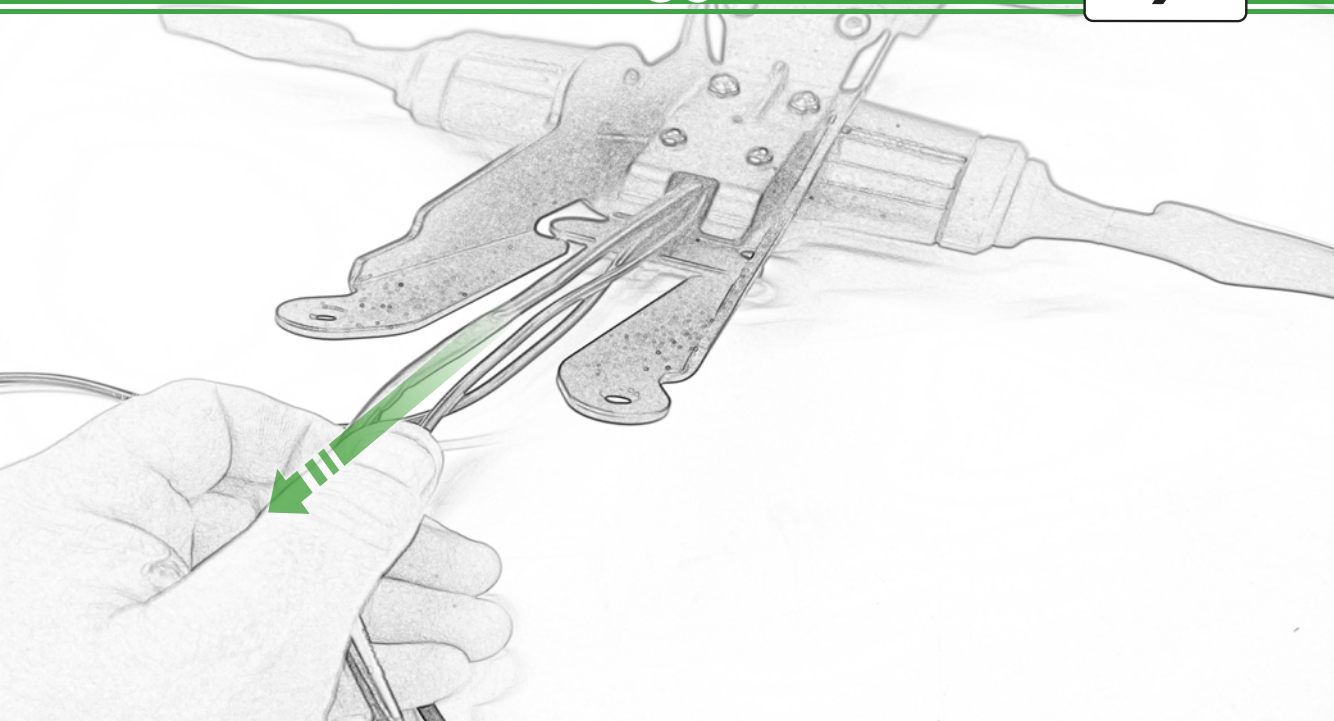

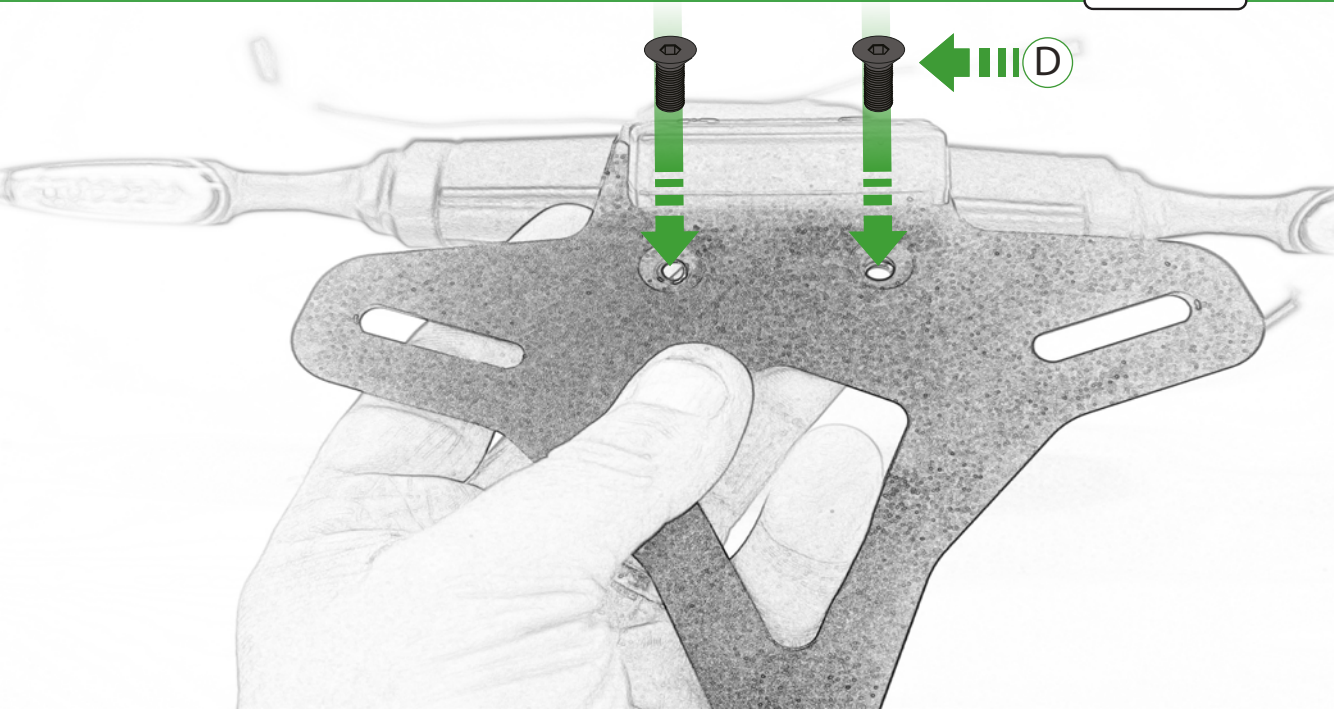

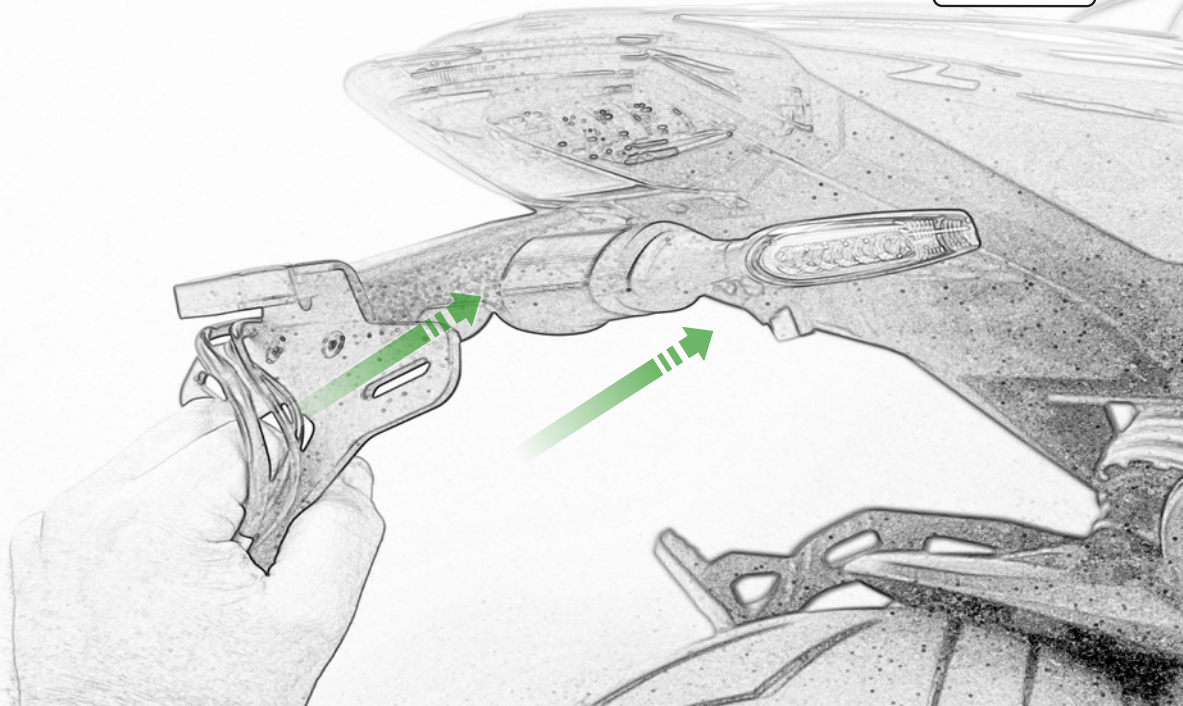

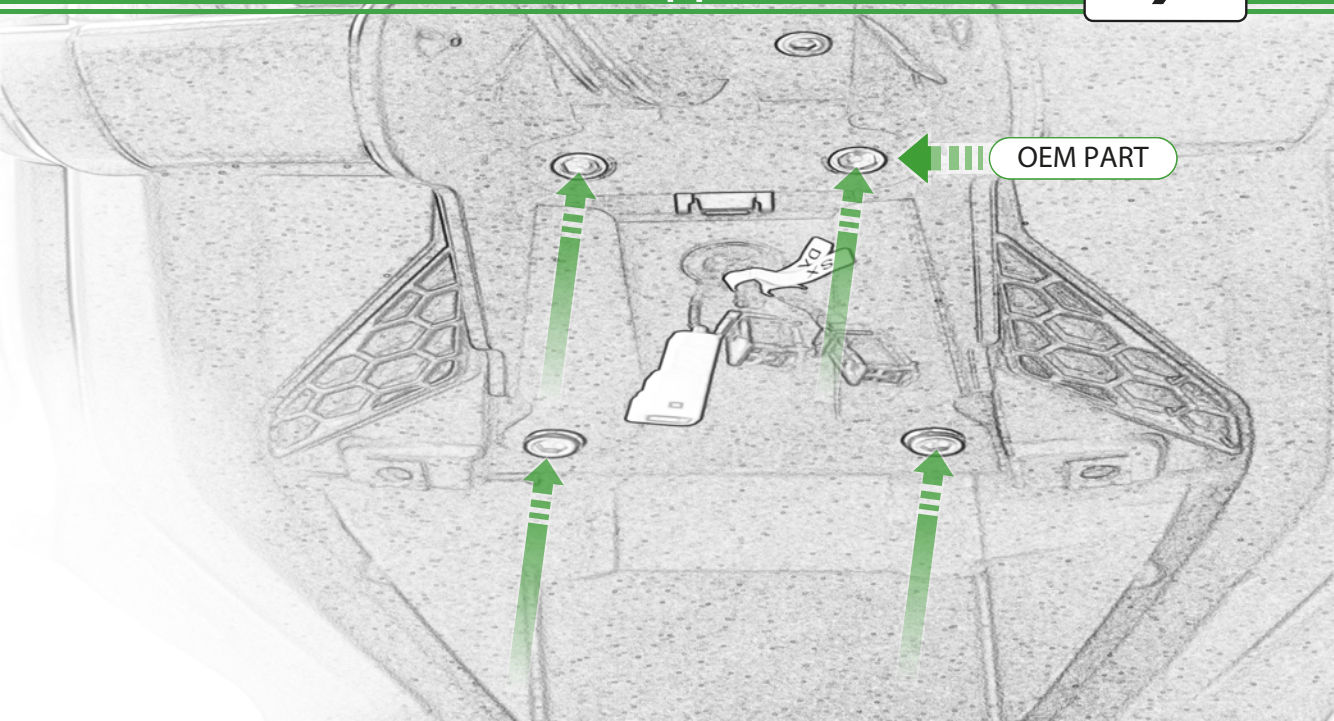

OEM PART



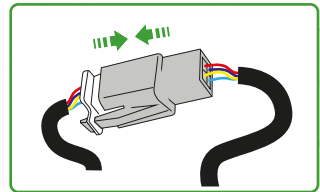
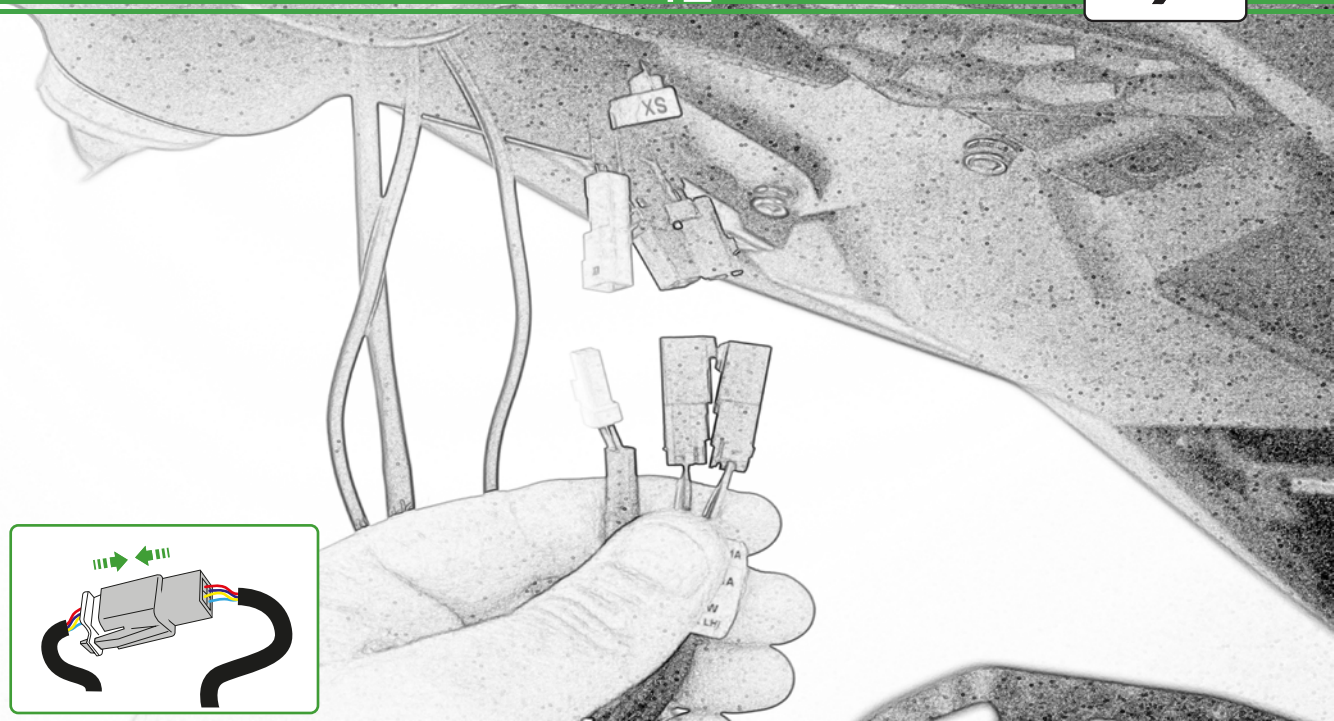

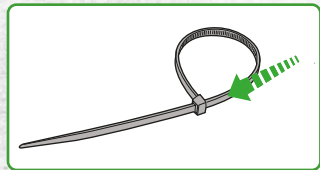
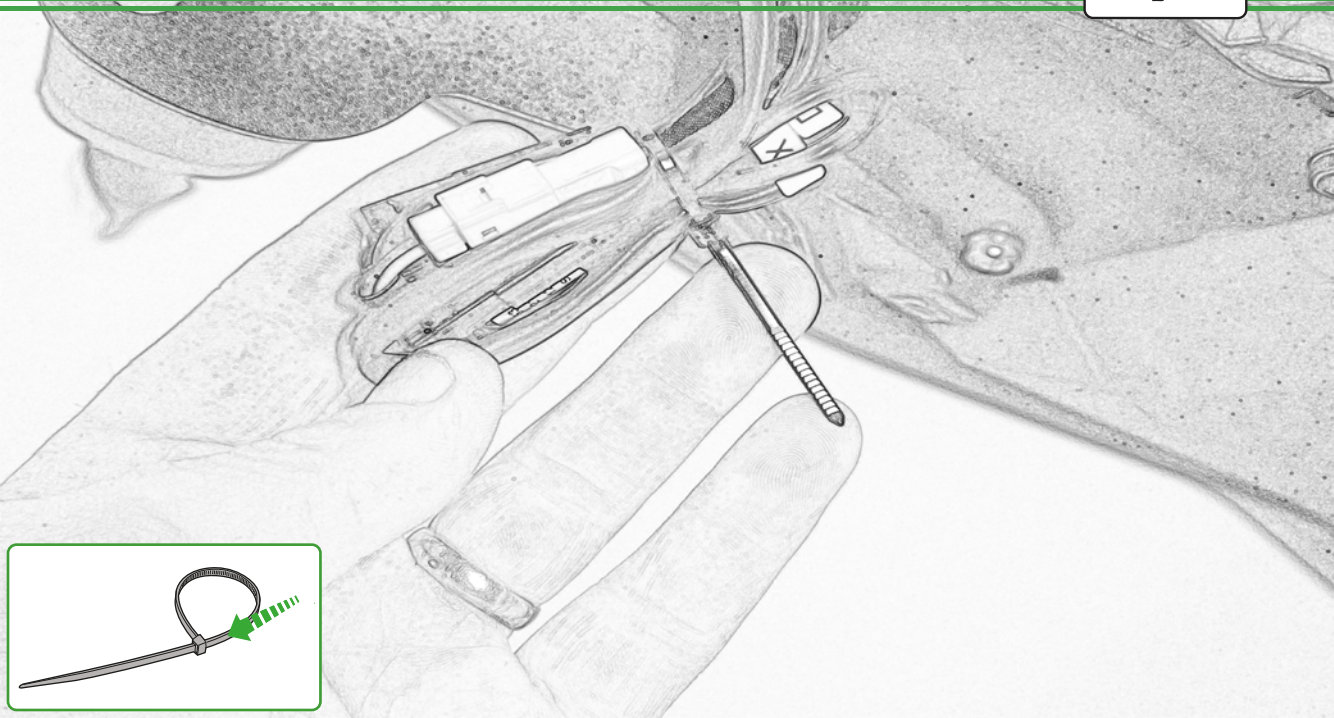

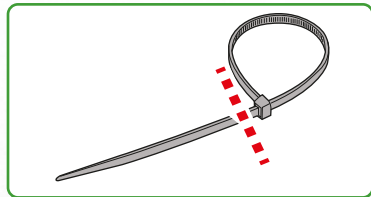

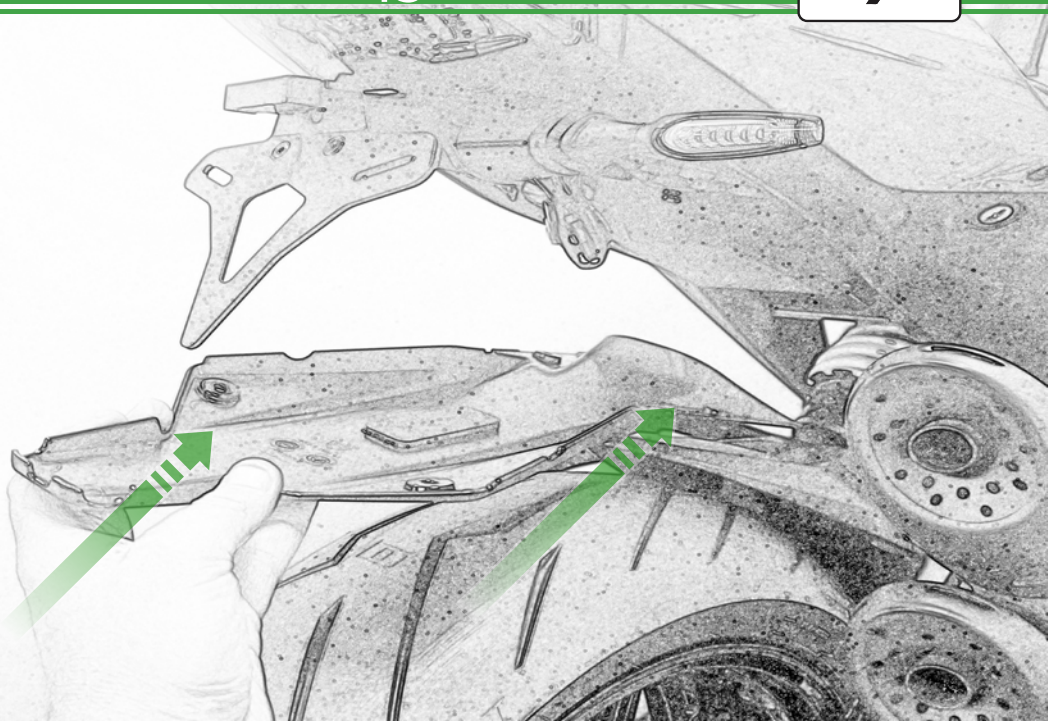



OEM PART

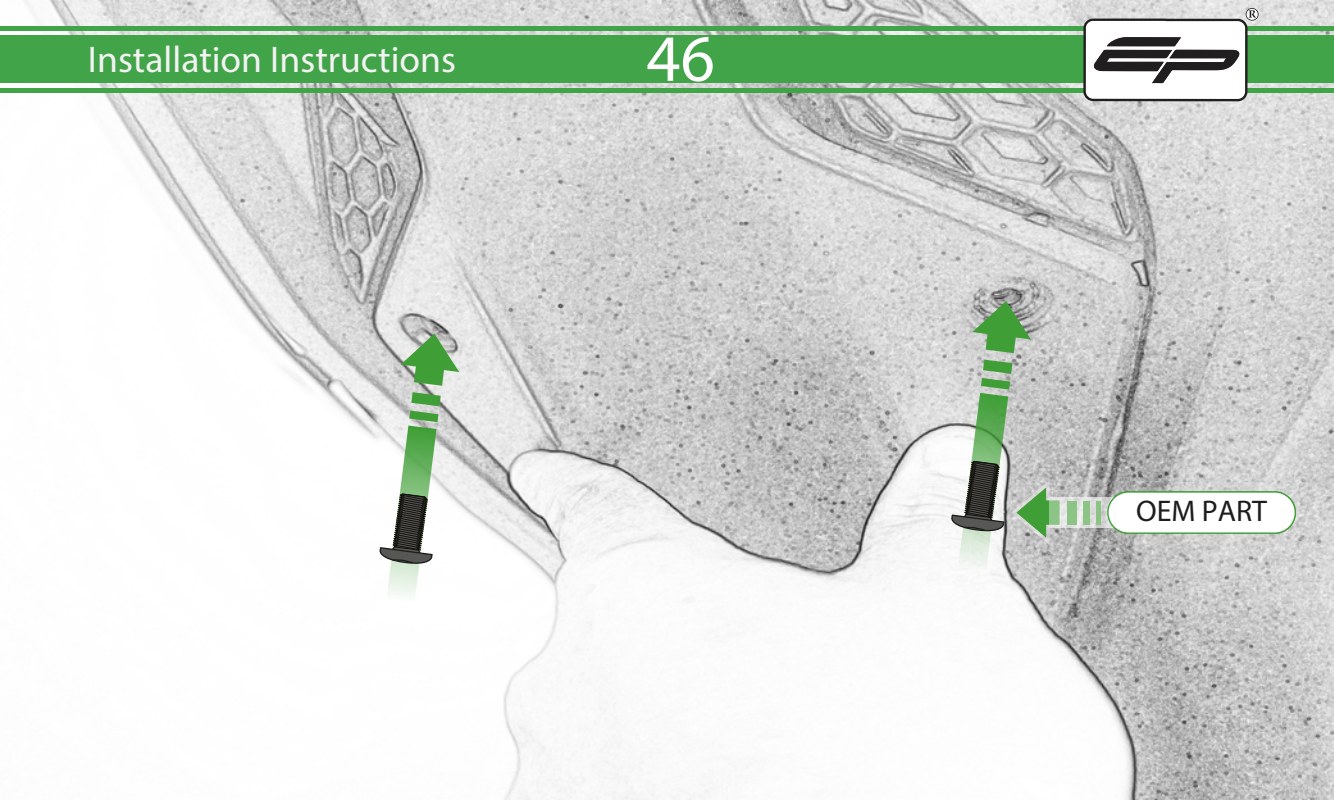

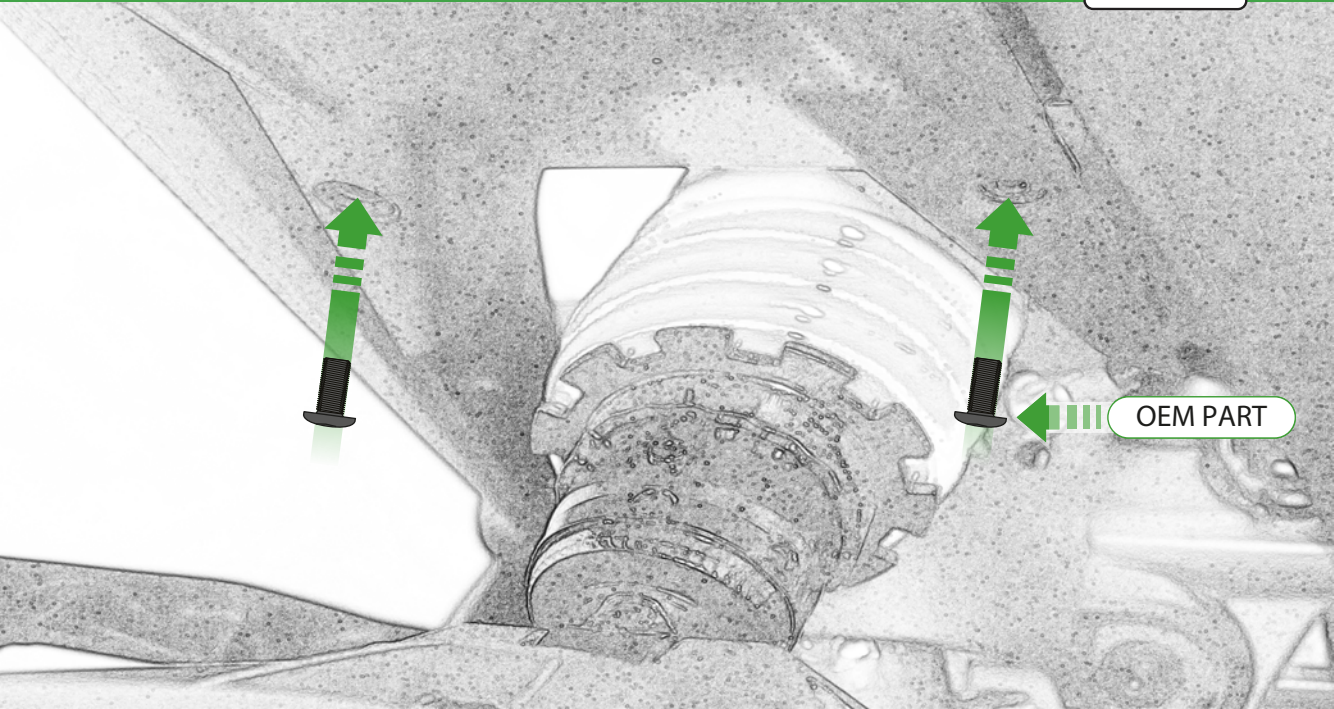

OEM PART

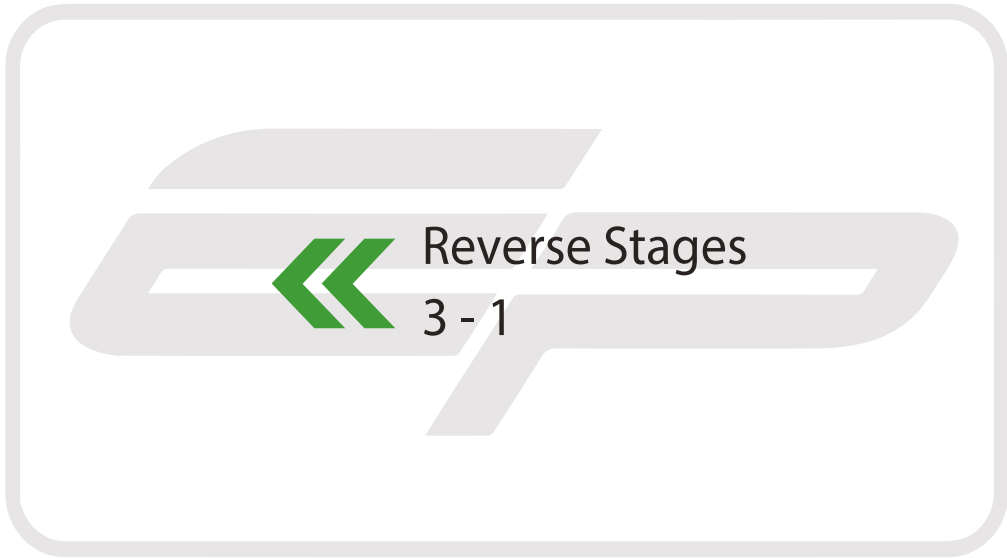



## ESSENTIAL CHECKS

After installation of your tail tidy ensure that the licence plate does not contact the rear tyre when suspension is fully compressed.

Ensure all electrics including indicators, tail light, brake light and licence plate light lights are working correctly before riding the motorcycle.

It is recommended that periodic inspections are made to ensure that all fixings are fully tightend.



# Installation Instructions

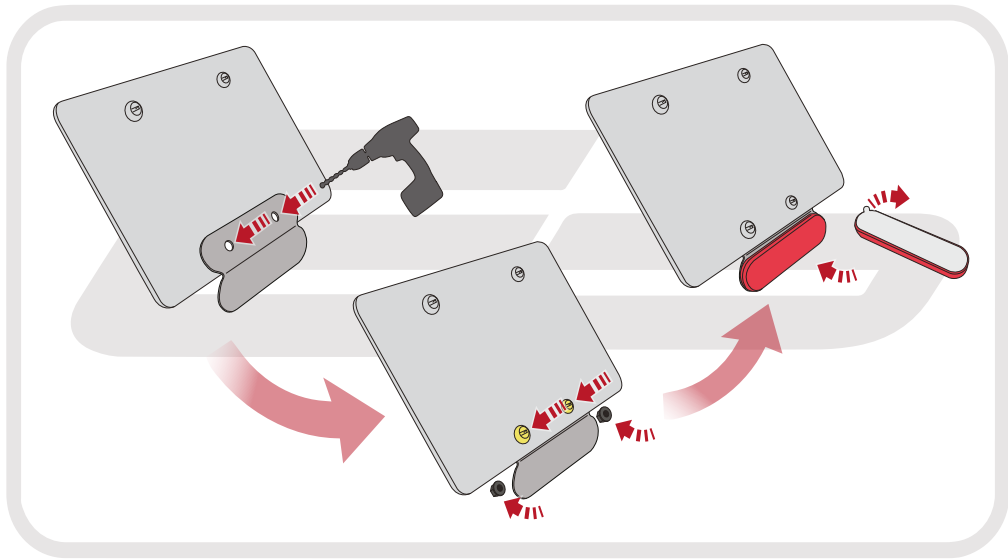

**EVOTECH**<sup>®</sup>  
P E R F O R M A N C E

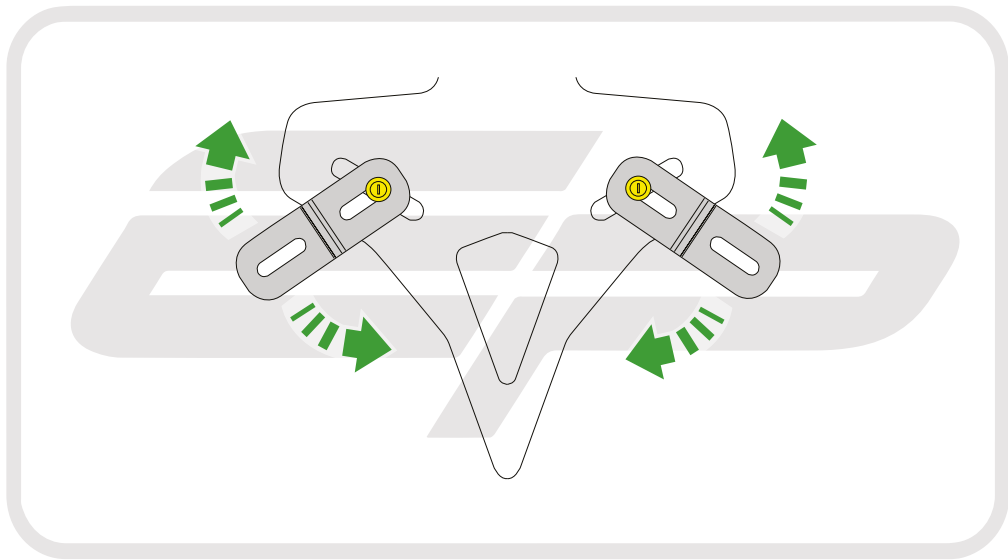



**EVOTECH**®  
P E R F O R M A N C E

[www.evotech-performance.com](http://www.evotech-performance.com)