

MeetingEye 500

MeetingEye 500

Separate design, Android codec for Large to Ex-Large rooms

As the new generation [video conferencing system](#), Yealink MeetingEye 500 is suitable for various types of meeting rooms. It supports 4Kp30 UHD video and content sharing. You can present different 4K video and content on three screens and select the display layout as you like. *MeetingEye 500 can work with the Yealink 36x hybrid zoom 4K UHD PTZ camera or third-party cameras, regarding as the ideal solution for small and medium meeting rooms. When MeetingEye 500 combines with the microphone array, each microphone can reach 10ft (3m) and 360° voice pickup range. Also, MeetingEye 500 can work with Yealink's new soundbar, providing a professional sound experience. Its VCH interface is able to convey not only the data and control signal but also the power needed for MeetingEye 500, realizing the minimalist deployment and reducing cost. Furthermore, it allows multiple content sharing methods, adapts to any computer.



Key Features and Benefits

Smart Experience

MeetingEye 500 works with AI cameras to achieve AI technologies, including Auto Framing and Speaker Tracking, allowing users to experience smarter and safer video conferences.

* Three Screens, Efficient Meeting

Yealink MeetingEye 500 provides three HDMI outputs supporting high-definition display without the tedious switching of pictures and devices. Three displays can present different views and content information, realizing efficient communication.

Separate Design, Minimalist Deployment

Adopts a separate design, Yealink MeetingEye 500 allows installation and deployment such as hanging wall, putting on/hanging under the desk, or mounting in a rack. Its VCH interface is able to convey not only the data and control signal but also the power needed for MeetingEye 500, realizing the minimalist deployment and reducing cost.

Compatible with Third-party Pro audio

UVC86 is compatible with third-party pro audio to support for more microphone setting. This allows users to enjoy different microphone device experiences in meetings.

USB Mode, Act as PC Audio & Video Peripherals

Yealink MeetingEye 500 can cover multiple scenarios in conference rooms by working with Yealink cameras and audio devices. It can work with VCH51 and act as the PC audio and video peripherals via a USB Type-C cable to provide an excellent audio and video experience.

**** The current version supports dual-screen display, and triple-screen display will be supported in the next version.**

Specification

Parameter	Description
Chips and Systems	<ul style="list-style-type: none"> · CPU: 4-core 2.6G + 4-core 2G · AI Computing Power: 4T · Operating System: Android 11
Camera	<ul style="list-style-type: none"> · Camera: Optional UVC84/UVC86 (supports up to 3) · Third-party cameras: support
Audio Device	<ul style="list-style-type: none"> · Microphone: Optional VCM35/VCM38 or third-party devices · Speaker: Optional MSpeaker II or third-party devices
Accessories	<ul style="list-style-type: none"> · Content Sharing Device: Optional WPP30 Wireless Presentation Pod/VCH51 Video Conferencing Hub(including BYOD) · Bracket: Wall mounting bracket/Rack mounting bracket
Controller	Touch Panel: CTP18 Touch Panel
Content Sharing	<ul style="list-style-type: none"> · VCH51 Video Conferencing Hub (Optional) - Support HDMI / USB-C input - Support up to 4Kp30 or 1080p60 - 1 x USB 2.0 for WPP30 pairing · Yealink Wireless Presentation Pod WPP30 (Optional) - Support up to 4Kp30 · Content sharing via HDMI in
Standard Communication Protocol	<ul style="list-style-type: none"> · H.323/SIP · Dual stream protocol: H.239 (H.323) / BFCP (SIP) · FECC: H.224/H.281, Sony VISCA, PELCO D/P · H.323 protocol suit: H.245, H.225, H.235, H.241 · Gatekeeper account and SIP account
NAT and Firewall Traversal	<ul style="list-style-type: none"> · ICE/TURN/STUN · H.460 · NAT (manual/auto mode) · Yealink intelligent firewall traversal







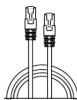
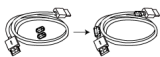

Network and Security Features	<ul style="list-style-type: none"> · Wi-Fi: 2.4GHz/5GHz bimodule · Bluetooth: 5.0 · TCP/IP: IPv4&IPv6 · Communication Protocol: H.323/SIP · NAT traversal: - HTTPS Web Page Secure Access - Support API interface signaling, TCP/IP and RS232 dual connection mode - SRTP/TLS/AES encryption -QoS: 802.1p/Q, Diffserv -IEEE 802.1X, LLDP-MED, VLAN - Anti network and protocol attacks - SNTP Automatically synchronizes date and time - Built-in security encryption certificate · Encryption function: SRTP/TLS/H.235/AES 256-bit
Physical	<ul style="list-style-type: none"> · Display port: 3 x HDMI out port, supports up to 4K30 (The current version supports dual-screen display, and triple-screen display will be supported in the next version.) · VCH Port: 1 x VCH/LAN (can be configured as ordinary VCH port or internet port), 2 x Audio port (The Audio port also allows connecting non-audio devices such as cameras. However, it is recommended to connect audio devices to the Audio port for better performance.) · Content Input Port: 1 x HDMI in Port, supports up to 4K30 · USB Port: 3 x USB-A 3.0 to connect UVC30 · Network Port: 1 x 10/100/1000Mbps network port (if VCH switches to Internet port, 2 network interfaces are supported) · 3.5 mm line-out: 1 · 3.5 mm line-in: 1 · Power Port: DC 48V · Wall mounting bracket: Standard · Rack mounting bracket: Standard
Video Codecs	H.264 High profile, H.264 SVC, H.264
Audio Features	<ul style="list-style-type: none"> · Audio Technology - Yealink Noise Proof Technology - Multi-channel acoustic echo cancellation - Multi-channel dereverberation - Automatic gain control

Other Physical Features	<ul style="list-style-type: none">· External Yealink Power Adapter: AC 100~240V input and DC 48V/2A Output· USB Output: 5V === 0.5A· Power consumption (PSU):<ul style="list-style-type: none">- Idle<14W- Normal operating: 14W- MAX: 39W· Dimension (W.D.H):<ul style="list-style-type: none">-MeetingEye 500: 315mm x 170mm x 32mm-VCR11 remote control: 190mm x 55mm x 24mm· Operating humidity: 10~95%· Operating temperature: 0~40°C· Storage temperature: -30~70°C
Package Features	<ul style="list-style-type: none">· N.W/CTN: 10.5kg· G.W/CTN: 11.2kg· Giftbox size: 455mm x 400mm x 255mm

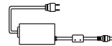
[Click here](#) to go to the product introduction on the Yealink official website.

MeetingEye 500

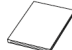
Package Contents

 MeetingEye 500 Codec MeetingEye 500 Codec Código MeetingEye 500 Codec MeetingEye 500	 (3.0m, 9.84ft) Ethernet Cable Ethernet-Kabel Cable Ethernet Câble Ethernet	 (1.8m, 5.91ft) HDMI Cablex2 HDMI-Kabelx2 Cable HDMIx2 Câble HDMIx2	 Velcrox2 Klettverschlussx2 Velcrox2 Velcrox2	 Power Adapter (48V/2A) Netzteil (48V/2A) Adaptador de corriente (48V/2A) Adaptateur secteur (48V/2A)
 Screw (8) , Mounting ears (2) Schraube (8) , Montagebügel (2) Tornillo (8) , Montaje de soporte (2) Vis (8) , Oreilles de fixation (2)	 Bracket Halterung Soporte Support	 Expansion Screw and Machine Screw Erweiterungsschrauben und selbstschneidende Schrauben Tornillos de expansión y tornillos autorroscantes Vis d'expansion et vis autotaraudeuses	 Quick Start Guide Kurzanleitung Guía de inicio rápido Guide de démarrage rapide	
 VCR11 Remote Control VCR11 Fernbedienung Mando a distancia VCR11 Télécommande VCR11		 Cable Tiex 5 Kabelbinderx5 Sujetacablesx5 Serre-câbles x5		

Optional Accessories

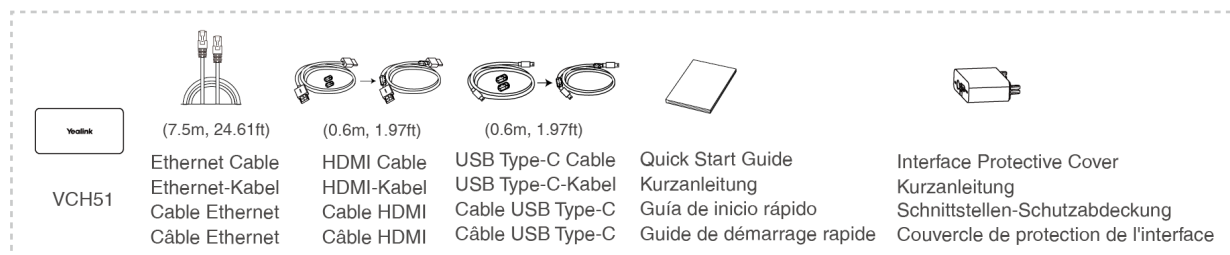

VCH51 Wired Sharing Package

VCH51 Wired Sharing-Paket - Paquete de uso compartido por cable - VCH51 - Package de partage filaire VCH51

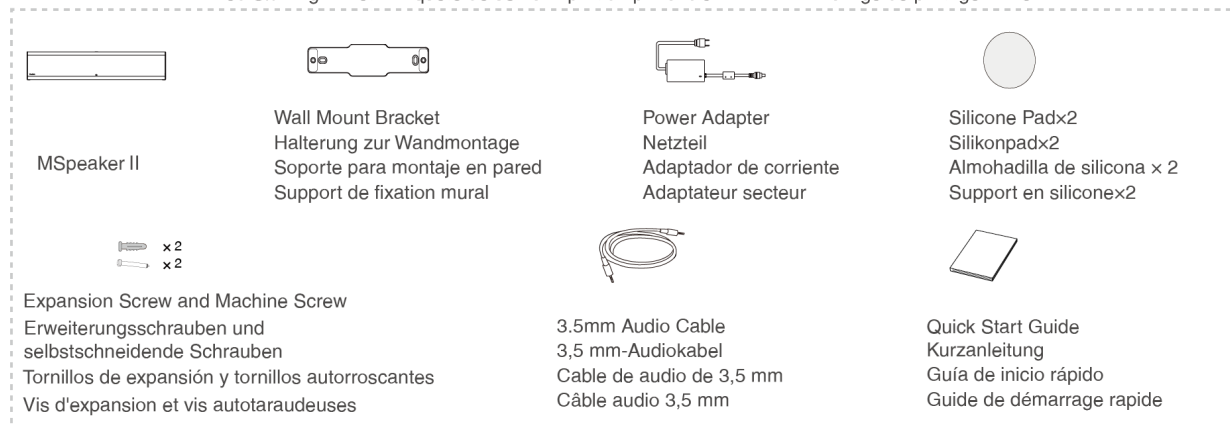

MSpeaker II Package (Soundbar)

MSpeaker II-Lieferumfang(Soundbar) - Paquete MSpeaker II (Barra de sonido) - Emballage MSpeaker II (Barre de son)

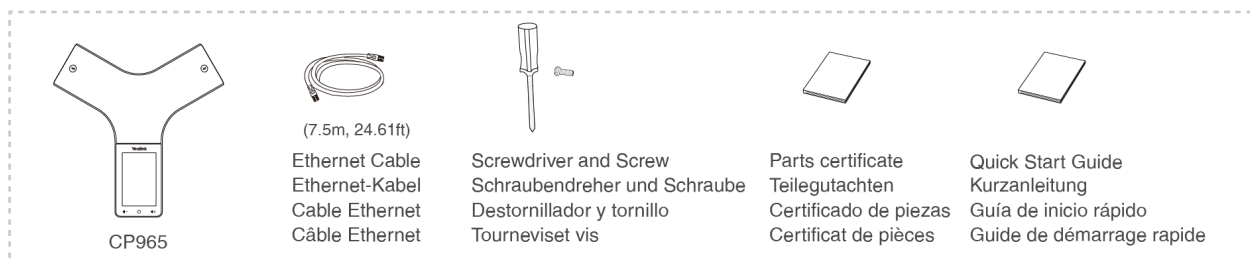

CP965 Package (Conference Phone)

CP965(DE) - CP965 (ES) - CP965 (FR)



CPE95 Package (Microphone)

CPE95-Lieferumfang(Mikrofon)-Paquete CPE95 (micrófono)-Emballage CPE95 (Microphone)

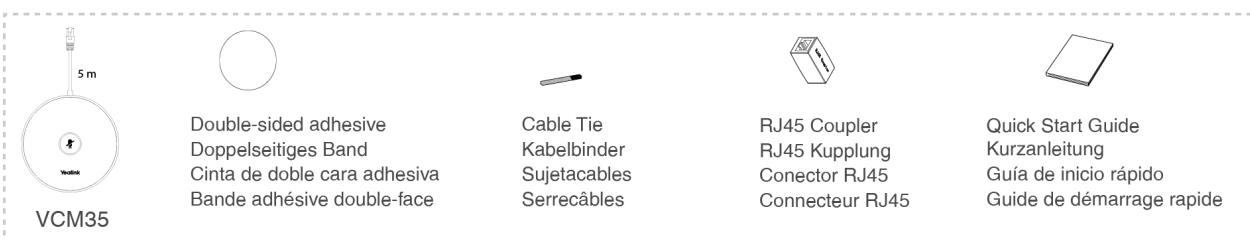

VCM35 Package (Microphone)

VCM35-Lieferumfang(Mikrofon)-Paquete VCM35 (micrófono)-Emballage VCM35 (Microphone)



UVC30-Room Package (Camera)

UVC30-Room-Lieferumfang(Kamera) - Paquete UVC30-Room (cámara) - Emballage UVC30-Room (caméra)

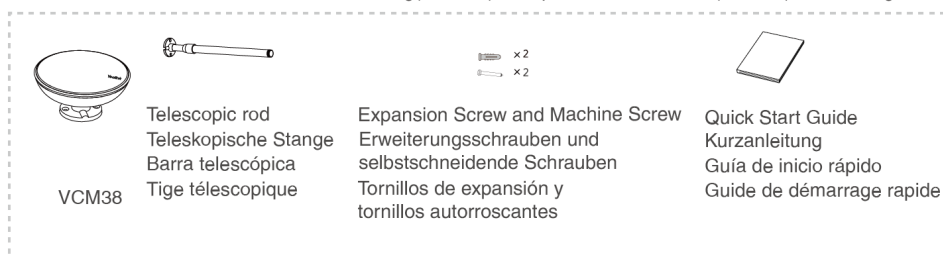

VCM38 Package (Microphone)

VCM38-Lieferumfang(Mikrofon)
Paquete VCM38 (micrófono)
Emballage VCM38 (Microphone)

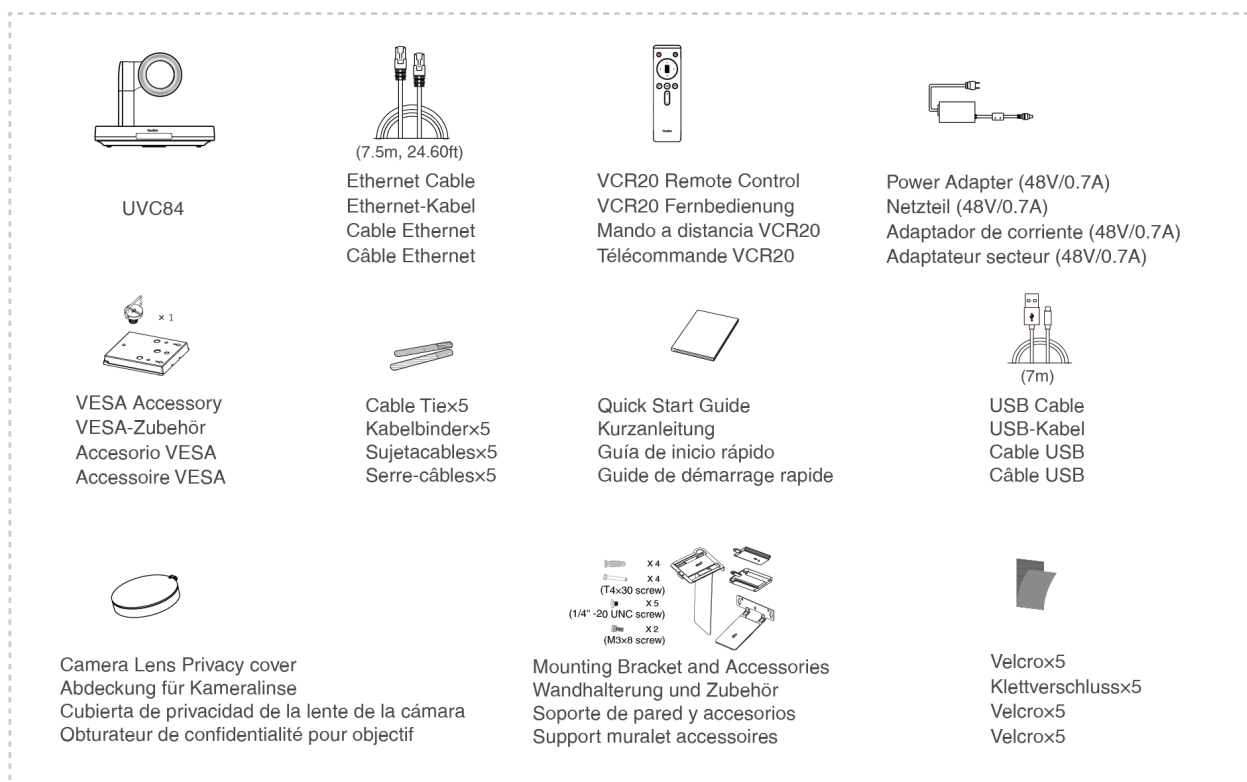

UVC84 Package (Camera)

UVC84-Lieferumfang(Kamera) - Paquete UVC84 (cámara) - Emballage UVC84 (caméra)

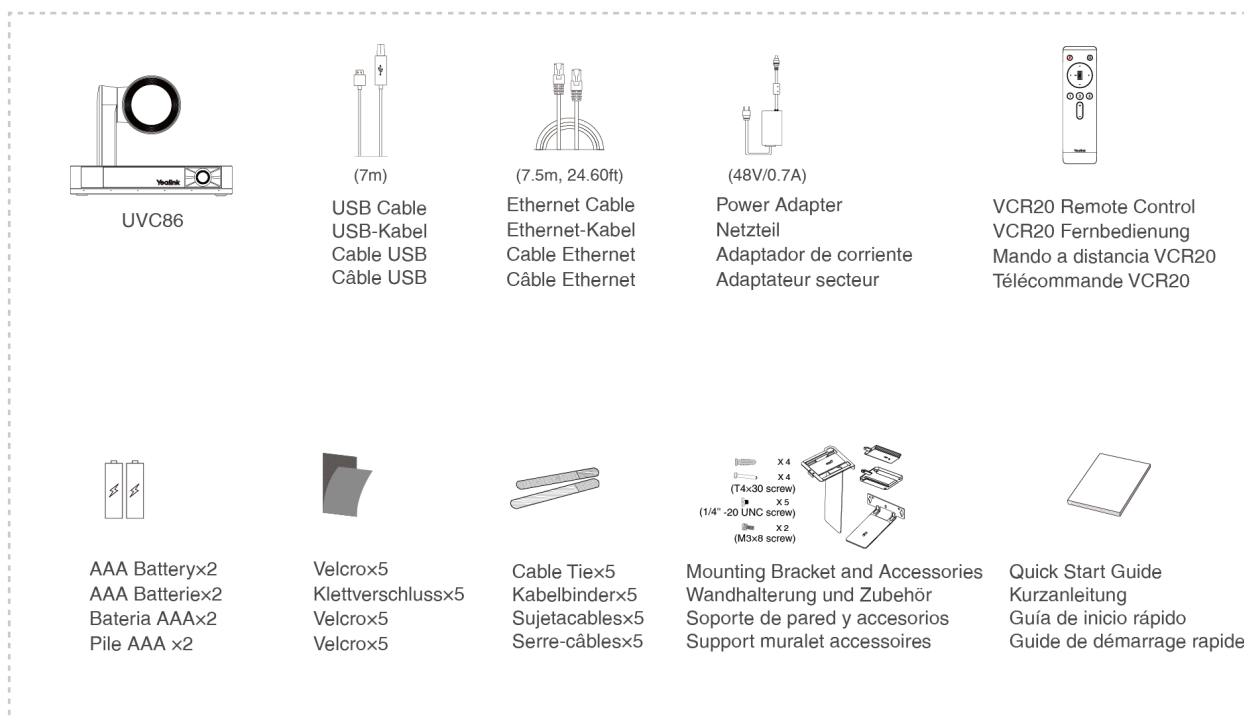

UVC86 Package (Camera)

UVC86-Lieferumfang(Kamera) - Paquete UVC86 (cámara) - Emballage UVC86 (caméra)

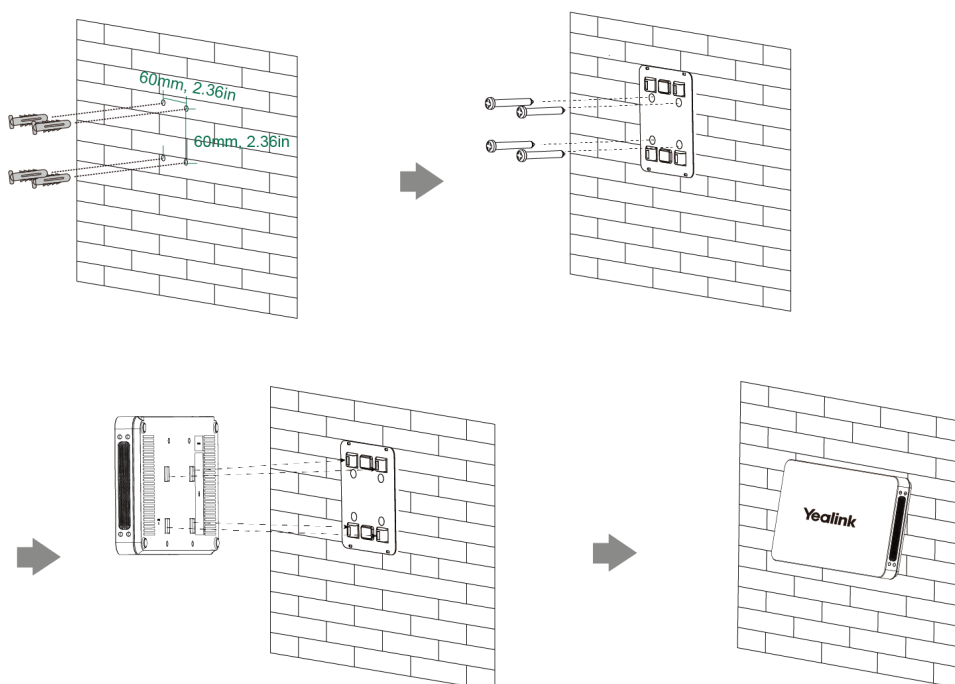

Installation

Mount on the Wall

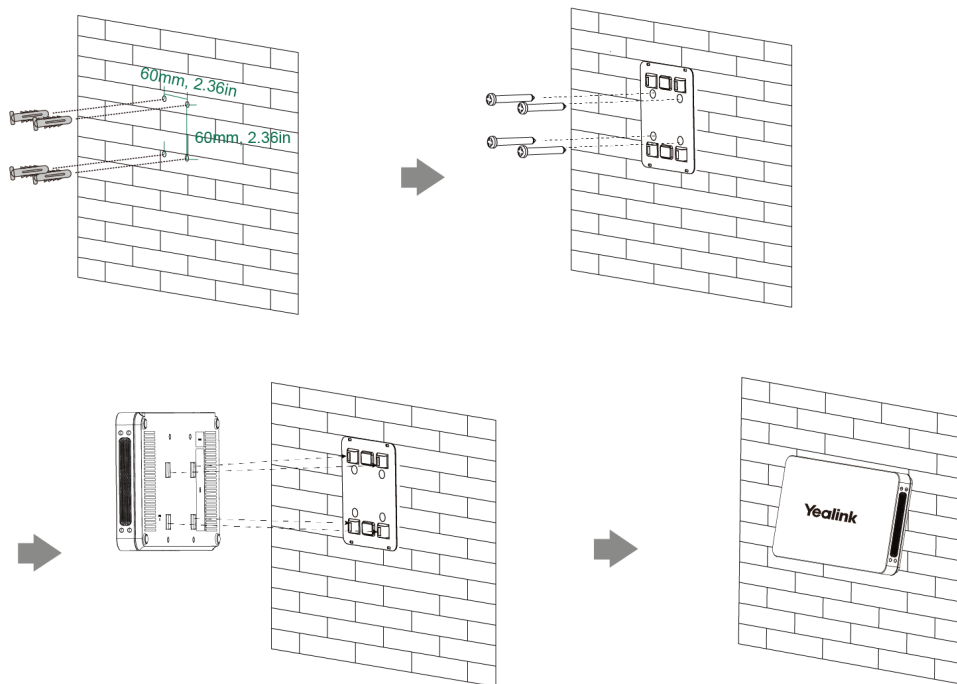

Stick to the Table

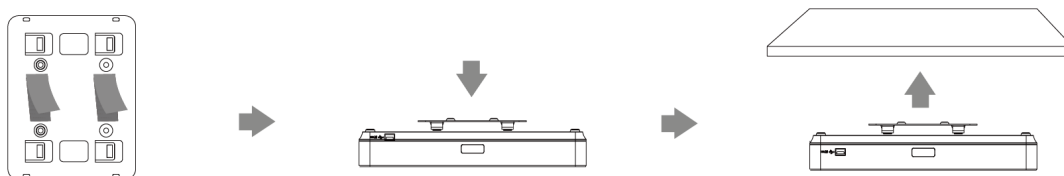

Put on the Desk

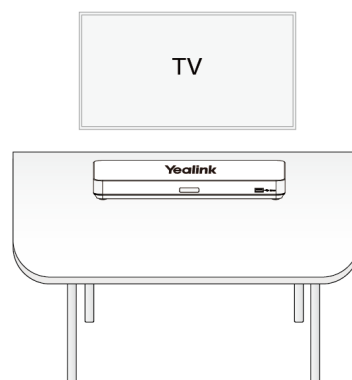

Mount in a Rack

i NOTE

The rack in which the MeetingEye 500 will be placed must be a 19-inch Rack compliant with IEC 60297.

1. Install the mounting ears to the sides of the MeetingEye 500.

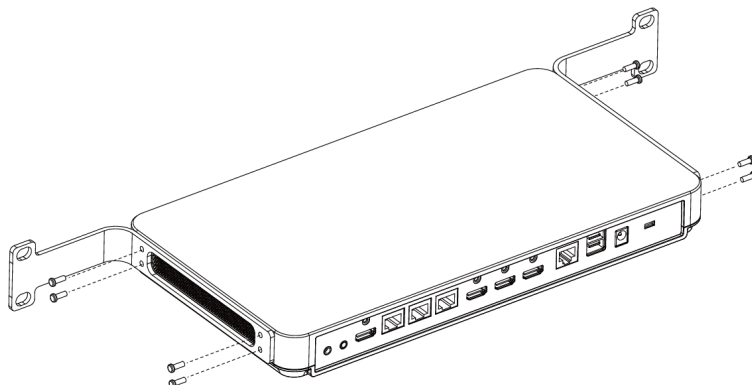

2. Push the MeetingEye 500 into the rack, and then fix it to the rack with screws.

i NOTE

Package Contents do not include screws.

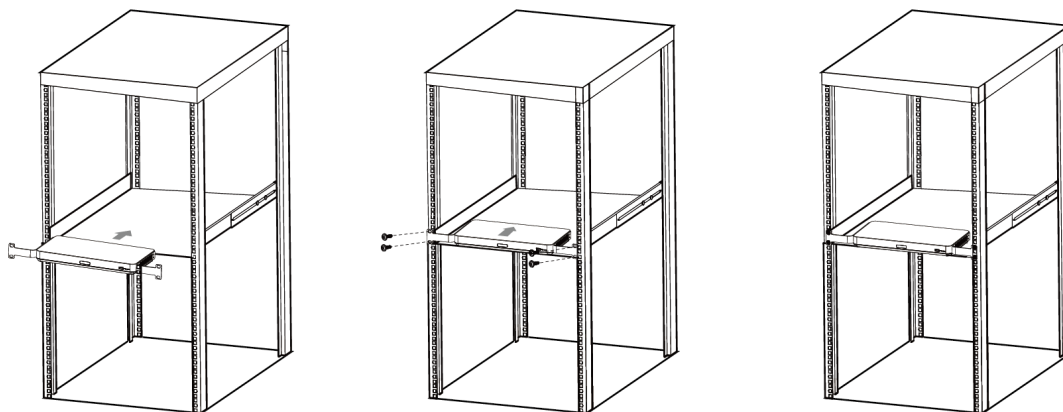

Connections

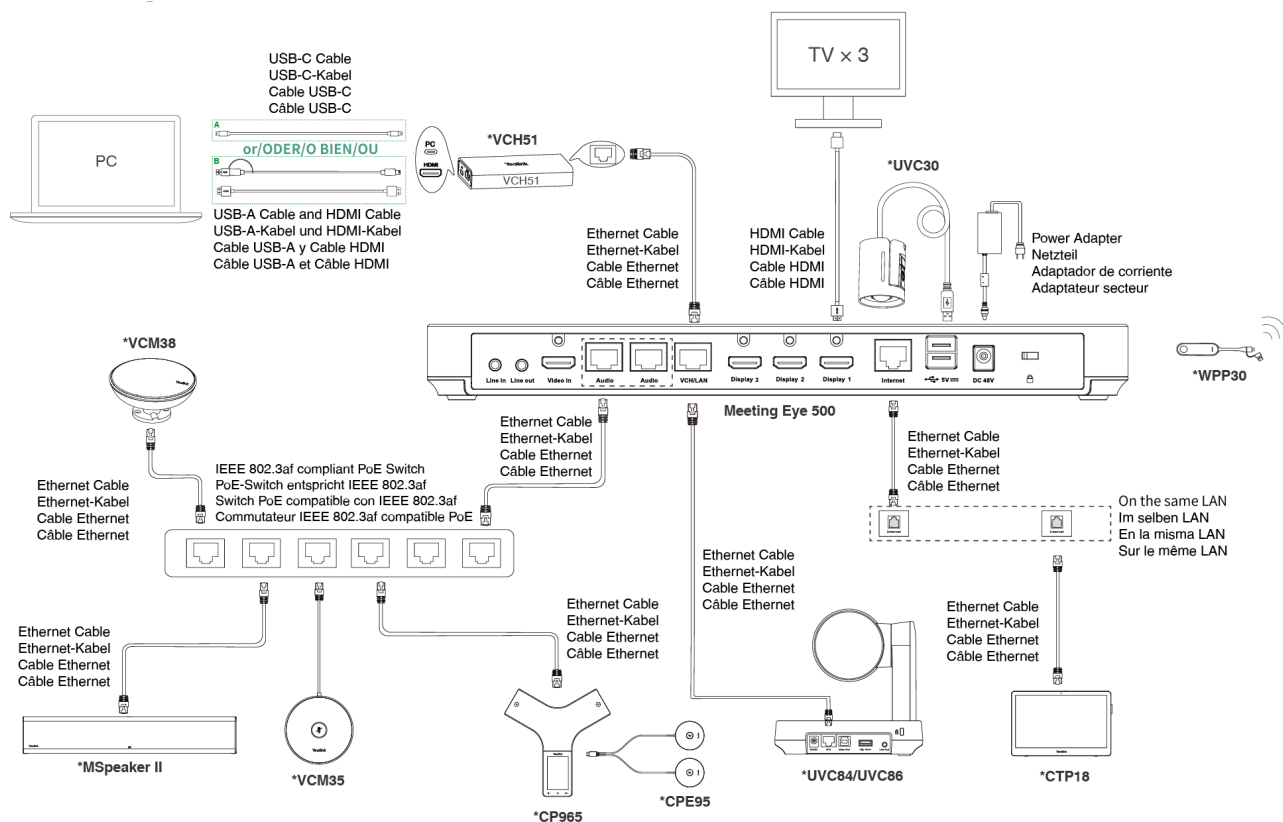

NOTE

- The current version supports dual-screen display, and triple-screen display will be supported in the next version.
- The Audio port also allows connecting non-audio devices such as cameras. However, it is recommended to connect audio devices to the Audio port for better performance.

Supported Accessories

For the compatible devices and the maximum number of compatible devices, please refer to [Zoom Rooms Accessories Compatibility Lists](#).